

Read this instruction carefully. See hardware and furniture part list for guidance. Be sure all parts are complete, before you assemble. Place all wooden furniture parts on a clean and flat soft surface to prevent from being scratched. Follow the figure to start assembling.

**CAUTIONS :**

1. Do not FULLY - TIGHTEN the nut or nut bolt until all nut or bolt is ready assembled.
2. Do not OVER - TIGHTEN the nut or bolt to avoid causing damages to the thread.
3. Keep all hardware parts out of reach of children.

NOTE : THE LIST AND QUANTITY SHOWN ARE FOR 1 UNIT ASSEMBLY.

Tool needed : Screwdriver (not provided).

PART LIST		
ITEM	DESCRIPTION	QTY
A	CUSHION	1 PC
B	LEG	2 PCS
C	SUPPORT RAIL	2 PCS

HARDWARE LIST			
ITEM	DESCRIPTION		QTY
1	JCBB BOLT M8 x 50mm		4pcs
2	M8 SPRING WASHER		4pcs
3	WOOD SCREW M4 x 32mm		4pcs
4	WOOD DOWEL M8 x 35mm		8pcs
5	M5 ALLEN KEY (BALL SHAPE)		1pc

## STEP 1

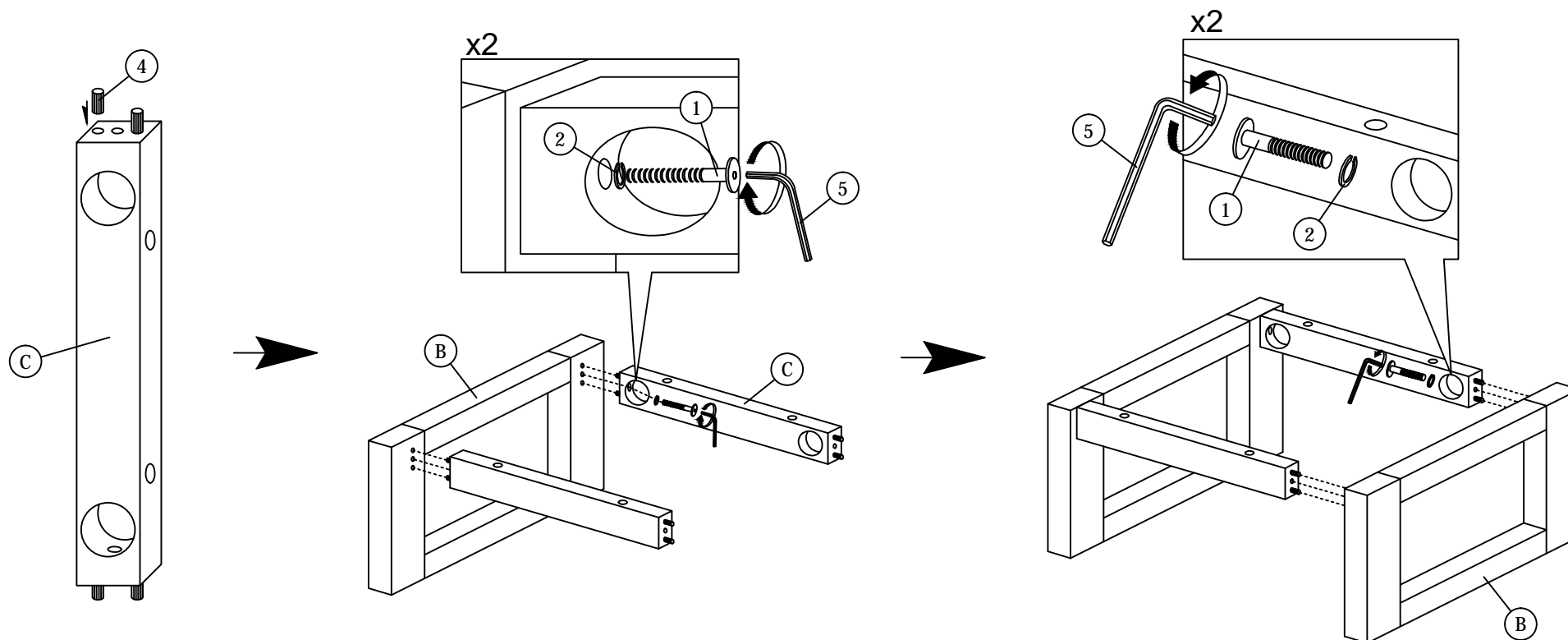

# ASSEMBLY INSTRUCTIONS

2 of 2

## STEP 2

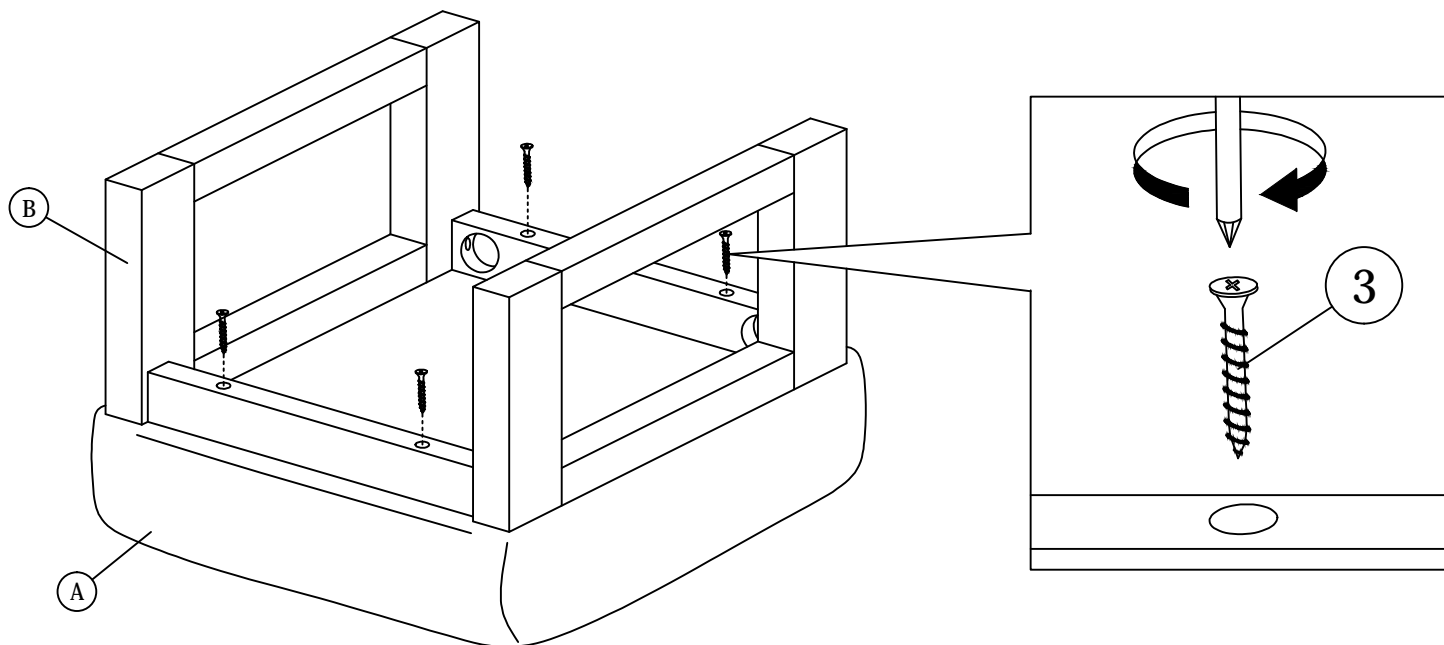

## STEP 3

