

Industrial Hutch for Desk

ASSEMBLY INSTRUCTIONS

In the event of missing or damaged parts, please contact us

Carefully open your carton and lay all of the parts on a flat surface

Verify all parts are included.

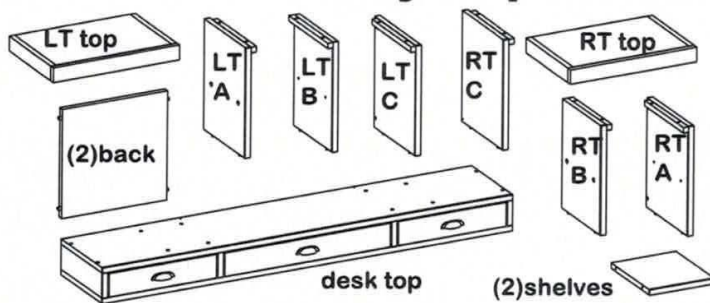

	(1) Allen key wrenches
	(12) hex head bolts
	(8) bolt and barrel nut
	(2) bracket
	(4) screws

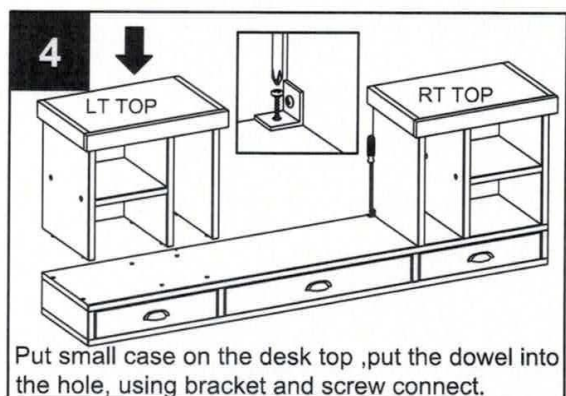
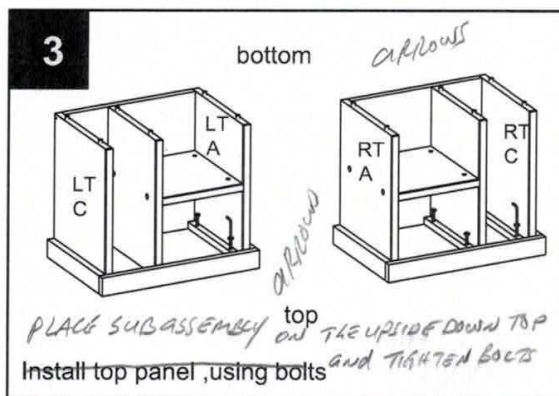
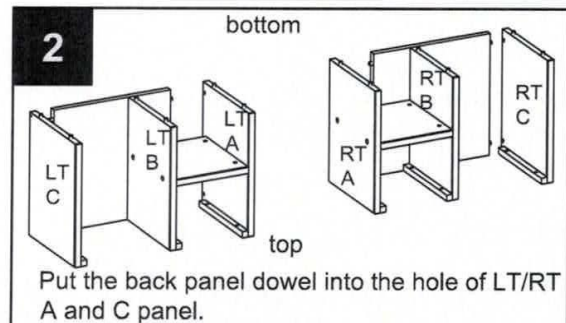
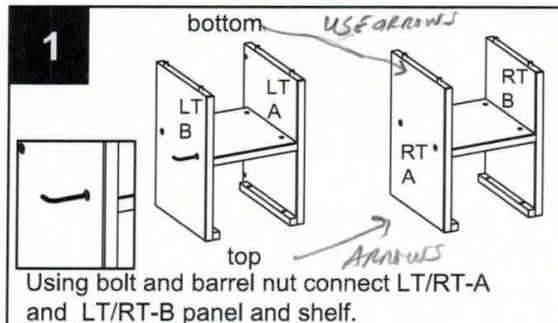

Assembly is now completed !
enjoy you new furniture

this drawing not in AI
only for factory mark on panel

