

CATALOG NUMBER

TYPE

PROJECT

LARC SPOT – LOW VOLTAGE TRACK HEAD

SERIES 311L

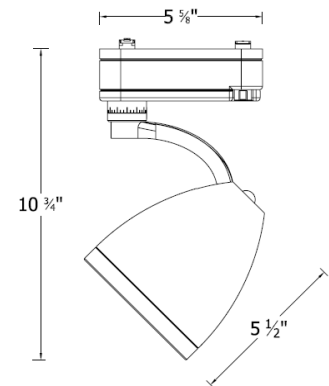
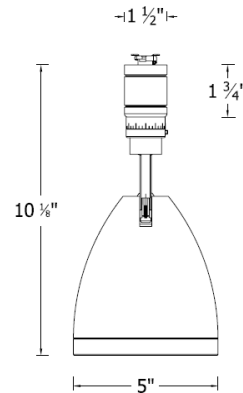

Ordering Matrix

Model	Finish
<input type="text"/>	<input type="text"/>
JHT-311L	BK = Black WT = White PT = Platinum

Ordering Example (*model – finish*): JHT-311L-BK

Product Details

Description:	Low voltage track head using AR111 lamps. Designed for use with WAC and W2 J & J2 series track. Adaptable to other manufacturer's track. (consult factory for specific brands).
Materials:	Die-cast aluminum fixture, cap ring and check ring. Clear 1/8 inch tempered glass lens included.
Transformer:	Electronic transformer with auto reset, soft start, and short circuit protection.
Socket:	Wire screw terminals.
Aiming:	350° horizontal rotation and 90° vertical aiming with indexing scales. Spring loaded buttons lock to secure the aiming adjustment on horizontal and vertical axis.
Lamping:	Re-lamps from the front using 12V AR111 lamps, 75W maximum. Lamp not included.
Finish:	Powder coat paint finish. Available in Black (BK), White (WT), Platinum (PT).
Listing:	UL & CUL Listed. Patent Pending.

Specification Features

- Die-cast aluminum fixture with integral indexing scales to assure precise directional adjustment.
- Threaded check ring within lens cap allows 2 captive accessories to be held securely.
- Electronic transformer soft start feature is designed to prolong lamp life.
- The 311L track head utilizes the second circuit on the J2 style track with the use of the JCLIP.
- Accommodates up to 2 lenses and one accessory.
- 5 year product warranty.

Track Adaptor Information

Standard Adaptor
For J style
W2 & WAC track



J2 Adaptor
For J2 style
W2 & WAC track



JCLIP
Ordered when using track
heads on 2nd circuit of J2



Compatible Accessories

LENS-111-DIC-COLOR
Dichroic Lenses

LENS-111-COLOR
Color Lenses

AMB = Amber ; BLU = Blue ; GRN = Green
RED = Red ; YEL = Yellow



LENS-111-HCL
Honeycomb Louver



LENS-111-CRL
Cross Louver



HOOD-111-BK
Light Deflecting Hood
for wall wash application

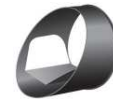

LENS-111-UVF
UV Filter

LENS-111-FR
Frosted Lens

LENS-111-SPR
Spread Lens

LENS111-BEL
Beam Elongating Lens

Photometry

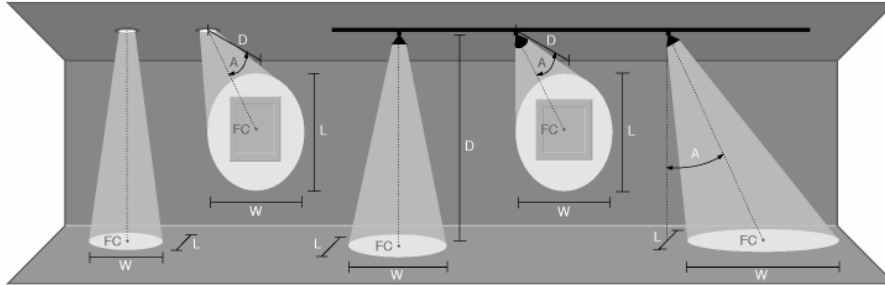

D Distance To Fixture From Wall Or Floor
FC Initial Footcandle Level At Center Of Beam
L Beam Length (where candlepower drops to 50% of maximum)
W Beam Width (where candlepower drops to 50% of maximum)

50W AR111 (8 DEG)				
0° Aiming Angle				
D(ft)	FC	W	L	
6	641	0.8	0.8	
9	285	1.3	1.3	
12	160	1.7	1.7	
15	103	2.1	2.1	
45° Aiming Angle				
D(ft)	FC	W	L	
6	227	1.7	1.2	
9	101	2.5	1.8	
12	57	3.4	2.4	
15	36	4.2	3.0	

75W AR111 (8 DEG)				
0° Aiming Angle				
D(ft)	FC	W	L	
6	833	0.8	0.8	
9	370	1.3	1.3	
12	208	1.7	1.7	
15	133	2.1	2.1	
45° Aiming Angle				
D(ft)	FC	W	L	
6	295	1.7	1.2	
9	131	2.5	1.8	
12	74	3.4	2.4	
15	47	4.2	3.0	

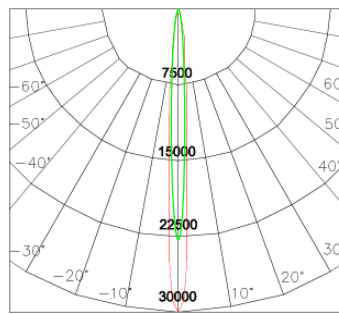

50W CBCP 23091
75W CBCP 30000

50W AR111 (24 DEG)				
0° Aiming Angle				
D(ft)	FC	W	L	
6	111	2.6	2.6	
9	49	3.8	3.8	
12	28	5.1	5.1	
15	18	6.4	6.4	
45° Aiming Angle				
D(ft)	FC	W	L	
6	39	5.3	3.6	
9	17	8.0	5.4	
12	10	10.7	7.2	
15	6	13.4	9.0	

75W AR111 (24 DEG)				
0° Aiming Angle				
D(ft)	FC	W	L	
6	147	2.6	2.6	
9	65	3.8	3.8	
12	37	5.1	5.1	
15	24	6.4	6.4	
45° Aiming Angle				
D(ft)	FC	W	L	
6	52	5.3	3.6	
9	23	8.0	5.4	
12	13	10.7	7.2	
15	8	13.4	9.0	

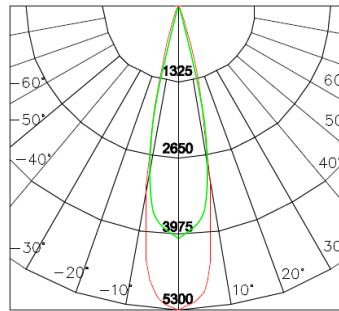

50W CBCP 4000
75W CBCP 5300

75W AR111 (45 DEG)				
0° Aiming Angle				
D(ft)	FC	W	L	
6	53	5.0	5.0	
9	23	7.5	7.5	
12	13	9.9	9.9	
15	8	12.4	12.4	
45° Aiming Angle				
D(ft)	FC	W	L	
6	19	12.0	7.0	
9	8	18.0	10.5	
12	5	24.0	14.1	
15	3	30.0	17.6	

