

CONSOLE TABLE

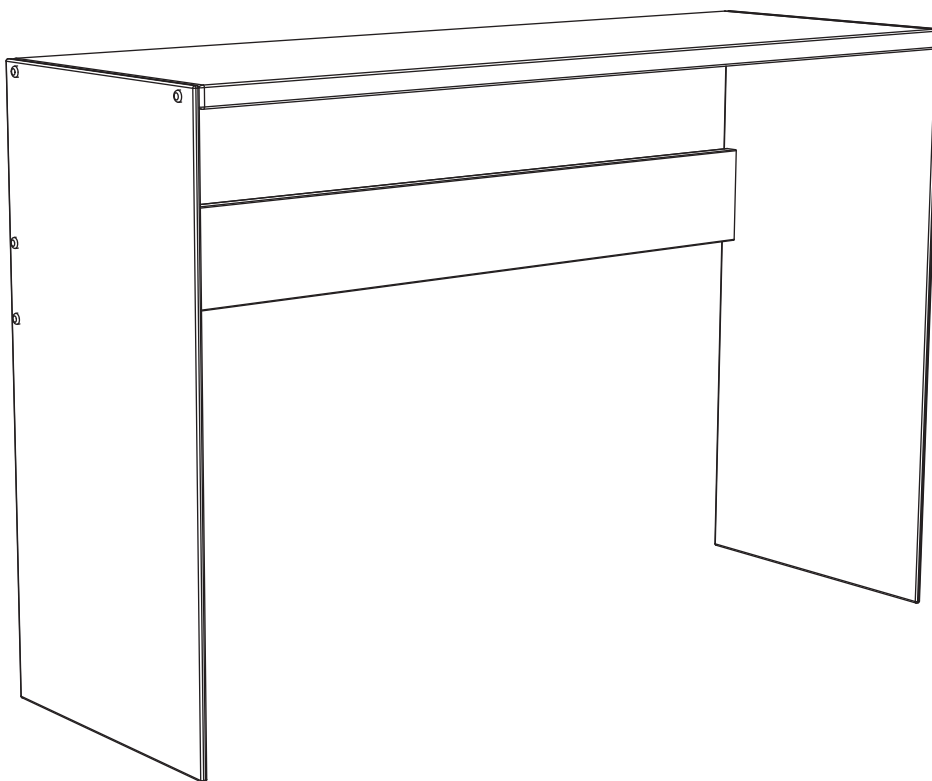

ASSEMBLY INSTRUCTIONS

We have designed our furniture with you , the customer in mind . Our clear , easy to follow , step by step instructions will guide you through the project from start to finish . Feel confident that this will be a fun and rewarding project . The final product will be a quality piece of furniture that will go together smoothly and give years of enjoyment .



Please do not return to the store

Hardware List

A

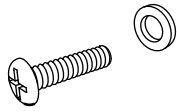

(8pcs)

Screw and washer

B



(8pcs)

locking nut

C



(1pcs)

Bracket

D



(1pcs)

Cable tie

E



(1pcs)

Eyelet screw

F



(1pcs)

Anchor

G



(1pcs)

Small Screw

Panel List

①

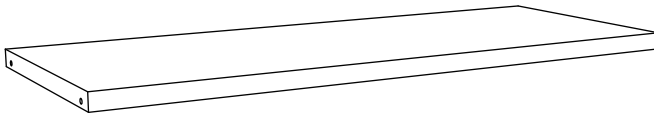

Top panel (1PC)

②

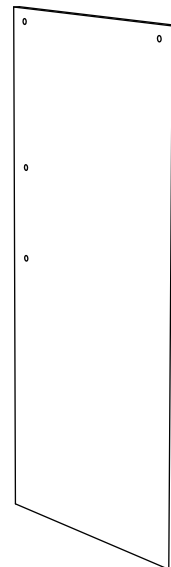

Side panel (2PCS)

③

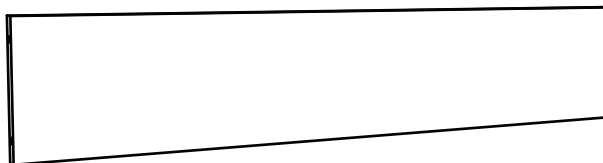

Back panel (1PC)

Step 1

*Assemble unit on soft surface.

1. Insert locking nuts **B** into top panel **①**.
2. Connect the side panels **②** to top panel using screws and washers **A**.

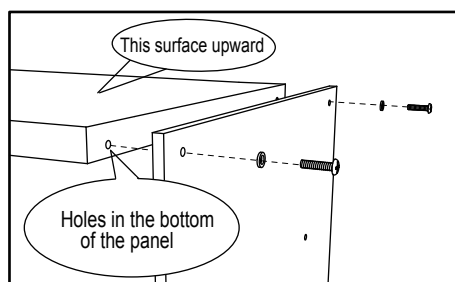
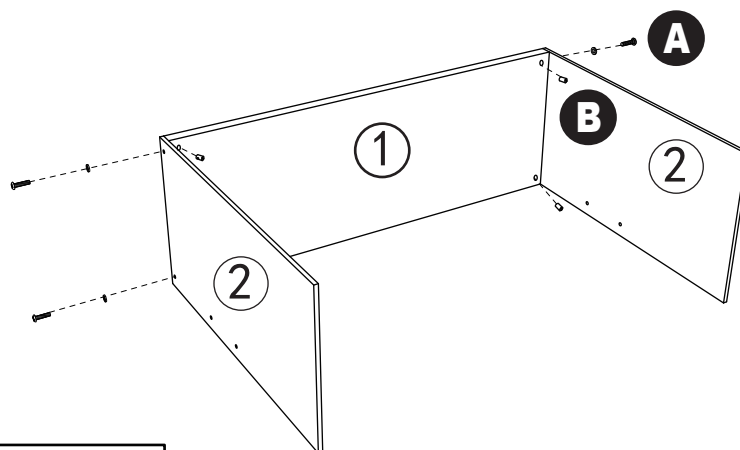
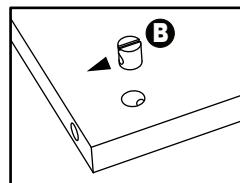

*Note.
Make sure threads of lock nuts face bolt holes.

Step 2

1. Insert locking nuts **B** into back panel **③**.
2. Connect back panel **③** to unit as shown using screws and washers (A).
3. Enjoy!

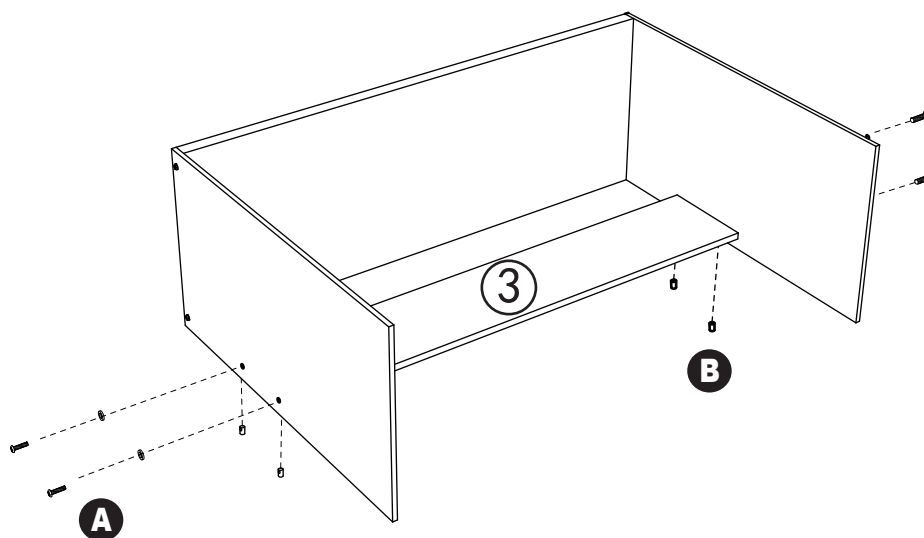
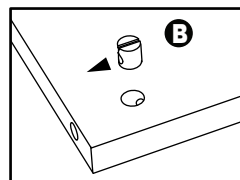

Step 3

1. Connect bracket (C) to unit as shown using short screws (G) .
2. Drill hole slightly smaller than plastic anchor (F) into drywall and gently tap plastic anchor into hole.
3. Insert eyelet screw (E) into plastic anchor (F) and fasten unit to wall using cable tie(D).

