

# I-Door Medicine Cabinet Mirror 16"

## MISC CABINETS

Espresso

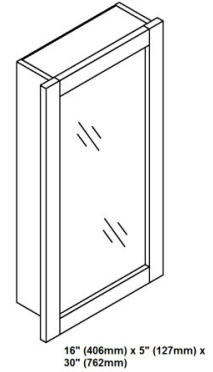
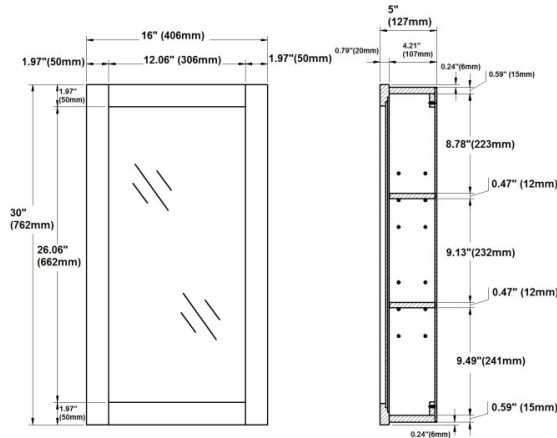

## SPECIFICATIONS

MATERIAL CONSTRUCTION:	Wood	FACE FRAME MATERIAL:	Pine
ASSEMBLY REQUIRED:	No	SIDES MATERIAL:	Particle Board
TOOLS NEEDED FOR INSTALLATION:	Electric Drill, Screwdriver	BOTTOM MATERIAL:	Particle Board
ASSEMBLED DIMENSIONS:	30" H x 16" L x 5" D	BACK PANEL MATERIAL:	MDF
WEIGHT:	19.36 lbs.	BACK BRACE MATERIAL:	Particle Board
NUMBER OF DOORS:	1	GLASS STYLE:	Flat Panel
DOOR MATERIAL:	Mirror	LIGHTED:	No
NUMBER OF SHELVES:	2	QTY OF LAMPS:	N/A
ADJUSTABLE SHELVES:	Yes	POWER SOURCE:	None
SHELF MAX WEIGHT CAPACITY:	20 lbs.	MOUNTING HARDWARE INCLUDED:	No
SHELF WIDTH:	13.15"	MOUTING TYPE:	Surface
SHELF THICKNESS:	0.47"		
SHELF MATERIAL:	Particle Board		

WARRANTY: 1-Year limited warranty  
CARB COMPLIANT: CARB Phase 2  
TSCA TITLE IV COMPLIANT: Yes

