

# Assembly Instructions

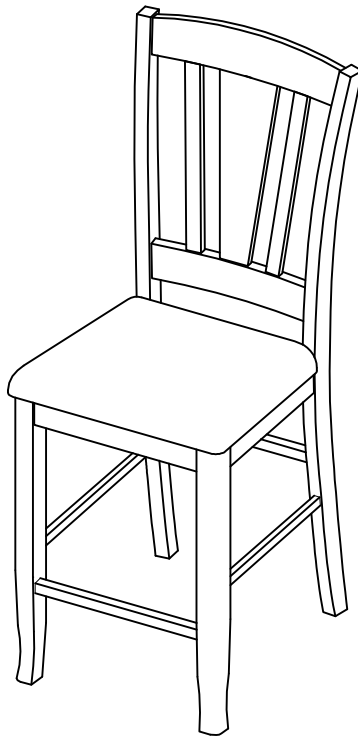

## ASSEMBLY RATING

The Assembly Rating is a 5-point system that shows the degree of effort needed in assembling a specific product (with 1 being easy and 5 being difficult). For some products, two persons are recommended.

EASY



DIFFICULT

## Tools Required For Assembly:

Allen Wrench

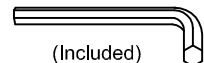

(Included)

Phillips Screwdriver



(Not Included)

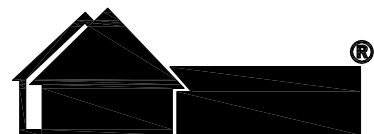

**Furniture of America®**

# ASSEMBLY & CARE ADVICE

FOR YOUR FURNITURE TO LAST, CORRECT ASSEMBLY AND PROPER MAINTENANCE ARE NECESSARY. PLEASE FOLLOW THE INFORMATION PROVIDED BELOW TO FULLY ENJOY YOUR FURNITURE.

## BASIC ASSEMBLY TECHNIQUES

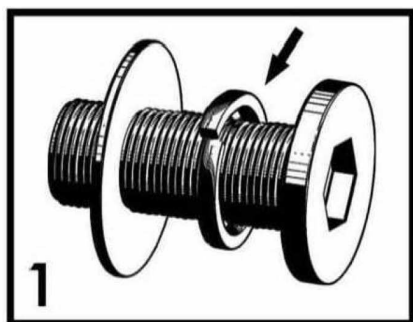

When lock or spring washer is used in an assembly, please make sure the lock or spring washer is placed between the larger flat washer and the head of the screw or bolt.

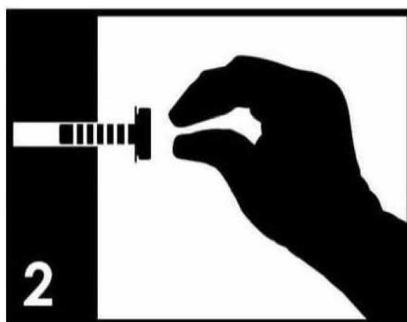

Position each part correctly and insert screws or bolts into their respective holes by hand tighten or using the proper hand tool. Only tighten when step is completed or when instructed to do so.

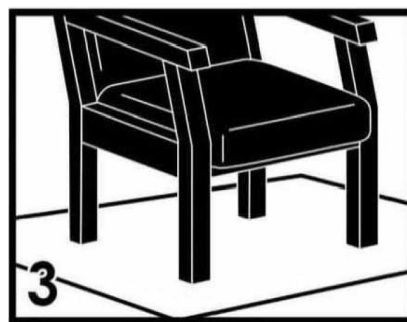

Use cardboard or carpet area when assembling furniture to prevent scratches. Make sure the furniture rests on a flat and level surface with each leg evenly touching the floor.

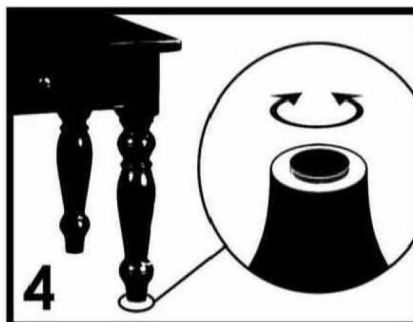

Some furniture comes with height adjustment knobs underneath each leg. To lower or to raise each leg, you need to turn clockwise or counterclockwise, respectively.

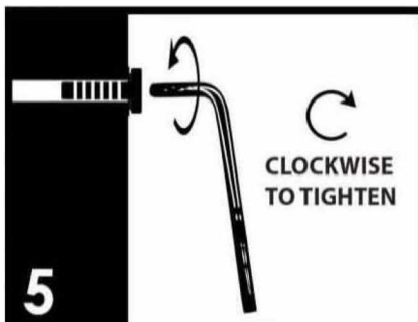

Make sure all parts are properly aligned, then use the appropriate hand tool to completely tighten the bolts or screws. Do not use power tools and do not overtighten.

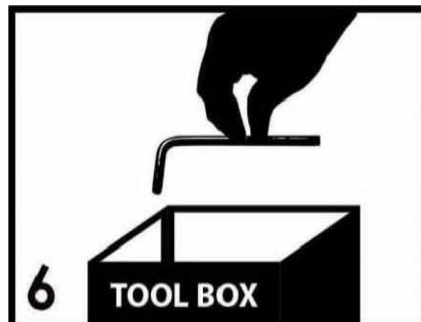

Save the instructions and store the Allen wrench or any supplied tool for later maintenance. After two weeks, check and tighten any loose hardware and repeat again every six months thereafter.

IT IS THE USER'S RESPONSIBILITY TO MAINTAIN THE FURNITURE. THE HARDWARE MAY LOOSEN OVER TIME AND MAY CAUSE THE FURNITURE TO BE WOBBLY AND UNABLE TO SUPPORT ITS INTENDED WEIGHT CAPACITY. THIS MAY LEAD TO COLLAPSE AND MAY CAUSE SERIOUS INJURY.

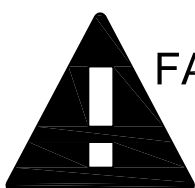

**FAILURE TO FOLLOW THE GUIDELINES ABOVE MAY RESULT IN INJURY AND/OR PROPERTY DAMAGE.**

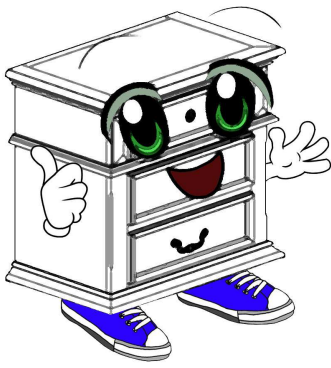

Before you begin, please read Page 2 of "Assembly and Care Advice".

And remember, do not tighten until each step is completed or instructed.

### Parts List

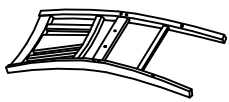

#1 x 1pc x 2  
Backrest w/Legs

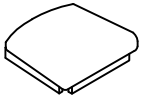

#2 x 1pc x 2  
Seat

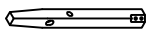

#3 x 2pcs x 2  
Front Leg (L&R)



#4 x 2pcs x 2  
Leg Support (L&R)



#5 x 1pc x 2  
Front Leg Support

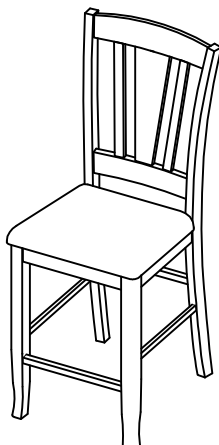

X 2

### Hardware List



#A x 4pcs x 2  
Bolt 1/4" X 3"



#B x 4pcs x 2  
Bolt 1/4" X 2-1/2"



#C x 2pcs x 2  
Bolt 1/4" X 1-1/2"



#D x 10pcs x 2  
Lock Washer



#E x 10pcs x 2  
Flat Washer



#F x 1pc x 2  
Allen Wrench



#G x 6pcs x 2  
Screw



#C x 2pcs  
#D x 2pcs  
#E x 2pcs

- I. Align the seat (#2) with the pre-drilled holes of the backrest with legs (#1).
- II. Prepare 2 bolt assemblies by inserting FIRST the lock washer (#D) onto the bolt (#C) and then the flat washer (#E) onto that SAME bolt (#C), in that order. Insert the bolt assemblies through the pre-drilled holes in the center of the seat (#2). Secure using the Allen wrench (#F).

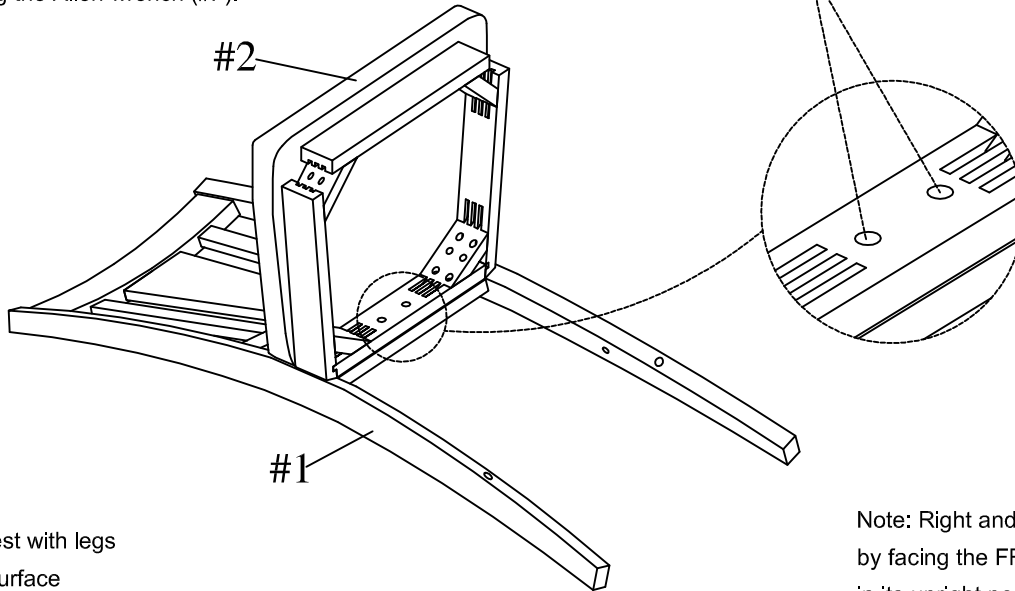

Place the backrest with legs  
on a protected surface

Note: Right and left are determined  
by facing the FRONT of the chair  
in its upright position.



#A x 4pcs  
#D x 4pcs  
#E x 4pcs

Prepare 4 bolt assemblies by FIRST  
inserting the lock washer (#D) into the  
bolt (#A) then the flat washer (#E) onto  
that SAME bolt (#A), in that order. Insert  
into the back corners of the seat (#2)  
and secure using the Allen wrench (#F).

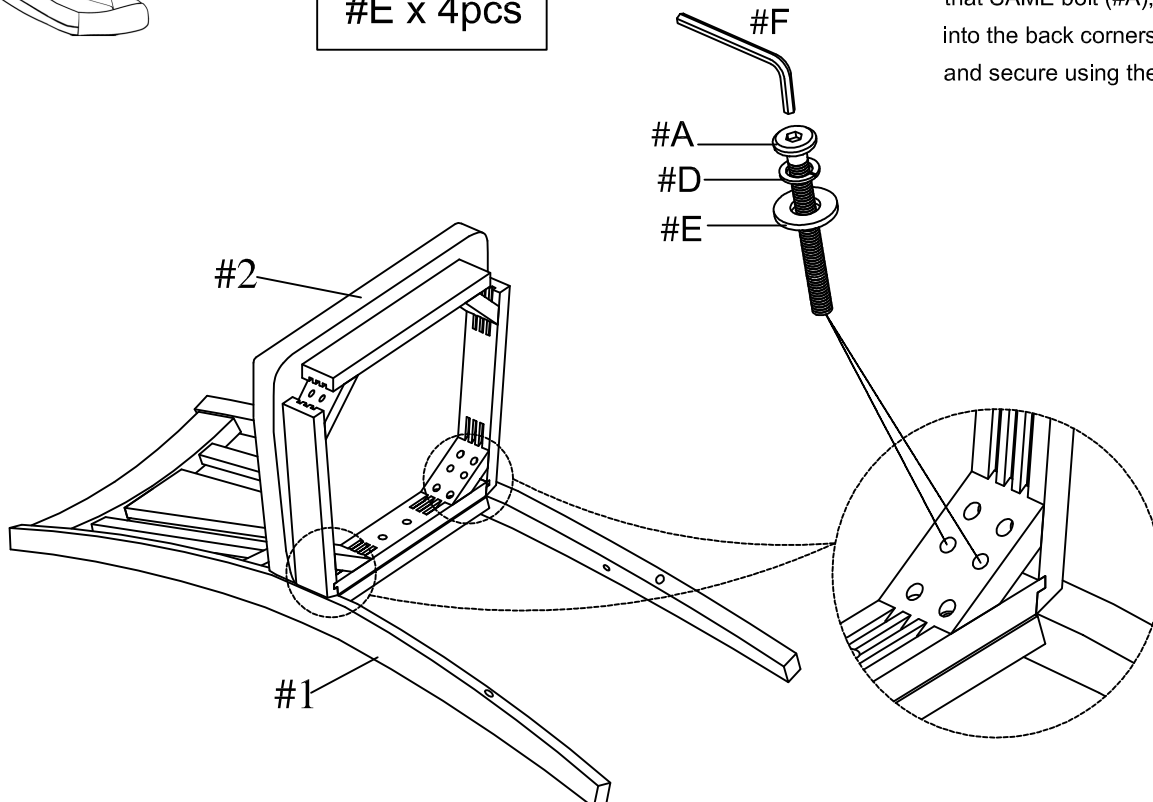



#B x 4pcs  
#D x 4pcs  
#E x 4pcs

- I. Align the front right leg (#3R) and left leg (#3L) to the seat (#2).
- II. As you align the legs, insert the front leg support (#5) and leg supports (#4R/L) into the designated slots along the legs.
- III. Prepare 4 bolt assemblies by FIRST inserting the lock washer (#D) onto the bolt (#B) then the flat washer (#E) onto that SAME bolt (#B), in that order. Insert bolt assemblies into the holes on the corners of the seat and secure using the Allen wrench (#F).

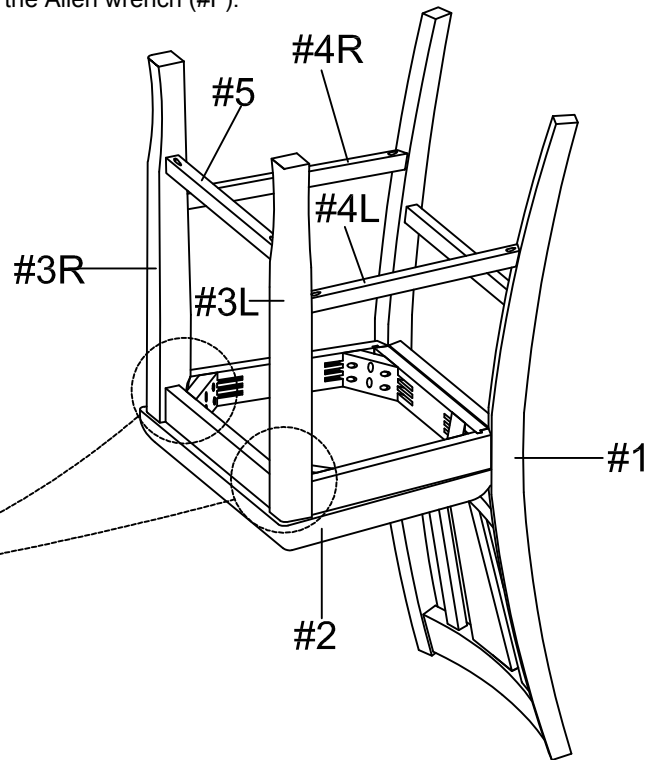
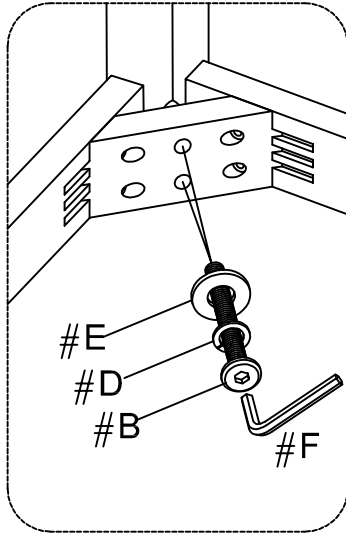

#G x 6pcs

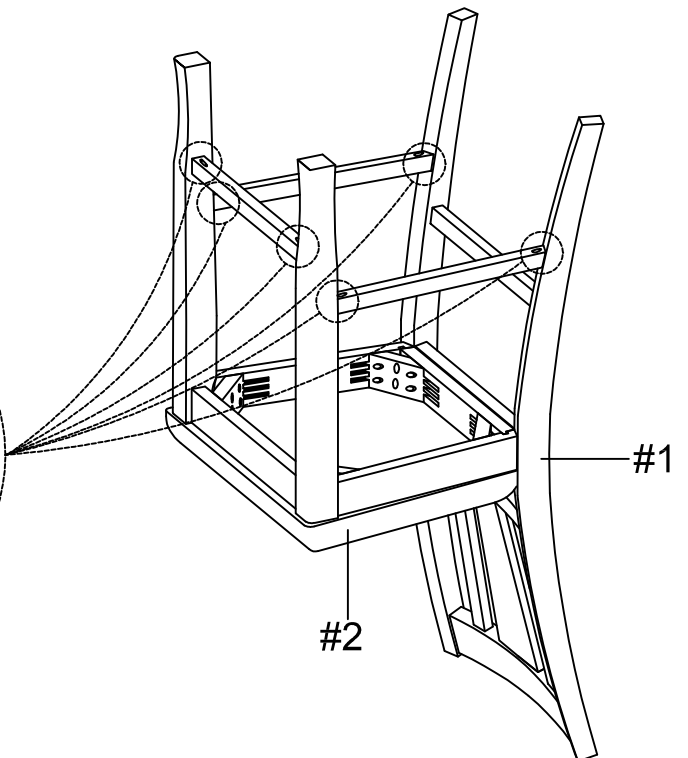
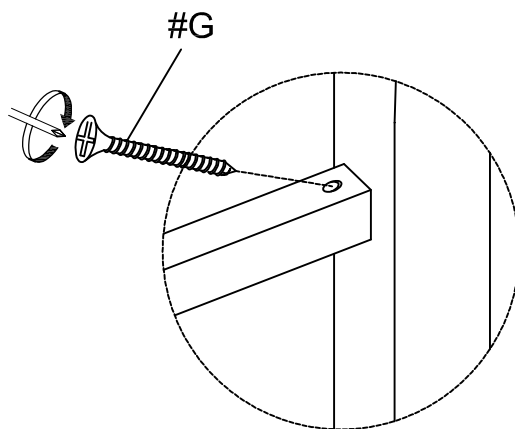

. Insert the wood screw (#G) at a diagonal and secure using a Phillips screwdriver. Tighten screws until properly secure.

**ASSEMBLY IS COMPLETED**