

PLEASE NOTE: Check that you have received all components and hardware before assembling.

Assembly Instructions Side Chair

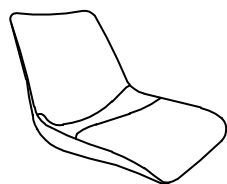

A (1 pc)

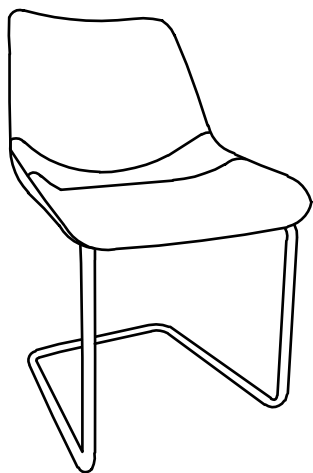
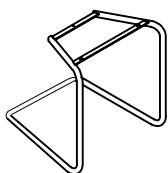

B (1 pc)

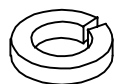

C (3 pcs)



D (3 pcs)

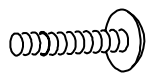

E (3 pcs)
M6 x 25mm

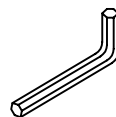

F (1 pc)

1

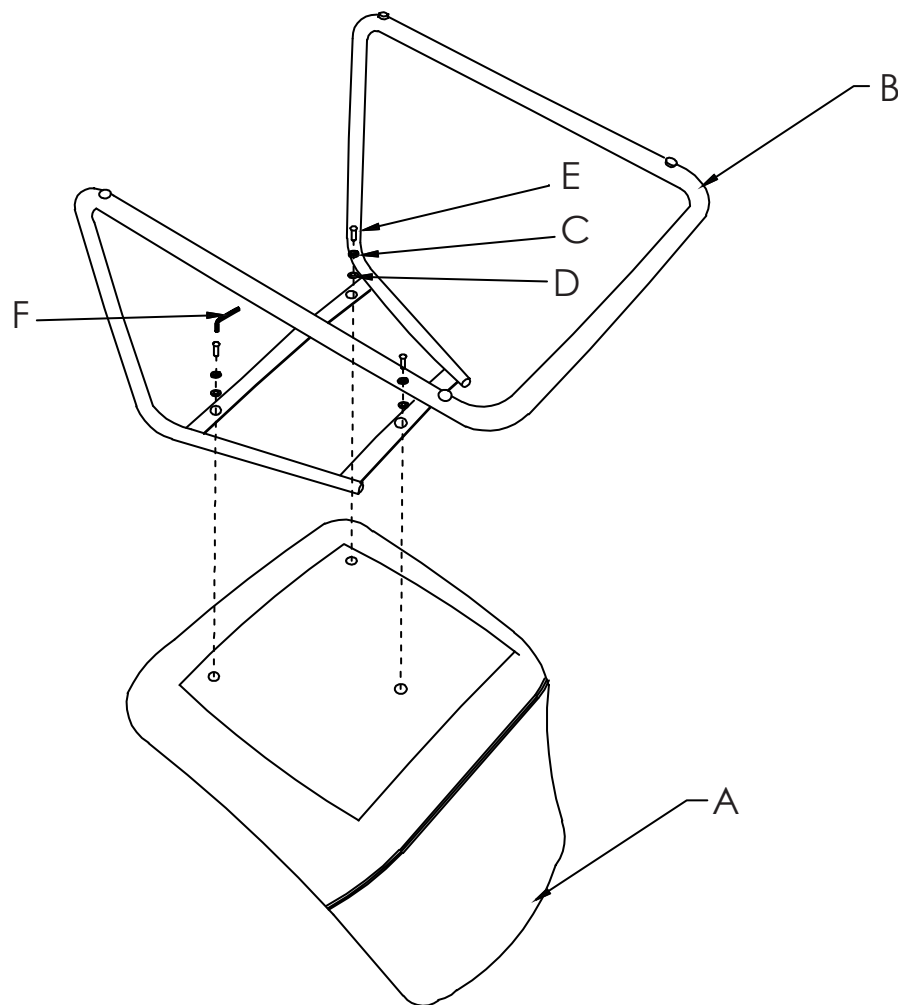

During assembly, hand tighten screws only. When the screws are in place, tighten completely.