

NOTE: WE INCLUDE SPARE HARDWARE IN CASE THE JCB IS DAMAGED DURING ASSEMBLY.



**A** JCB M8 X 45mm - 4 pcs  
Spare - 1 pc



**B** Flat Washer - 4 pcs



**C** Allen wrench - 1 pc

## PARTS LIST

**01 TOP PANEL 1 PC**

**02 LEG 4 PCS**

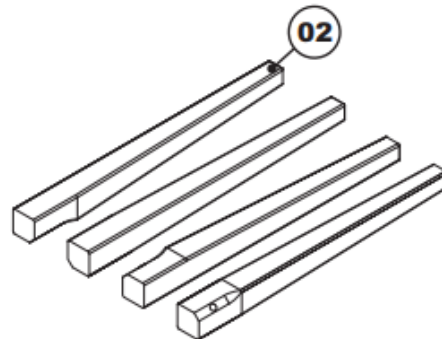
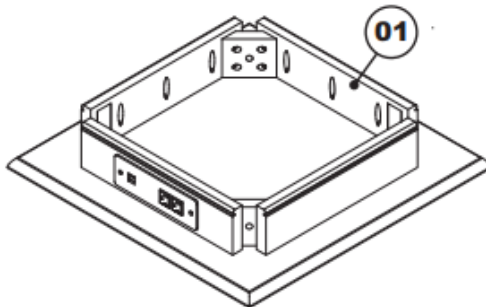

**STEP 1** Attach the legs (02) to the top panel (01) using flat washers (B) and JCB (A), tighten with Allen wrench (C), as shown below.

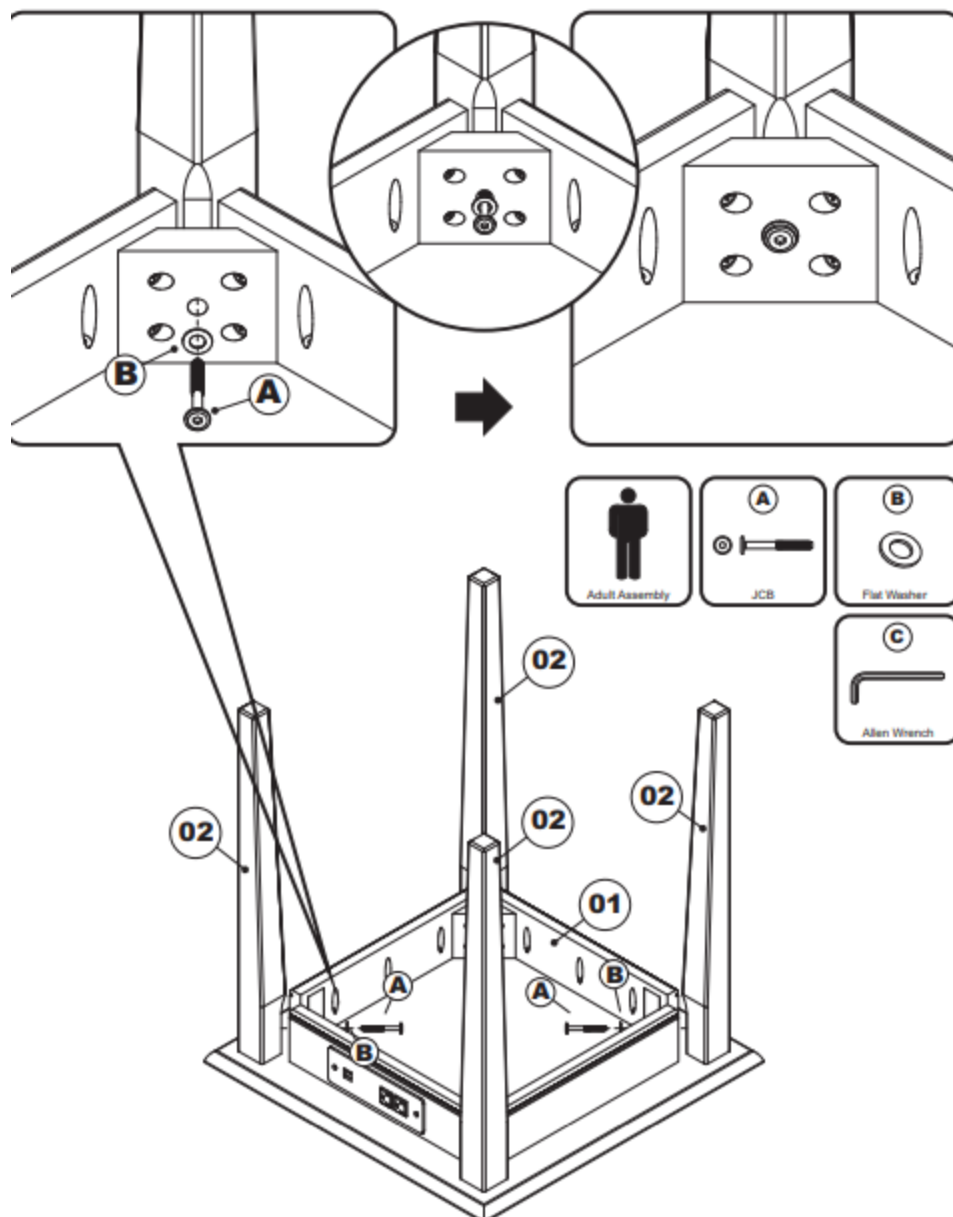

**Congratulations!**

Your Shaker end table is now ready for use.