

INSTALLATION SHEET

Templeton DR Grab Bar Installation

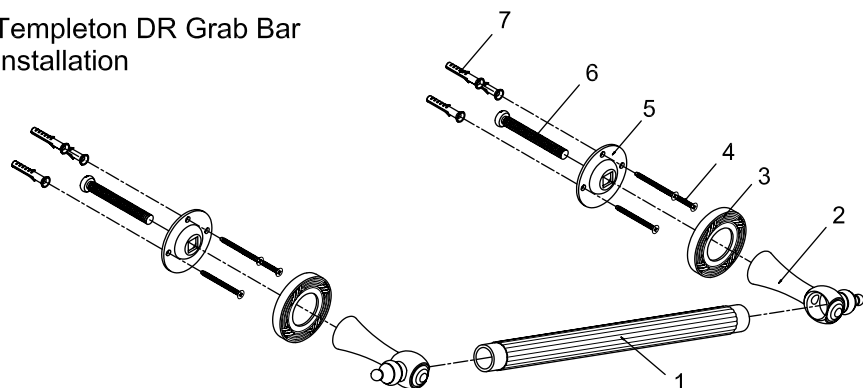

| PART NAME | QUANTITY | PART NAME | QUANTITY |
|------------------|----------|------------------|----------|
| ① Bar | 1 | ⑤ Mounting Plate | 2 |
| ② Base | 2 | ⑥ Screw | 2 |
| ③ Cover | 2 | ⑦ Anchor | 6 |
| ④ Mounting Screw | 6 | | |

Installation Steps:

- Step 1. Locate position on the wall and mark location of the holes for mounting screws. (Fig.1)
- Step 2. Drill holes at the marked locations. (Fig.2)
- Step 3. Insert anchors into the holes until flush with wall. (Fig.3)
- Step 4. Place the unit by tightening mounting screws with phillips screwdriver until the base is tightly fixed. (Fig.4)
- Step 5. Shift cover along the base and place the cover over the mounting plate by pressing gently until the cover is tightly fixed. (Fig.5)

| MODEL | FINISH | MODEL | FINISH |
|----------|----------------|----------|-------------------|
| DR710121 | Chrome | DR710125 | Oil Rubbed Bronze |
| DR710122 | Polished Brass | DR710128 | Satin Nickel |

TOOLS REQUIRED



Flat Head Screwdriver
Phillips Screwdriver
Marking Pencil



Hammer
Power Drill

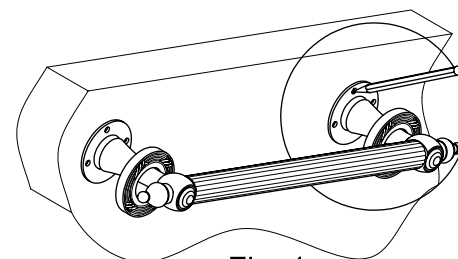

Fig. 1

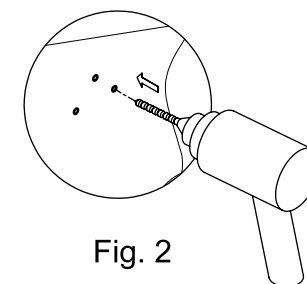

Fig. 2

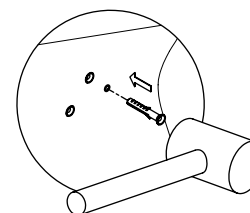

Fig. 3

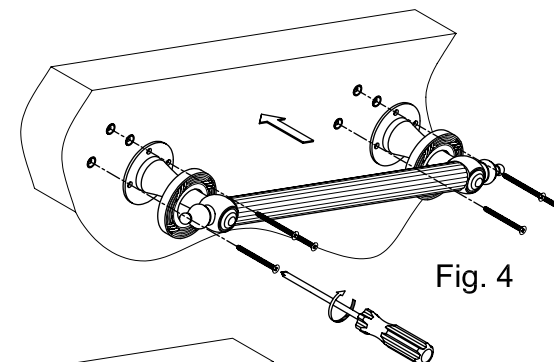

Fig. 4

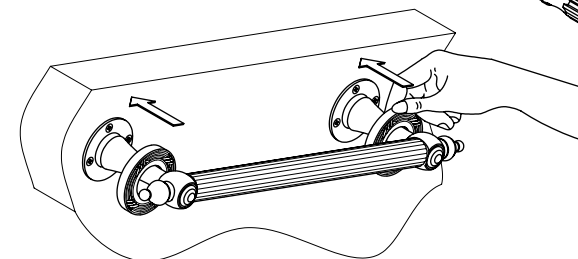

Fig. 5

Cleaning

Clean with a damp cloth only.
Avoid using metal or abrasive polishes.



T 909.465.6687 F 909.548.6843 1877.FAUCET.1
www.eodfaucet.com
email: support@eodfaucet.com