

PLEASE NOTE: Check that you have received all components and hardware before assembling. If you are missing any parts, contact your retailer

## Assembly Instructions Desk

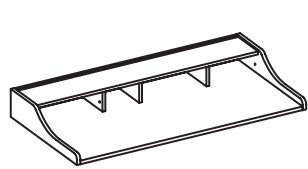

A (1 pc)



B (1 pc)



C (4 pcs)



D (8 pcs)  
M8 x 57mm



E (8 pcs)



F (8 pcs)  
M22 x 2mm



G (8 pcs)

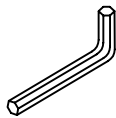

H (1 pc)  
M5

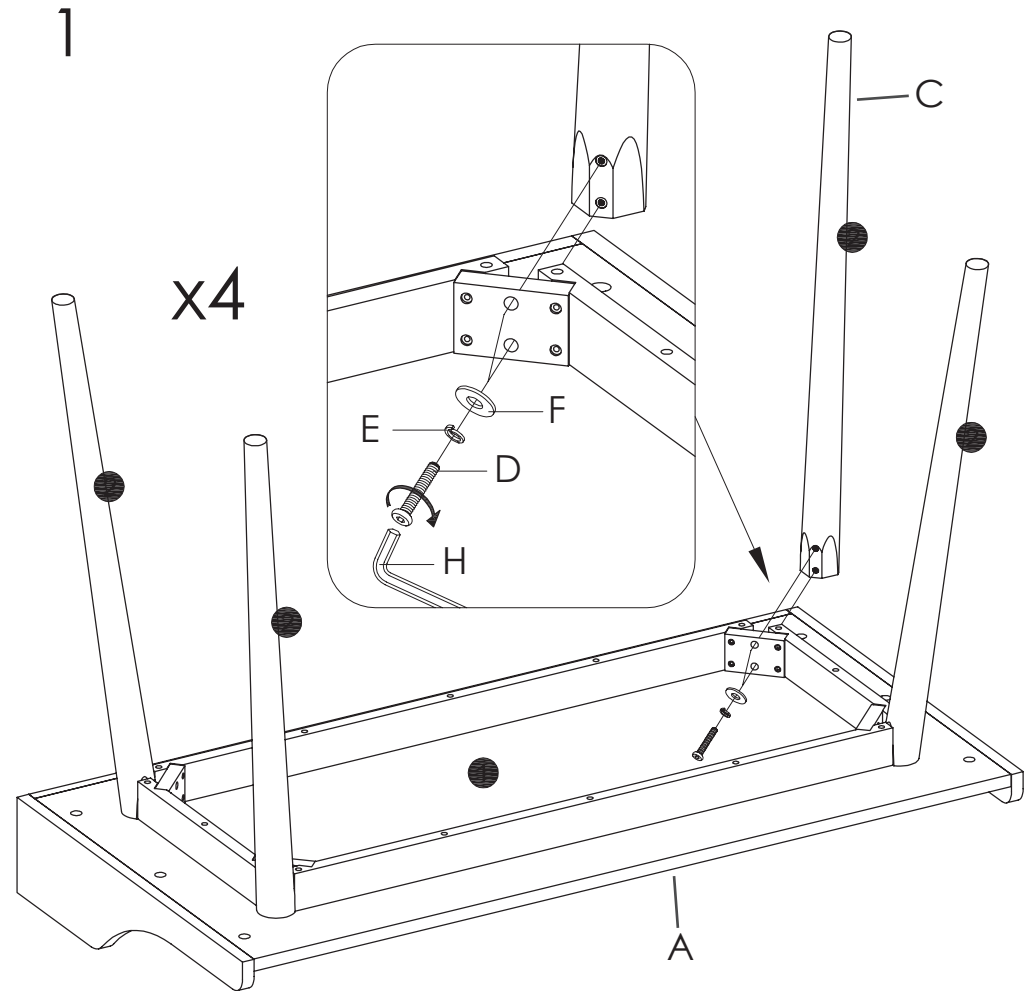

During assembly, hand tighten screws only. When the screws are in place, tighten completely.

PLEASE NOTE: Check that you have received all components and hardware before assembling. If you are missing any parts, contact your retailer

## Assembly Instructions Desk

2

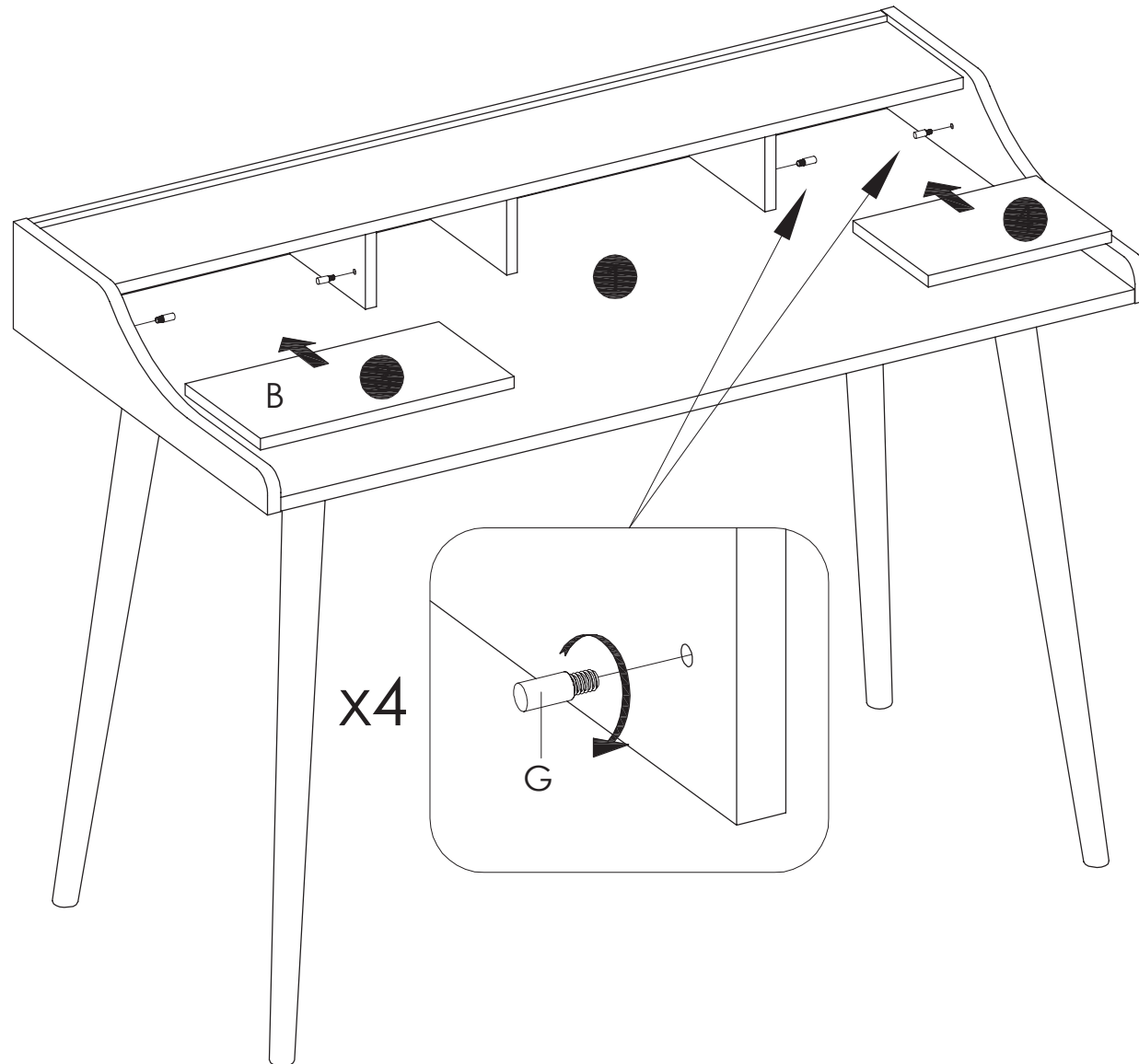

During assembly, hand tighten screws only. When the screws are in place, tighten completely.