

ASSEMBLY INSTRUCTIONS:
1- PLEASE READ THESE INSTRUCTIONS COMPLETELY BEFORE STARTING ASSEMBLY;
2- THE ASSEMBLY MUST BE EXECUTED ON A FLAT AND CLEAN SURFACE;
3- FOR CLEANING PLEASE USE A WATER SEMI WET CLEAN CLOTH FOLLOWING BY A DRY CLEAN CLOTH;
4- DO NOT USE ABRASIVES SOLUTIONS;

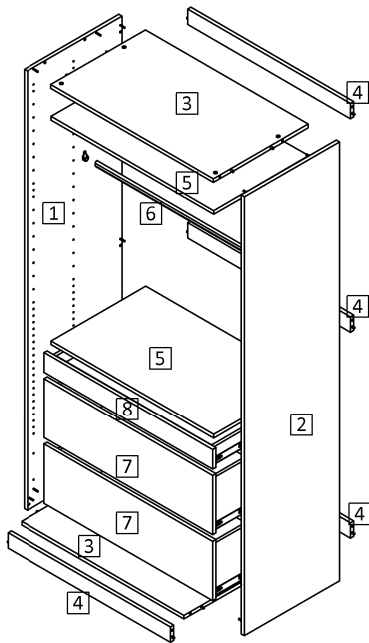

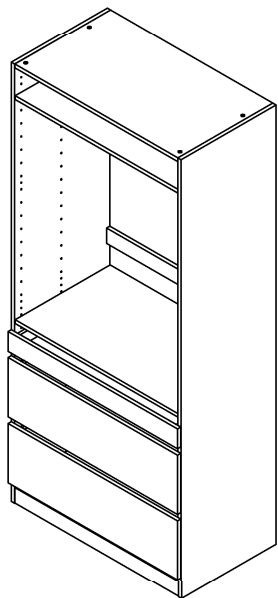

CABINET ASSEMBLY

ASSEMBLY INSTRUCTIONS
BOX 02

PART LIST		
PART NUMBER	Qty	DESCRIPTION:
1	1	LEFT SIDE PANEL
2	1	RIGHT SIDE PANEL
3	2	BOTTOM/TOP PANEL
4	4	FRAME
5	2	SHELVES
6	1	RODS
7	2	LARGE DRAWER
8	1	SMALL DRAWER

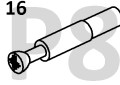

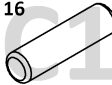
CABINET HARDWARES	16	16	16
	 CAM LOCK SCREWS	 CAM LOCK	 DOWEL 5/16 X 1 3/16

STEP 01
PREPARATION OF THE SIDE PANELS

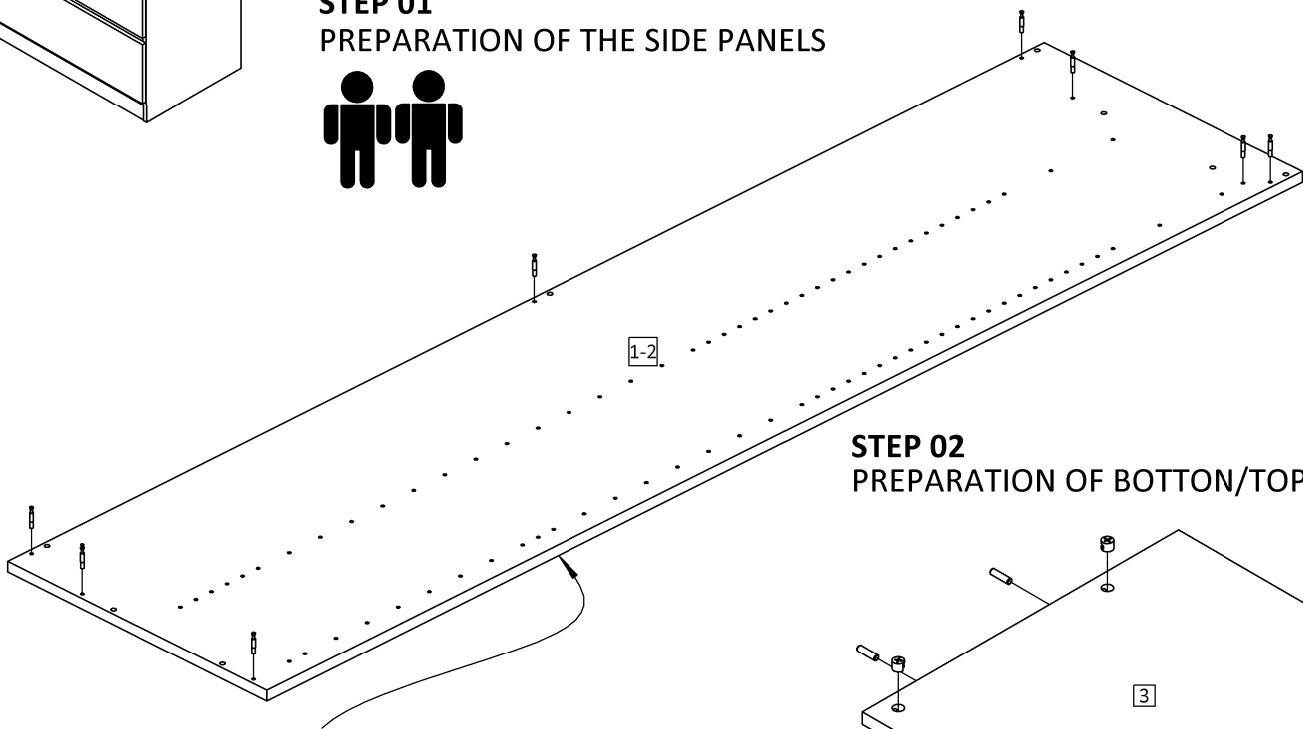

STEP 02
PREPARATION OF BOTTOM/TOP PANELS

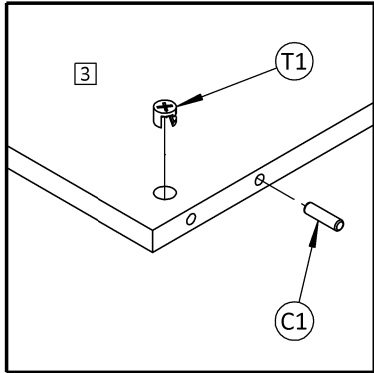
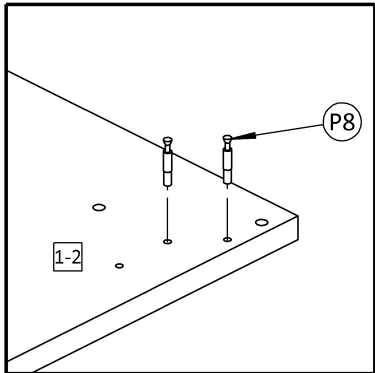
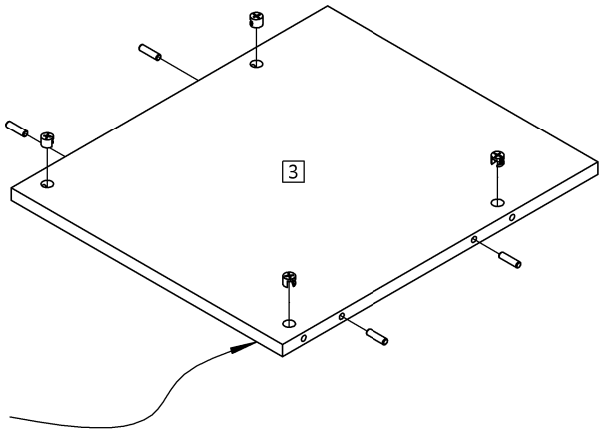

STEP 03
PREPARATION OF THE FRAMES

ASSEMBLY INSTRUCTIONS
BOX 02

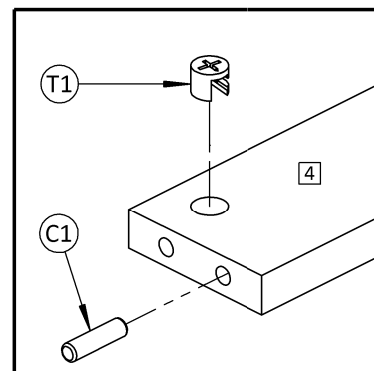
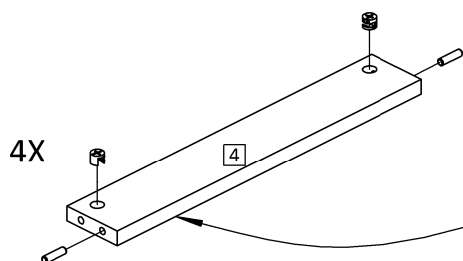

STEP 04
LEFT, TOP, BOTTOM PANELS AND FRAMES ASSEMBLY

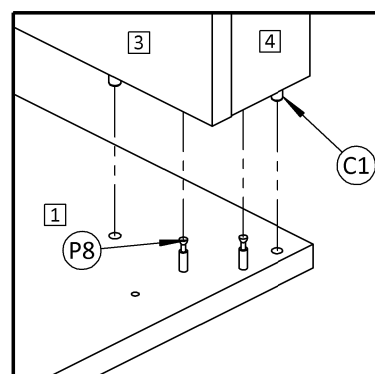
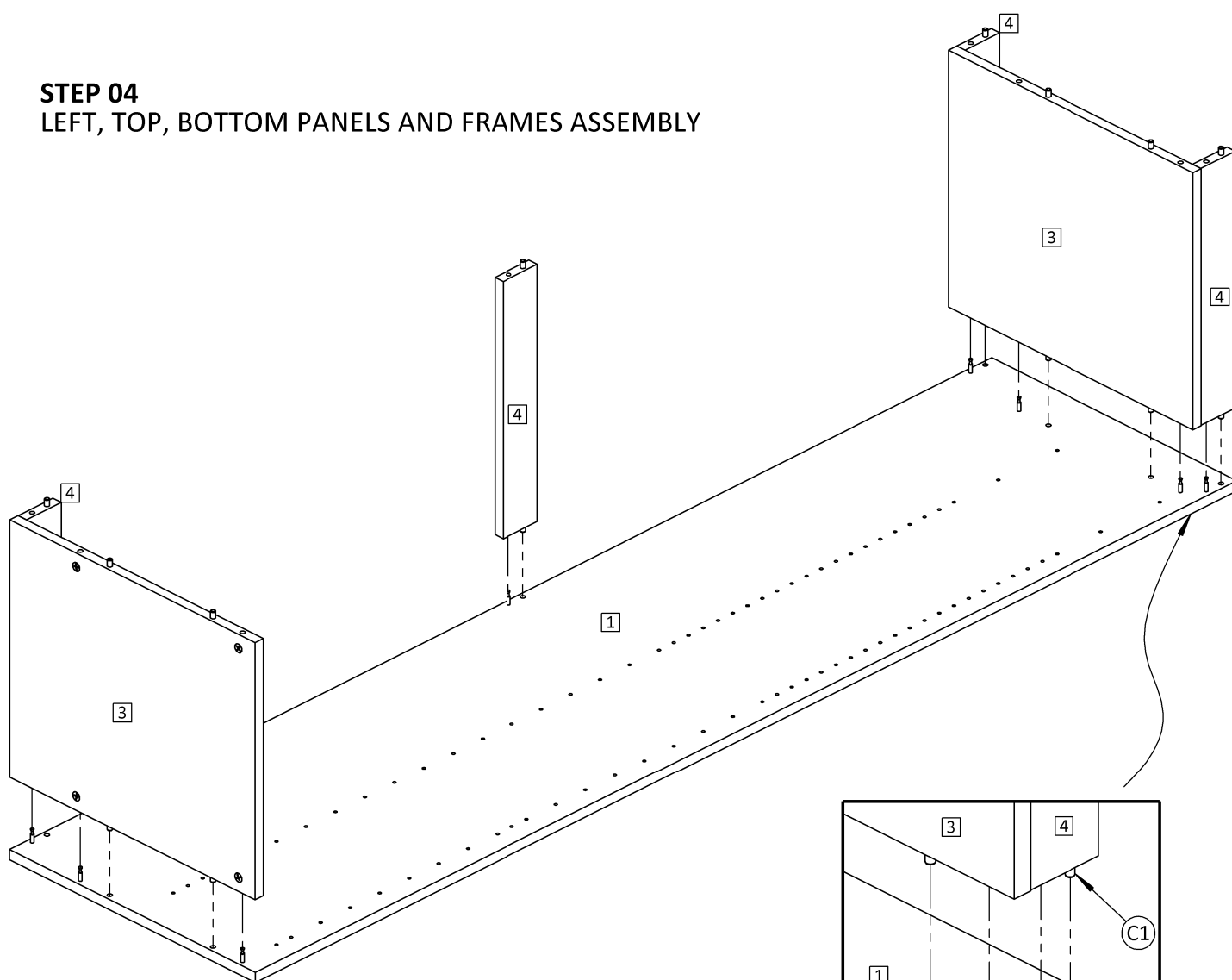

STEP 05
RIGHT SIDE PANEL ASSEMBLY

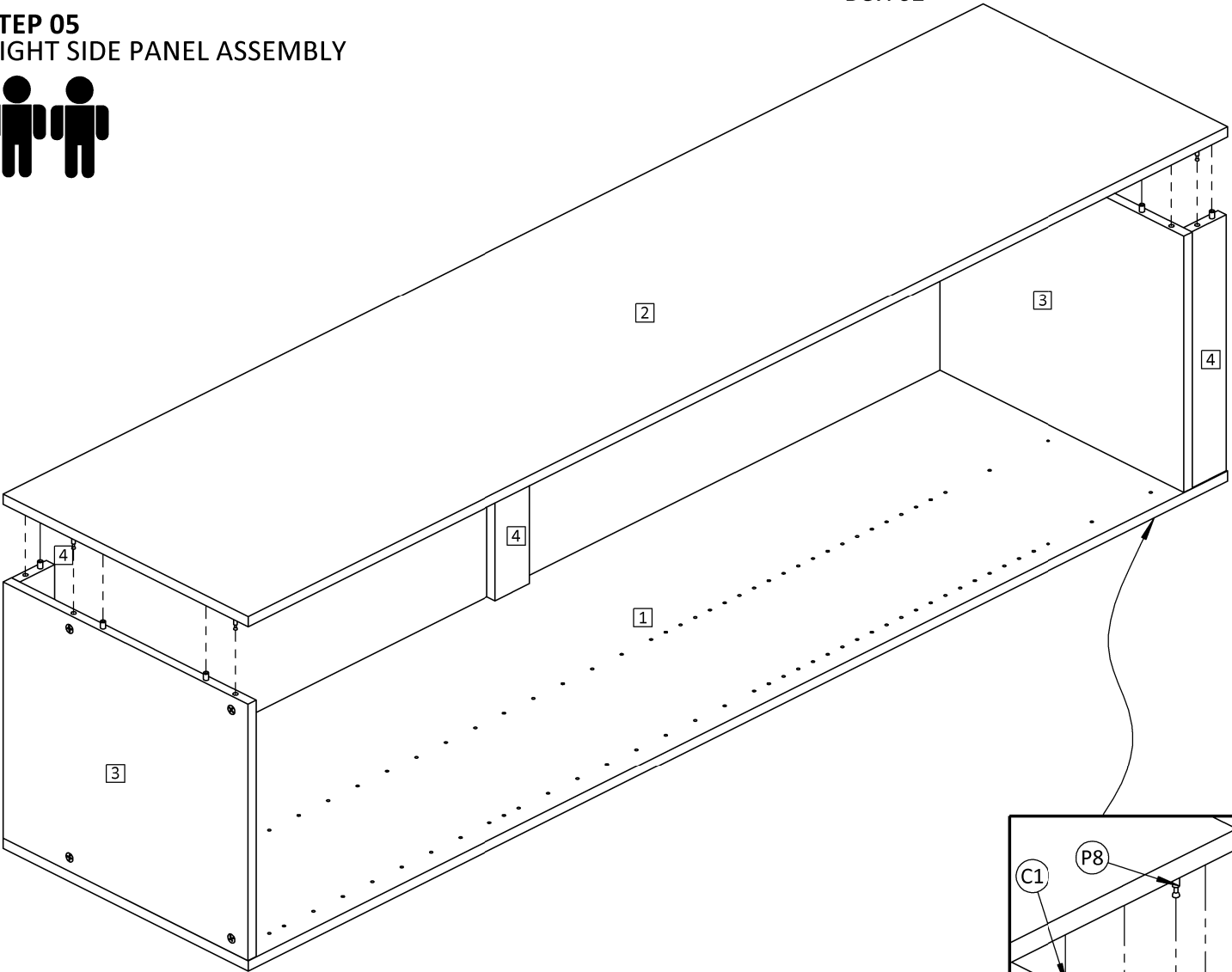
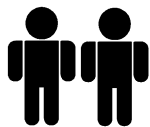

DRAWERS ASSEMBLY

PART NUMBER 7 - LOW DRAWER

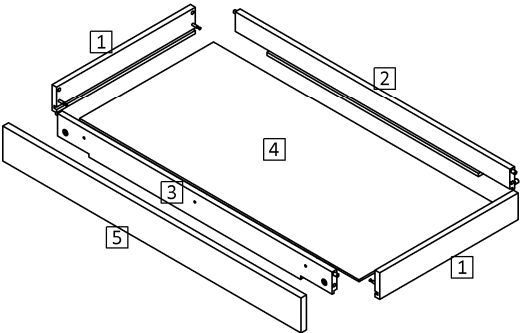

DRAWERS HARDWARES	18	06	12	12	24
	SCREW 9/64 X 1 1/4	SLIDER PIN	CAM LOCK SCREWS	CAM LOCK	DOWEL 5/16 X 1 3/16

STEP 06
PREPARATION OF DRAWER SIDE PANNELS

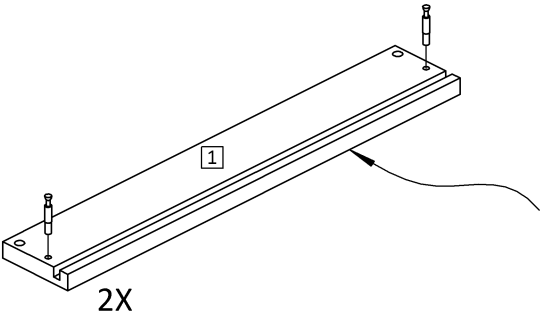

PART LIST		
PART NUMBER	QTY	DESCRIPTION:
1	2	DRAWER SIDE PANEL
2	1	DRAWER BACK PANEL
3	1	DRAWER INSIDE FRONT
4	1	DRAWER BOTTOM PANEL
5	1	DRAWER FRONT

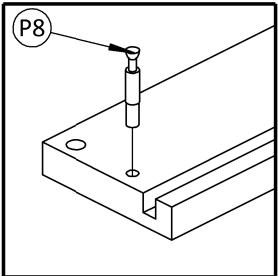

STEP 07 PREPARATION OF DRAWER BACK PANNEL AND DRAWER INSIDE FRONT

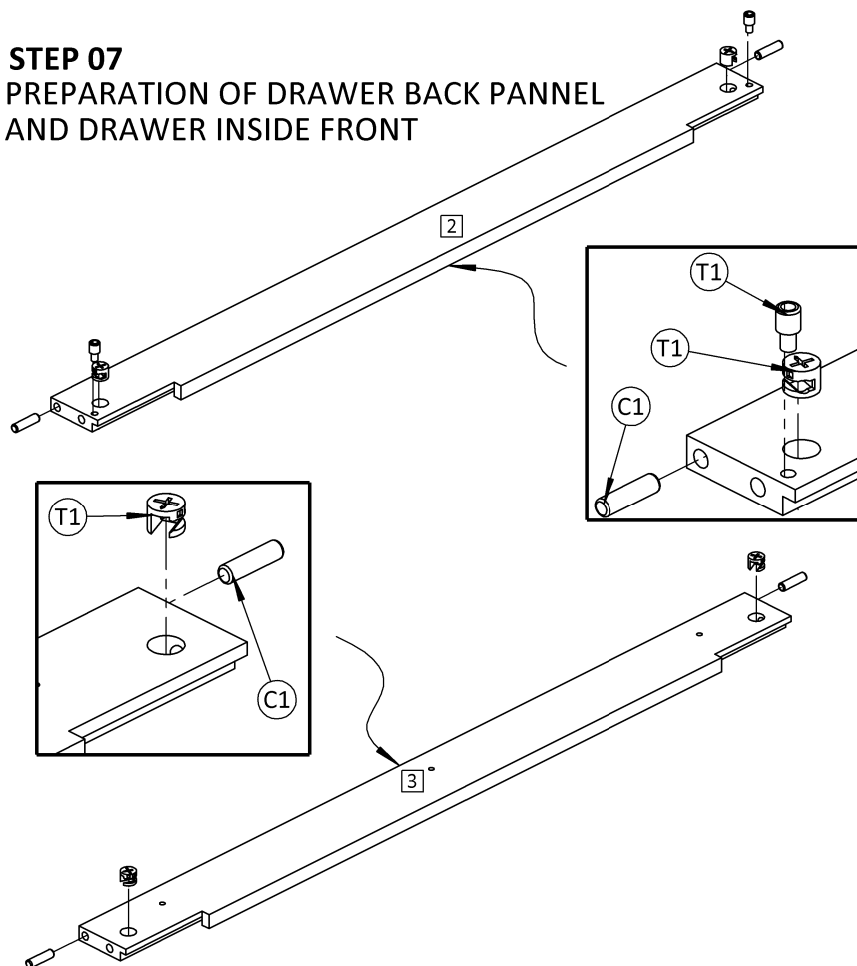

ASSEMBLY INSTRUCTIONS BOX 02

STEP 08 DRAWER ASSEMBLY

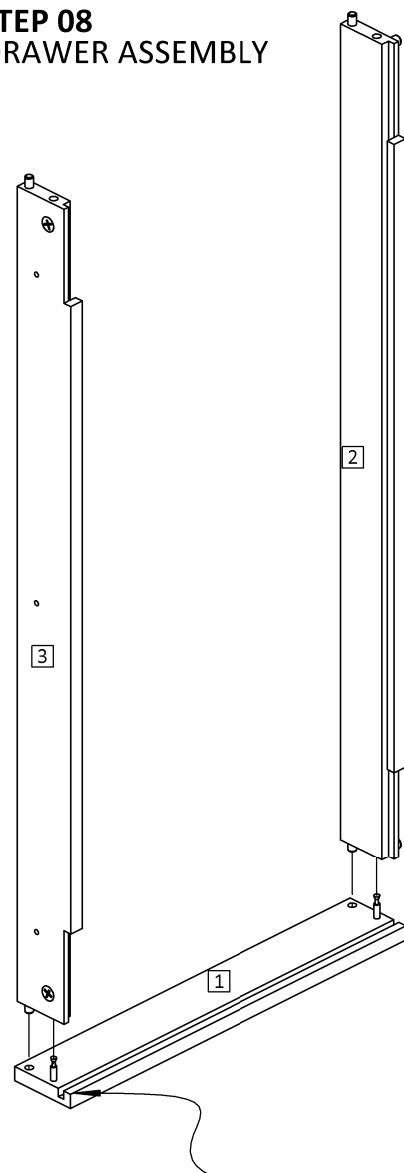

STEP 09 BACK PANNEL ASSEMBLY

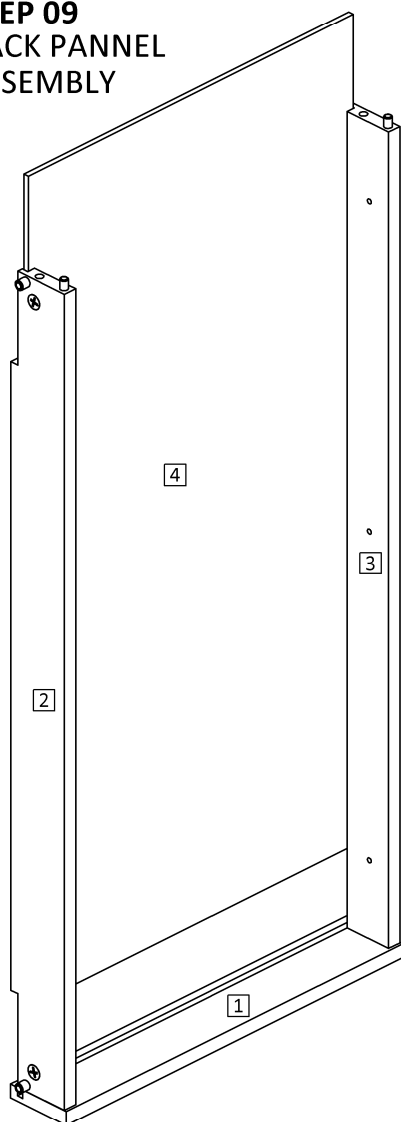

STEP 10 RIGHT SIDE PANNEL ASSEMBLY

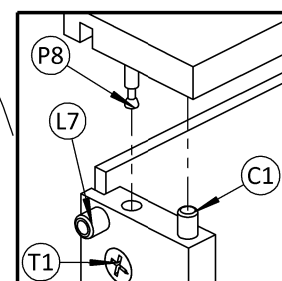
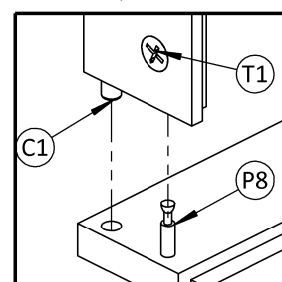
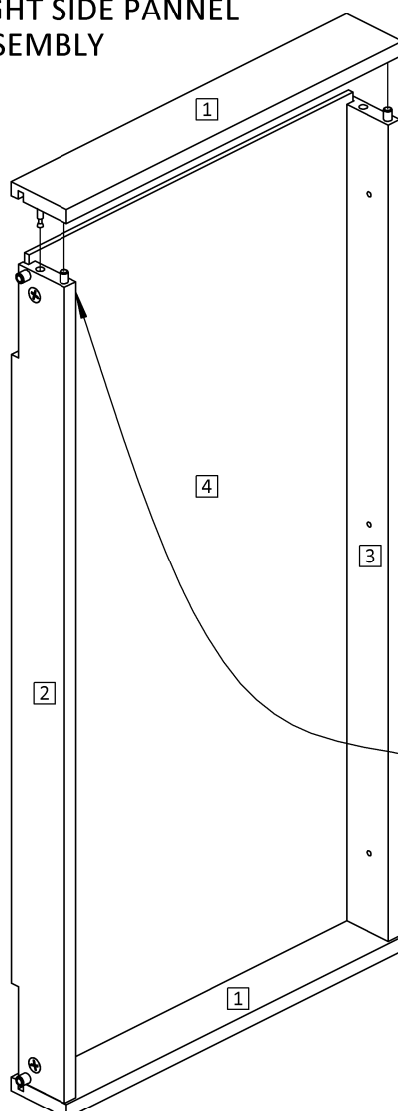

STEP 11
ASSEMBLING FRONT POSITION
DRAWER BACK VIEW

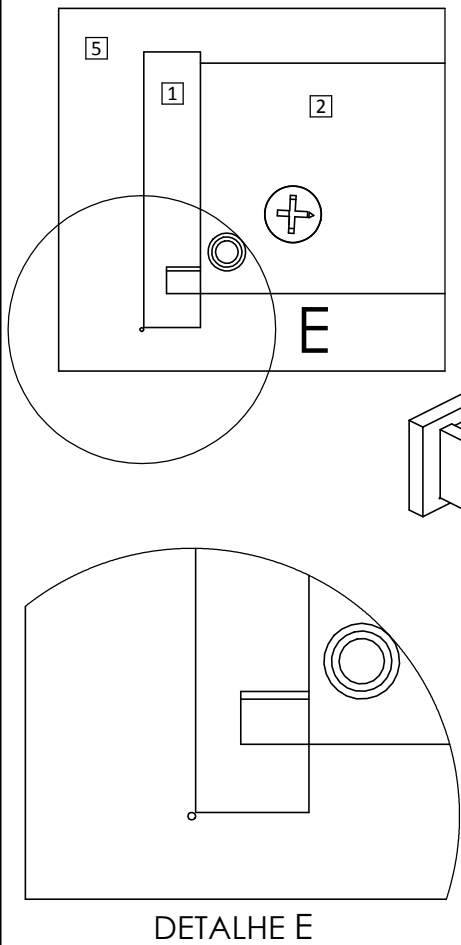

ASSEMBLY INSTRUCTIONS
BOX 02

STEP 12
DRAWER FRONT ASSEMBLY

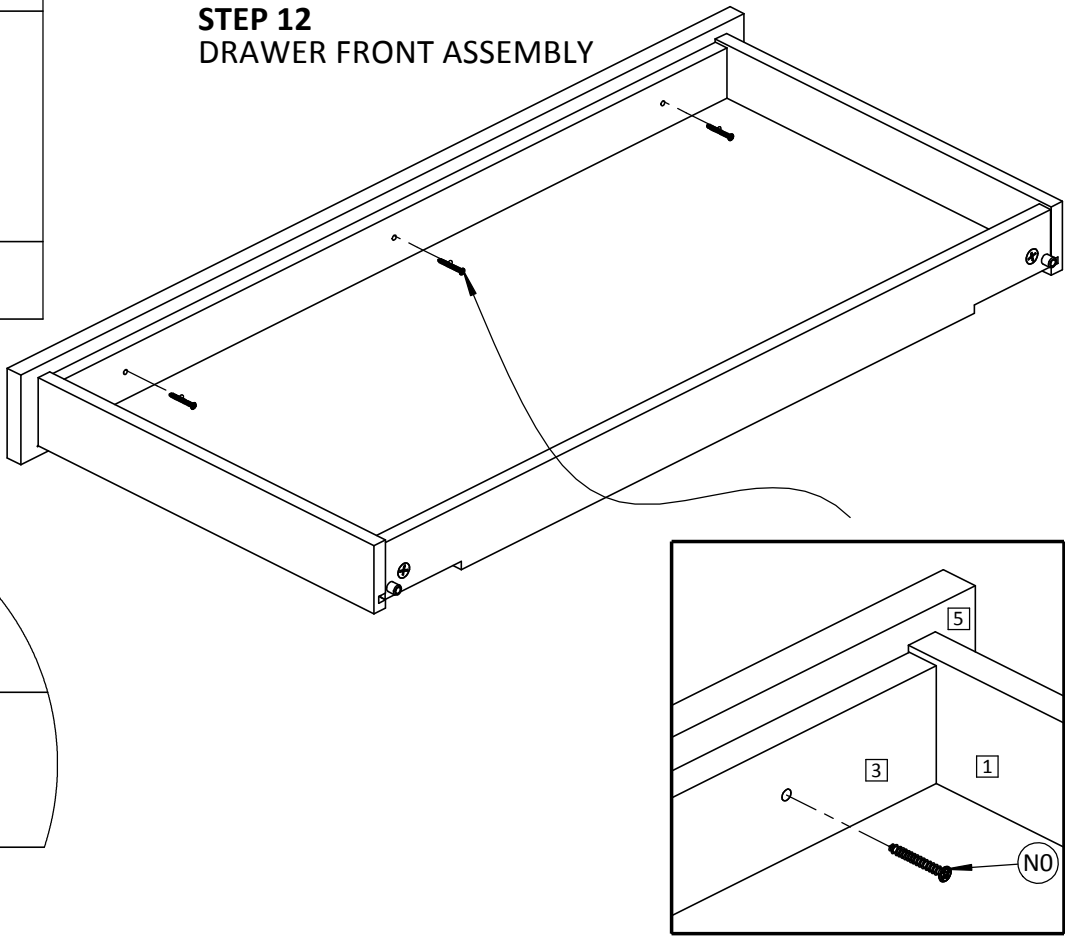

PART NUMBER 8 - LARGE DRAWER

STEP 13
PREPARATION OF DRAWER SIDE PANELS

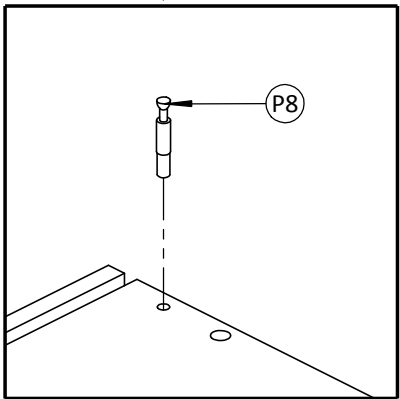
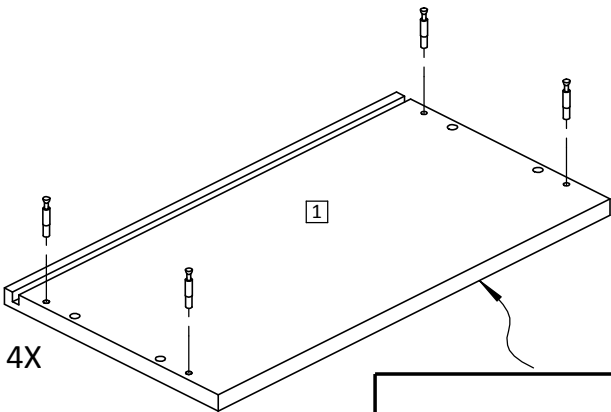
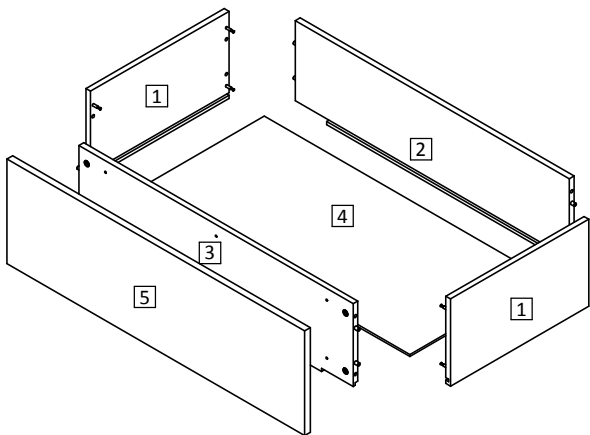

PART LIST		
PART NUMBER	QTY	DESCRIPTION:
1	2	DRAWER SIDE PANEL
2	1	DRAWER BACK PANEL
3	1	DRAWER INSIDE FRONT
4	1	DRAWER BOTTOM PANEL
5	1	DRAWER FRONT

STEP 14
PREPARATION OF DRAWER BACK PANEL
AND DRAWER INSIDE FRONT

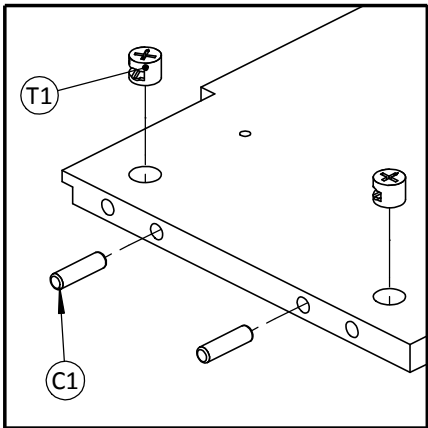
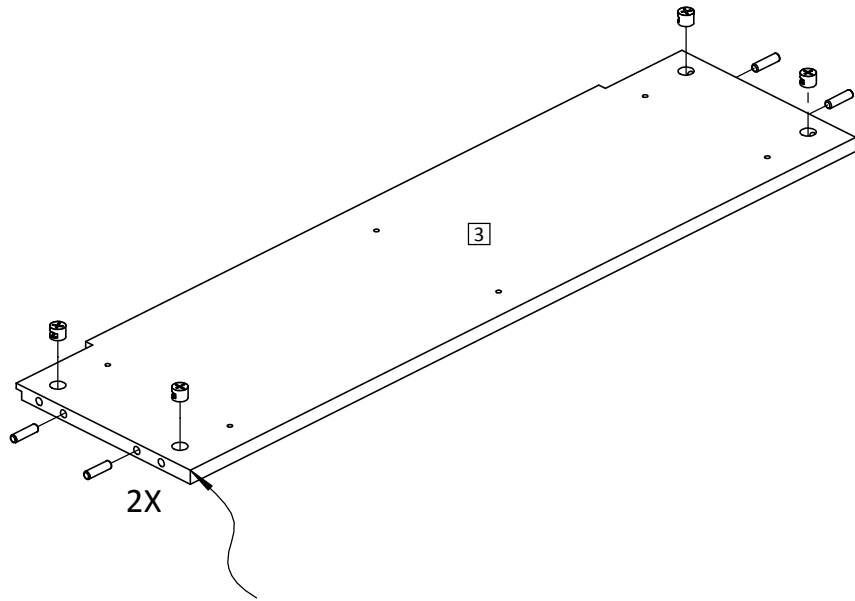
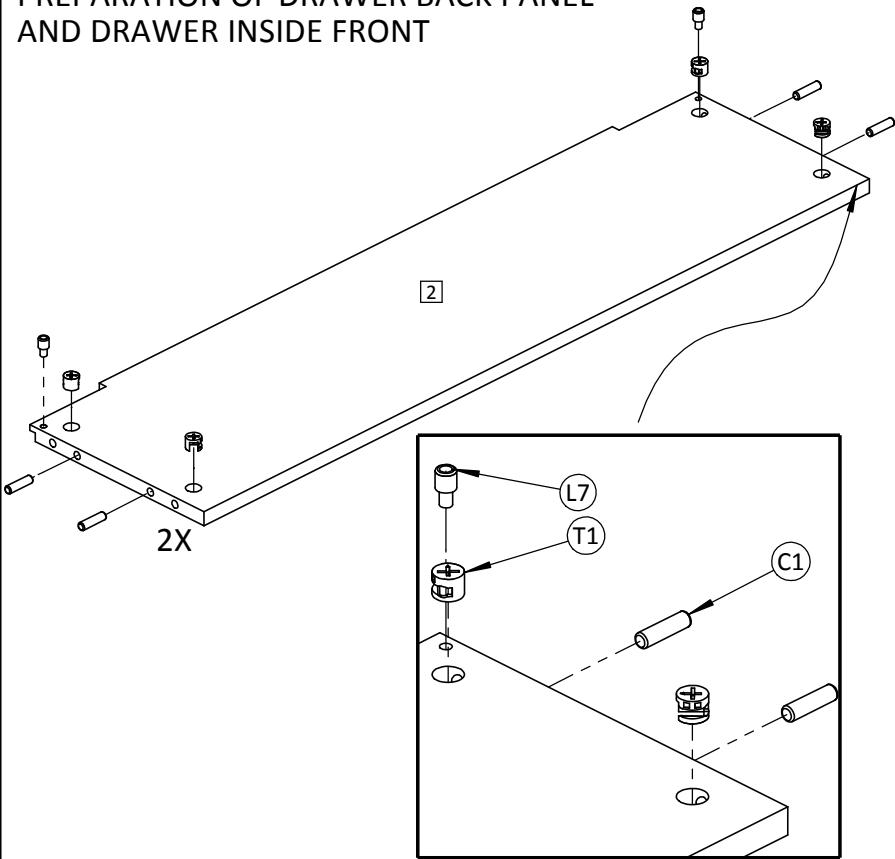

ASSEMBLY INSTRUCTIONS
BOX 02

STEP 15
DRAWER ASSEMBLY

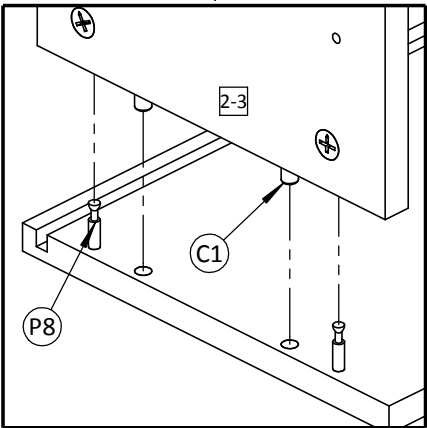
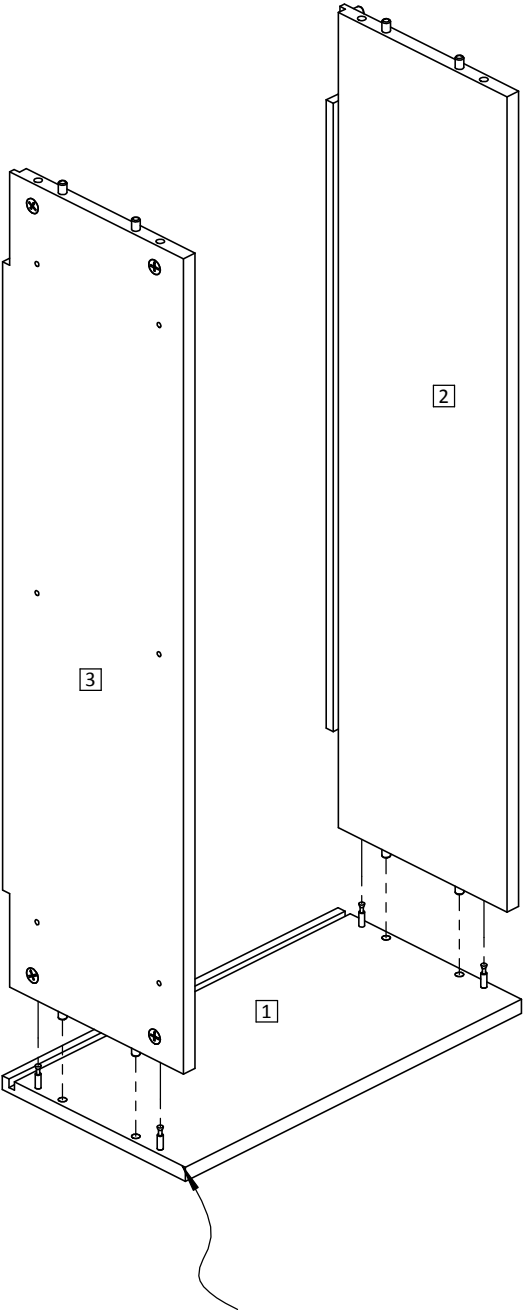

STEP 16
BACK PANEL ASSEMBLY

ASSEMBLY INSTRUCTIONS
BOX 02

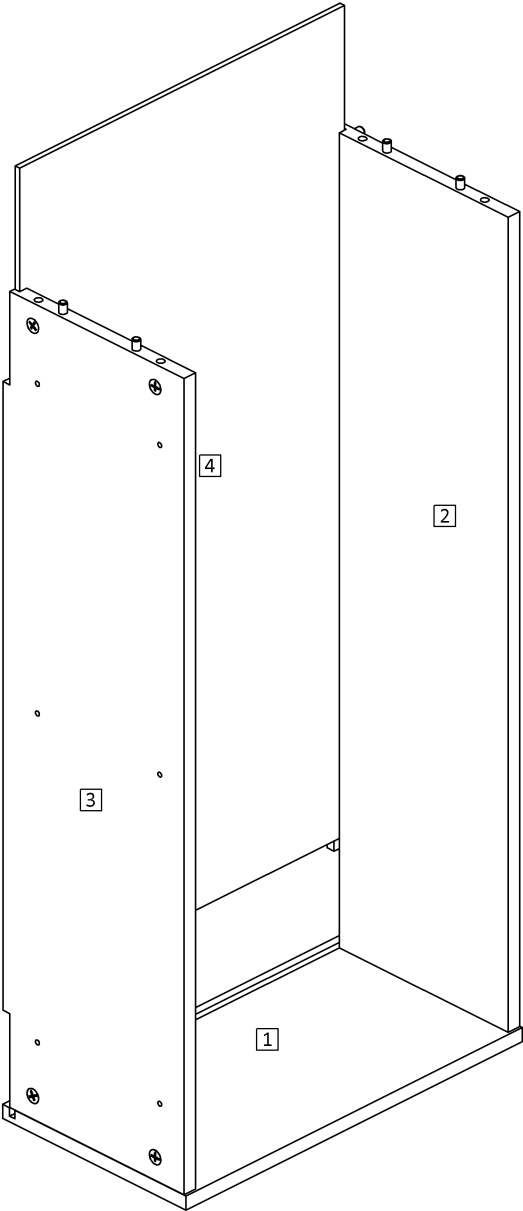

STEP 17
RIGHT SIDE PANEL ASSEMBLY

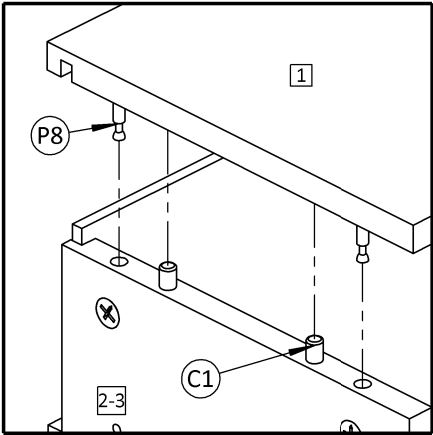
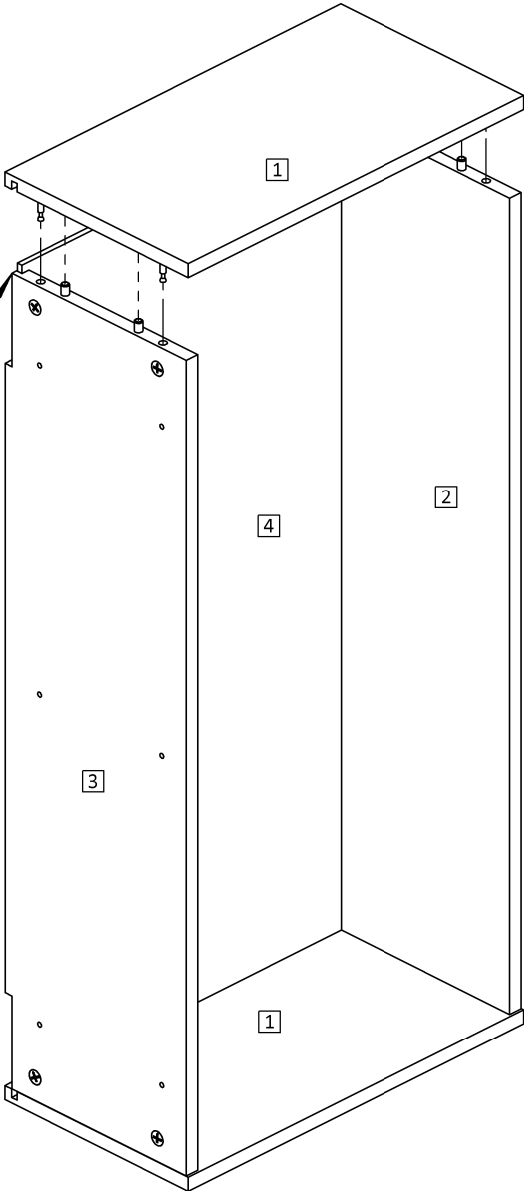

STEP 18
ASSEMBLING FRONT POSITION
DRAWER BACK VIEW

ASSEMBLY INSTRUCTIONS
BOX 02

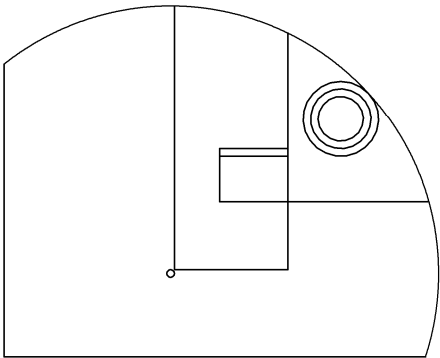
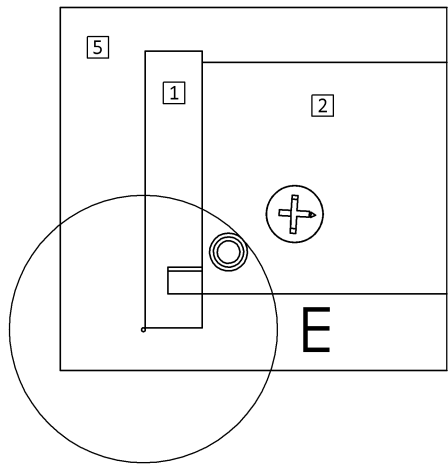

DETALHE E

STEP 19
DRAWER FRONT ASSEMBLY

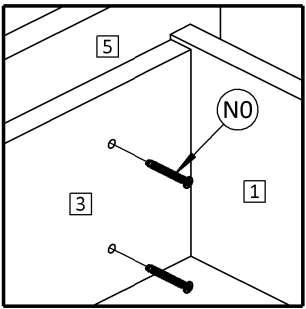
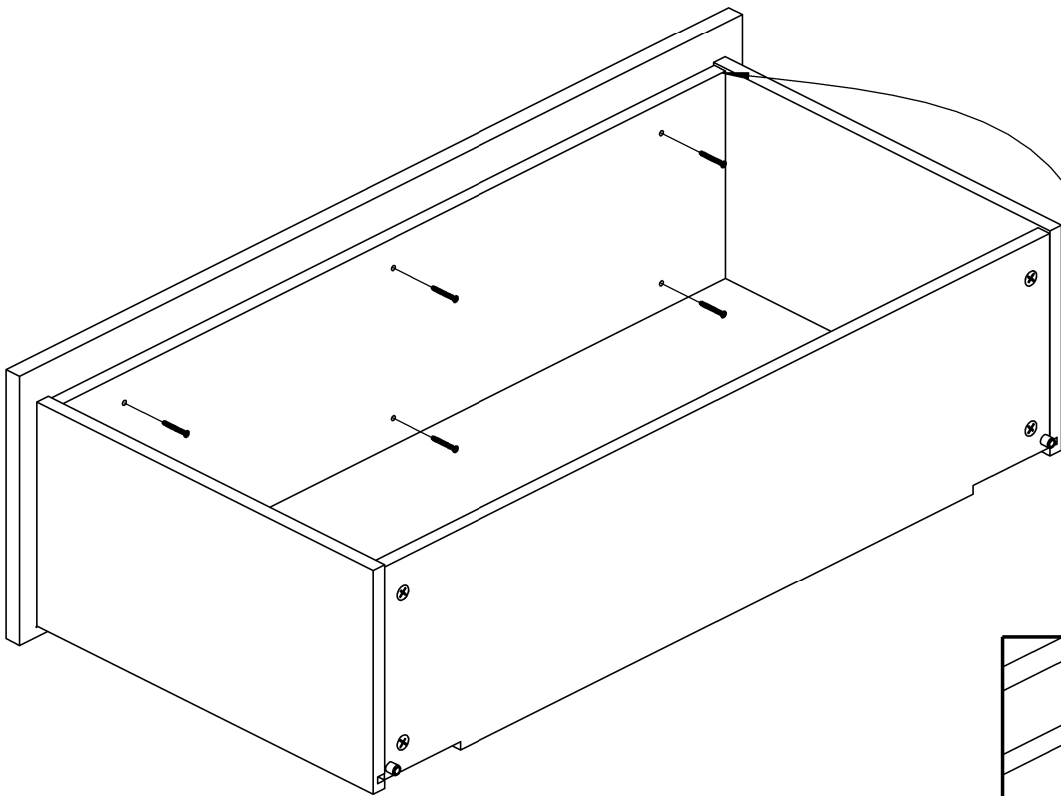

STEP 20 FIXING THE CABINET ON THE WALL

FIXING THE CABINET

DRILL THE WALL
USING A DRILLER
IN ORDER TO
INSERT THE PLUG

ASSEMBLY INSTRUCTIONS BOX 02



IT IS REQUIRED TO FIX
THE CABINETS ON THE WALL
RISK OF FALL!

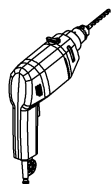

FIXING CABINET HARDWARES	06	06	06	08
	SCREW 5/32 X 2 3/4	SCREW 1/4 X 2 3/4	PLASTIC PLUG	SCREW 9/64 X 1 1/4

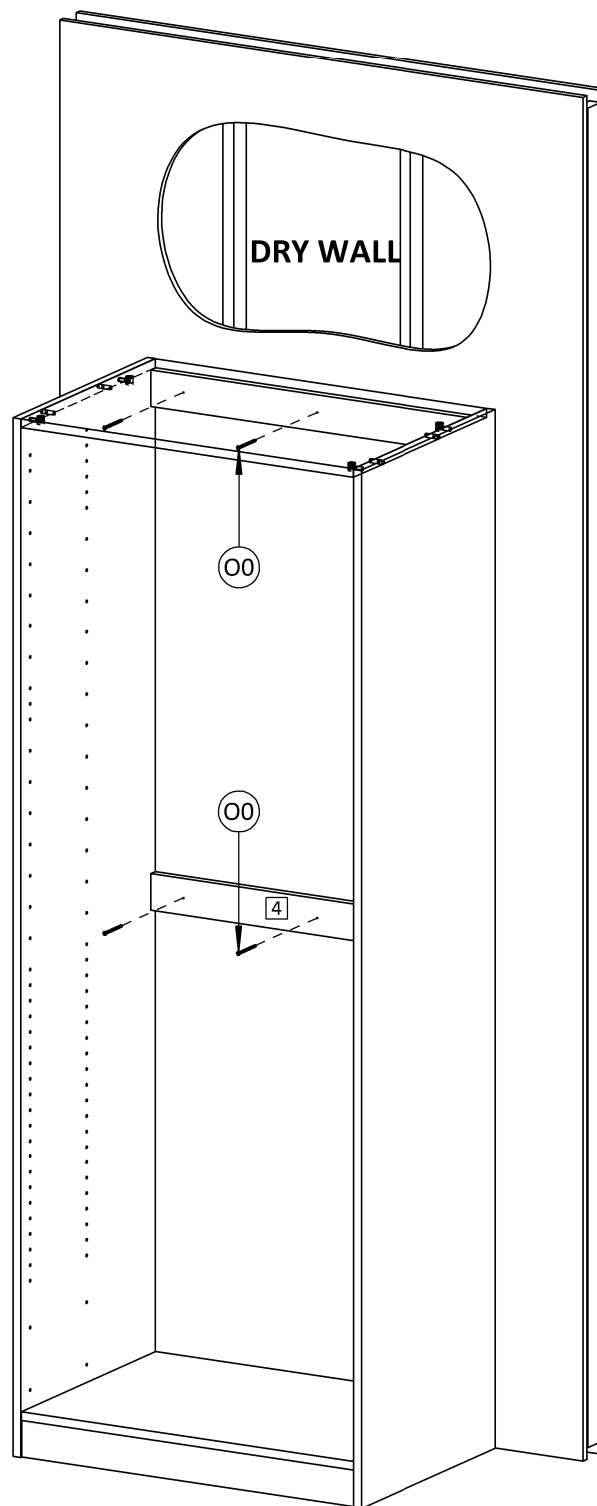
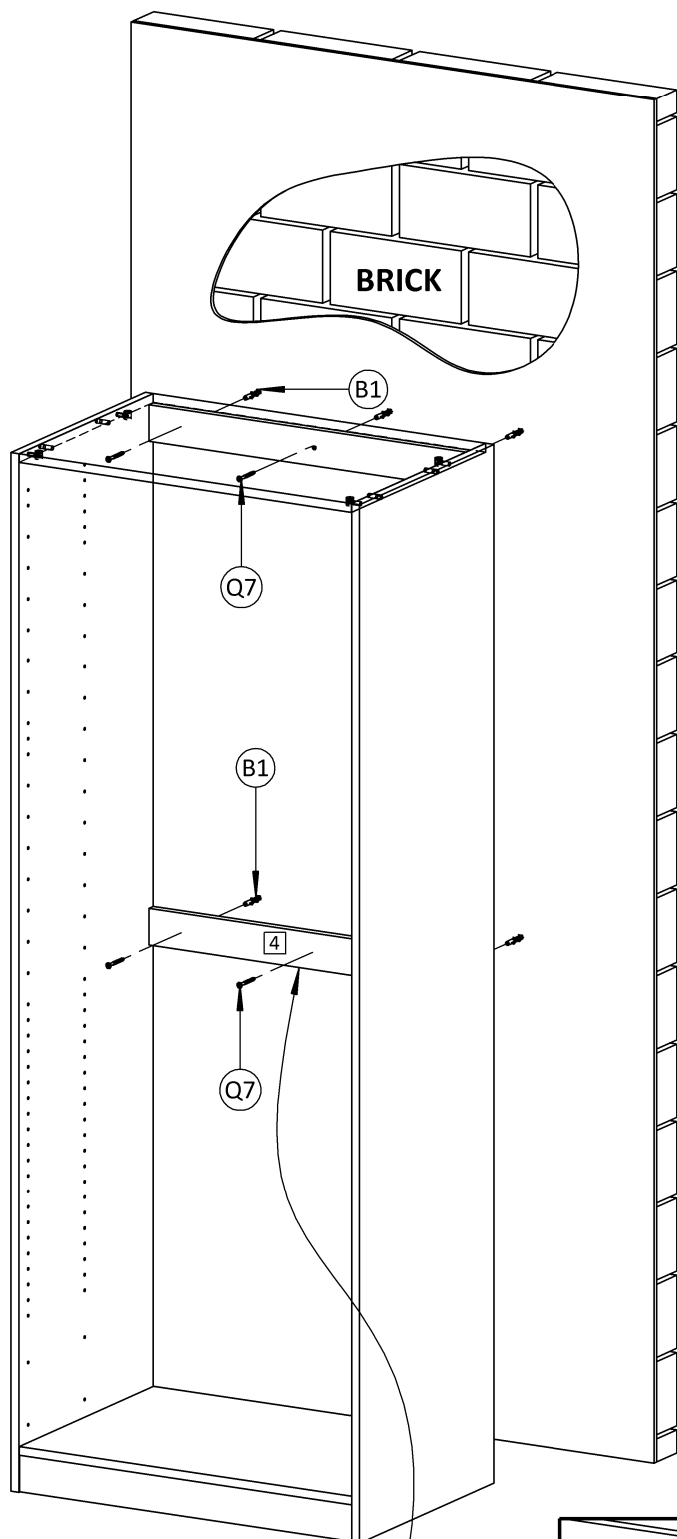

SCREW IN THE CENTER
OF THE FRAME

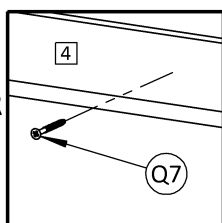

THE CABINET MUST ALWAYS BE
SUPPORTED ON THE GROUND

STEP 21
JOINING THE CABINETS

ASSEMBLY INSTRUCTIONS
BOX 02

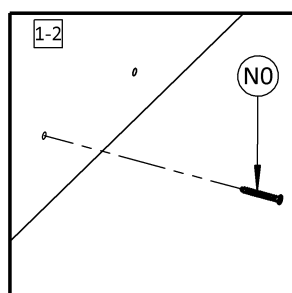
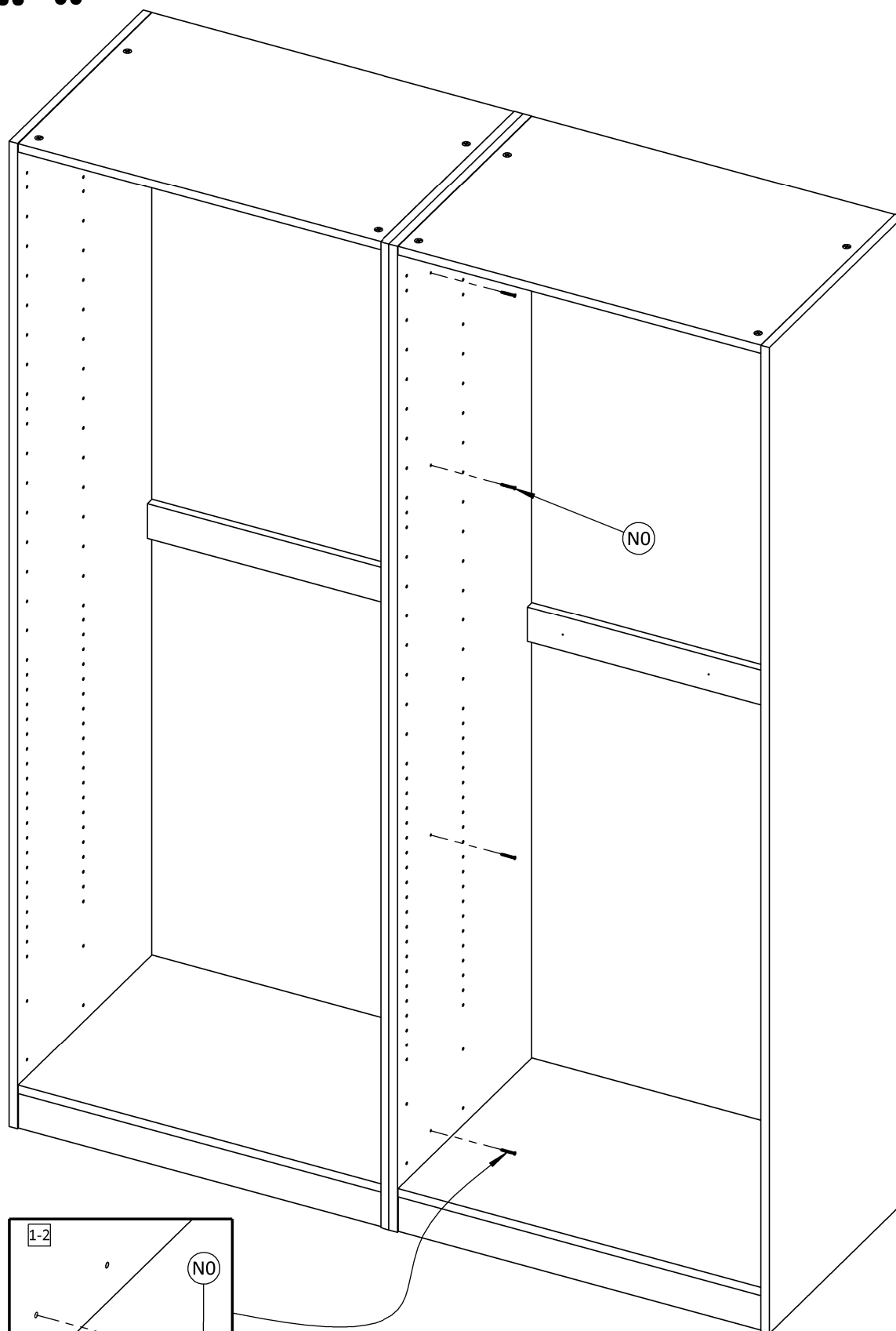
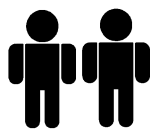

FIXING THE SHELVES INSIDE THE CABINET

ASSEMBLY INSTRUCTIONS

BOX 02

STEP 22

FIX THE SUPPORT ON THE SIDE PANNELS CLOSET

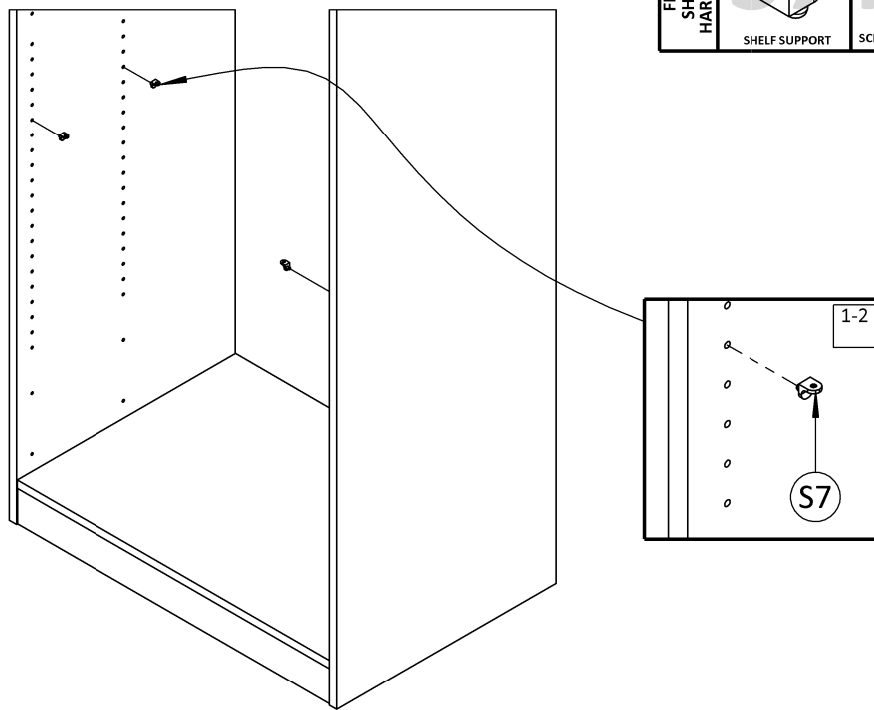
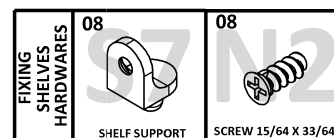

STEP 23

FIT THE SHELF ON THE CLOSET

SCREW THE SHELF
ON THE SUPPORT

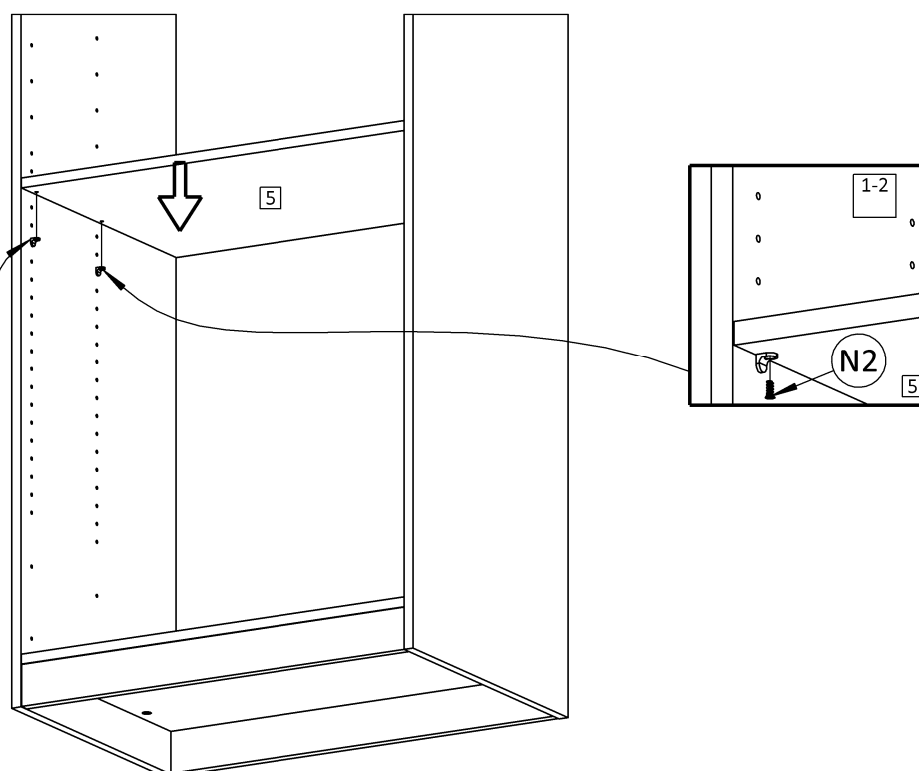

FIXING THE RODS INSIDE THE CABINET

PART NUMBER 6 - RODS

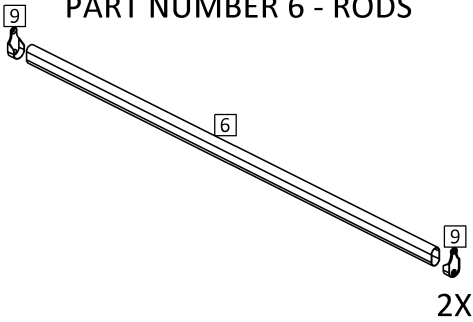

PART LIST		
PART NUMBER	QTY	DESCRIPTION
6	1	ROD
9	2	ROD SUPPORT

ASSEMBLY INSTRUCTIONS
BOX 02

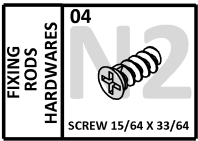

STEP 24
ROD SUPPORT FIXATION

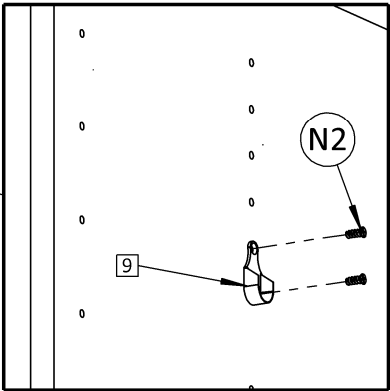
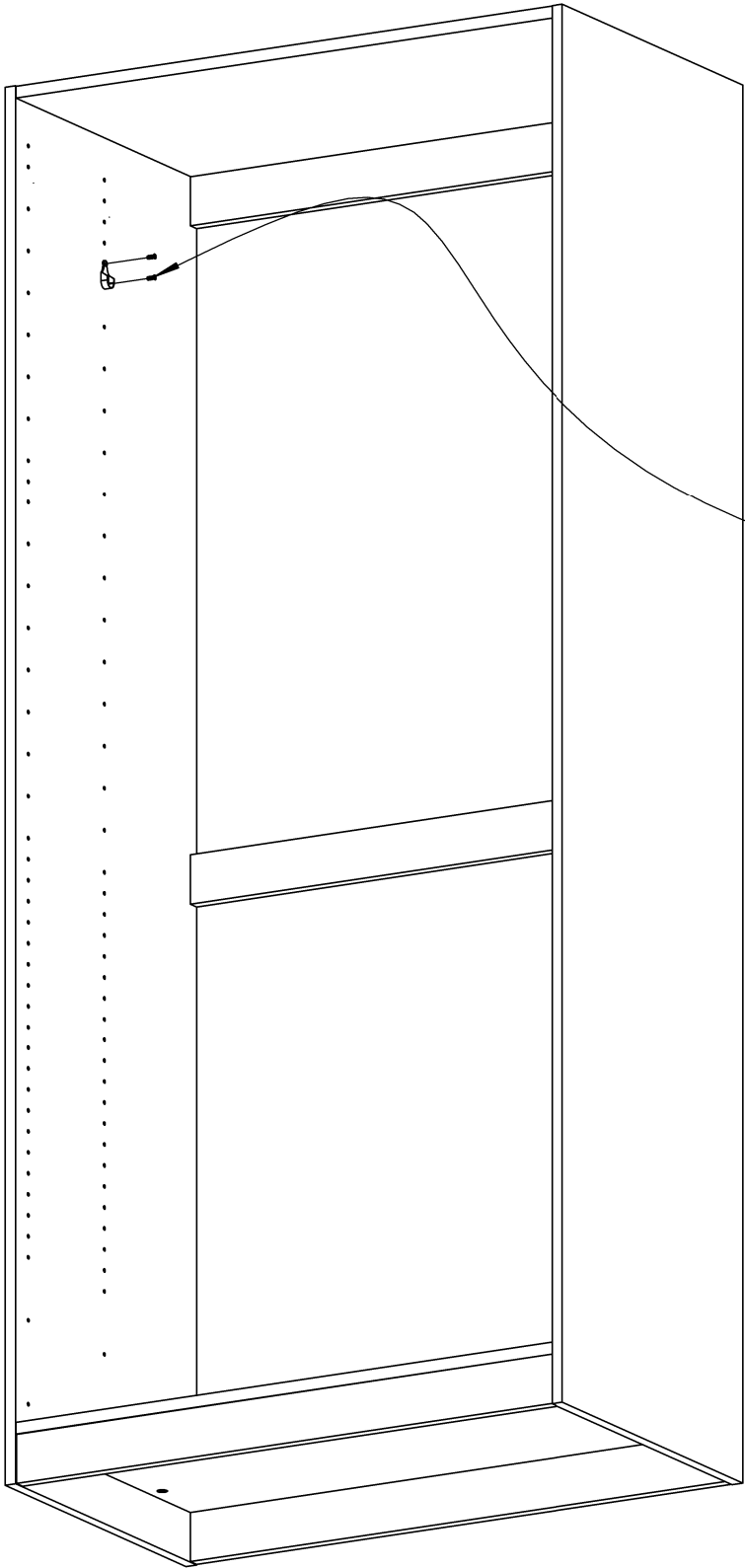

STEP 25
FIT ROD

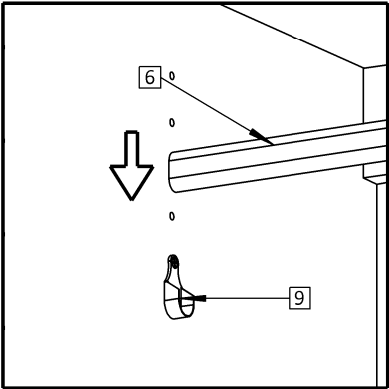

STEP 26
FIX THE SLIDERS ON THE CLOSET

ASSEMBLY INSTRUCTIONS
BOX 02

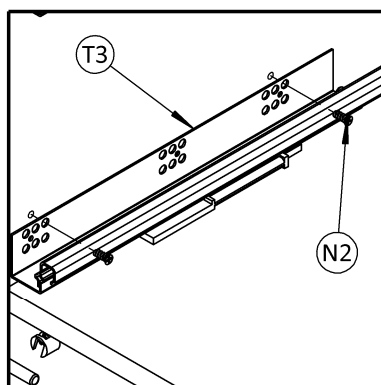
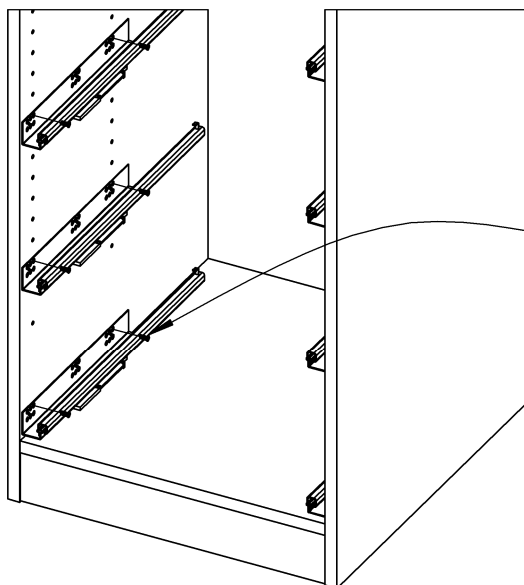

FIXING DRAWERS HARDWARES	03 (PAIR)	12
	SLIDER	SCREW 15/64 X 33/64

STEP 27
FIT THE DRAWERS ON THE SLIDERS

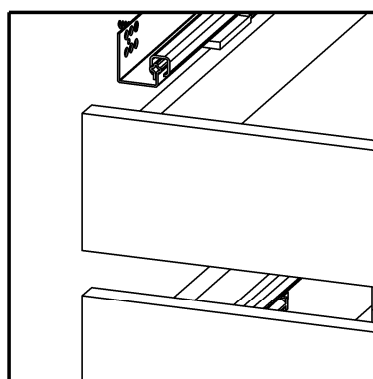

1,25" BETWEEN DRAWERS

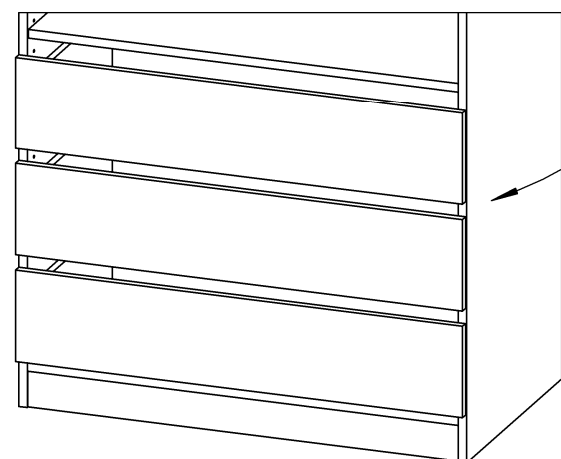

STEP 28
FIT THE PIN DRAWERS INTO THE SLIDER

