

### Features

- Acrylic
- 8 color-matched jets
- Pump with air switch and grounding-type plug-in cord
- Integral lumbar support
- Slotted overflow for maximum bathing depth
- Low threshold height
- Armrests
- 60" (152.4 cm) x 32" (81.3 cm) x 19" (48.3 cm)

### 5' (1.5 m) BATH WHIRLPOOL K-1122

ADA

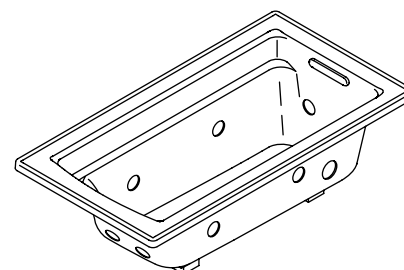

### Codes/Standards Applicable

Specified model meets or exceeds the following:

- ANSI Z124.1.2
- IAPMO/UPC
- Underwriters Laboratories (UL)
- ASME A112.19.7M
- ADA

### Colors/Finishes

- 0: White
- Other: Refer to Price Book for additional colors/finishes

### Accessories

- CP: Polished Chrome
- Other: Refer to Price Book for additional colors/finishes

### Specified Model

Model	Description	Colors/Finishes	
K-1122	Drop-in rim style bath whirlpool	<input type="checkbox"/> 0	<input type="checkbox"/> Other_____
<b>Required Accessories</b>			
K-7272	Bath drain – above or through-the-floor installation	<input type="checkbox"/> CP	<input type="checkbox"/> Other_____

### Product Specification

The acrylic bath whirlpool shall be 60" (152.4 cm) in length, 32" (81.3 cm) in width, and 19" (48.3 cm) in height. Bath whirlpool shall feature 8 color-matched jets and armrests. Bath whirlpool shall feature a pump with air switch and grounding-type plug-in cord. Bath whirlpool shall have slotted overflow for maximum bathing depth, low threshold height, and integral lumbar support. Bath shall have armrests. Bath whirlpool shall be Kohler Model K-1122-\_\_\_\_\_.

# ARCHER™

## Technical Information

Fixture*:	
Bathing well	
Basin area, bottom	45-1/8" (114.6 cm) x 19-11/16" (50 cm)
Basin area, top	52-3/4" (134 cm) x 25-5/16" (64.3 cm)
Weight	110 lbs (50 kg)
To overflow	
Water depth	15" (38.1 cm)
Capacity	58 gal (219.5 L)
* Approximate measurements for comparison only.	

Drop-in cutout dimensions:	
58-1/2" (148.6 cm) x 30-1/2" (77.5 cm)	

Pump:	V	Hz	A
1-speed	120	60	7
Pump is supplied with 24" (61 cm) grounding-type plug-in cord.			

Minimum access panel pump/control:	
20" (50.8 cm) W x 15" (38.1 cm) H	required

## Required Electrical Service

Dedicated circuit required, protected with a Class A Ground-Fault Circuit-Interrupter (GFCI):

Pump/control 120 V, 15 A, 60 Hz

Locate the outlet behind the whirlpool and within 24" (61 cm) of the pump.

## Installation Notes

Install this product according to the installation guide.

Floor support under this product must provide for a minimum of 47 lbs/square foot (230 kg/square meter) loading.

This product is designed for drop-in installation only. It is not suited for use in a three-wall alcove with an overhead shower.

The hot water supply should be 70% of the capacity of the bath or greater. Installations will vary.

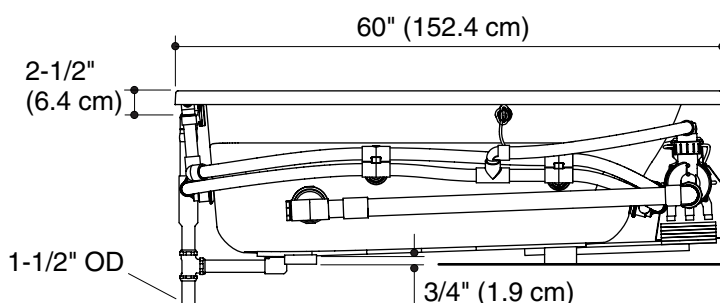
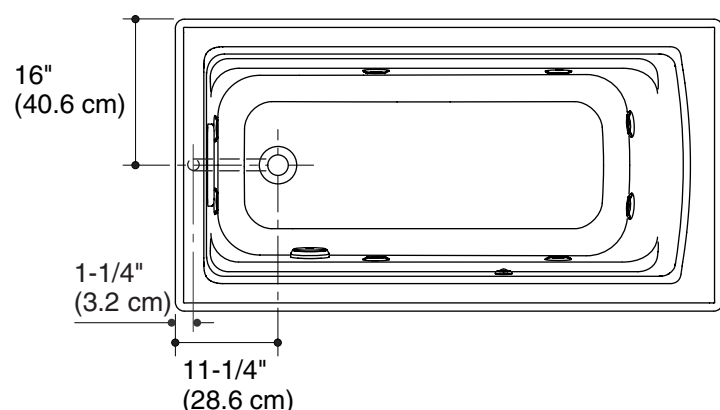

No change in measurements if connected with drain illustrated. (K-7272)

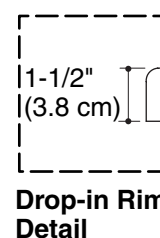

Pump/Control Access

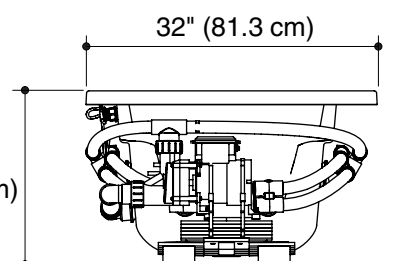

## Product Diagram