

OPERATING INSTRUCTIONS

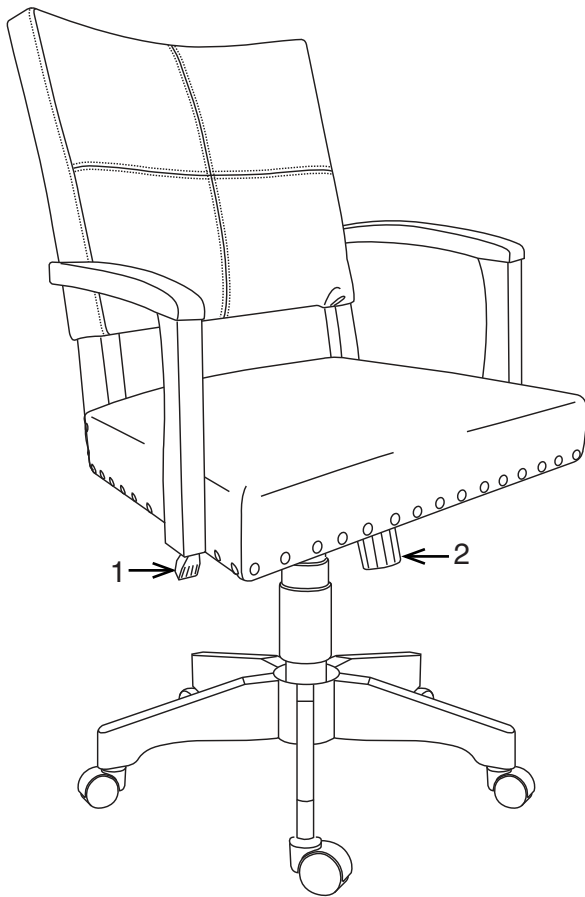

FEATURES

• HEIGHT ADJUSTMENT

To raise seat remove pressure from seat and lift lever (1). To lower seat height sit on chair and lift lever (1).

• LOCKING TILT ADJUSTMENT

For individual comfort, this chair has been equipped with an adjustment that will allow the user to change the tension of the tilting feature. Turn knob (2) clockwise to increase tension and counter-clockwise to decrease or ease the tension. To lock return chair to the upright position and push lever (1) in. To unlock pull lever (1) out.

NOTE: Be careful not to loosen back tilt adjustment knob completely.

WARNING

1. Do not use this product unless all screws and bolts are securely tightened.
2. Check that all screws and bolts are tight every three months or as needed.
3. Dispose of packing material properly. Do not use plastic cover as head covering. It may cause suffocation.
4. Do not use this product as a stepladder.
5. Use this product for its intended purpose only.
6. FOR INDOOR RESIDENTIAL USE ONLY.

LIMITED WARRANTY

warrants to the original purchaser that this product will be free from defects in material and workmanship as described below. will repair or replace, at its option, without charge to the original purchaser only, defective products or parts for one (1) year from the date of purchase. Replacement parts can only be supplied if parts are available. Items out of production may be unavailable. This warranty shall be effective for the applicable time period beginning from the date of purchase as shown on your original sales receipt. This warranty is your sole remedy for product defects and excludes defects due to or arising in connection with product abuse or misuse, use modification of, or attachments to the product, and products or parts not used, maintained, or installed in accordance with the company's installation, maintenance and/or applicable guidelines. There are no other warranties, express or implied, other than those specifically described, including without limitation any implied warranty of merchantability or of fitness for a particular purpose. will not be responsible for incidental or consequential damages. Some states do not allow the exclusion or limitation of incidental or consequential damages, so the above limitations or exclusions may not apply to you. This warranty gives you specific legal rights and you may also have other rights which may vary from state to state. Our quality standards are among the highest in the industry. Sometimes, no matter how hard we try, there are times when parts are damaged or missing. To make a warranty claim, contact Parts Department. Provide model number, proof of purchase, description of the problem and obtain return authorization. At its option will: (a) Supply compatible components of current manufacture. (b) Repair the customer's component. The customer must prepay freight on any components returned to the factory. Return freight on components still in warranty will be paid

ASSEMBLY INSTRUCTIONS

STEP 1

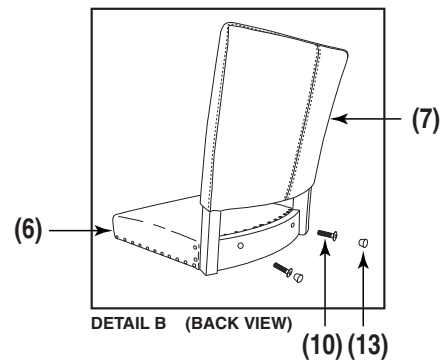
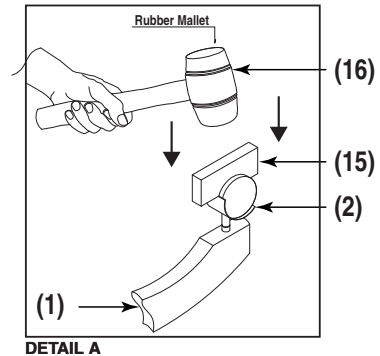
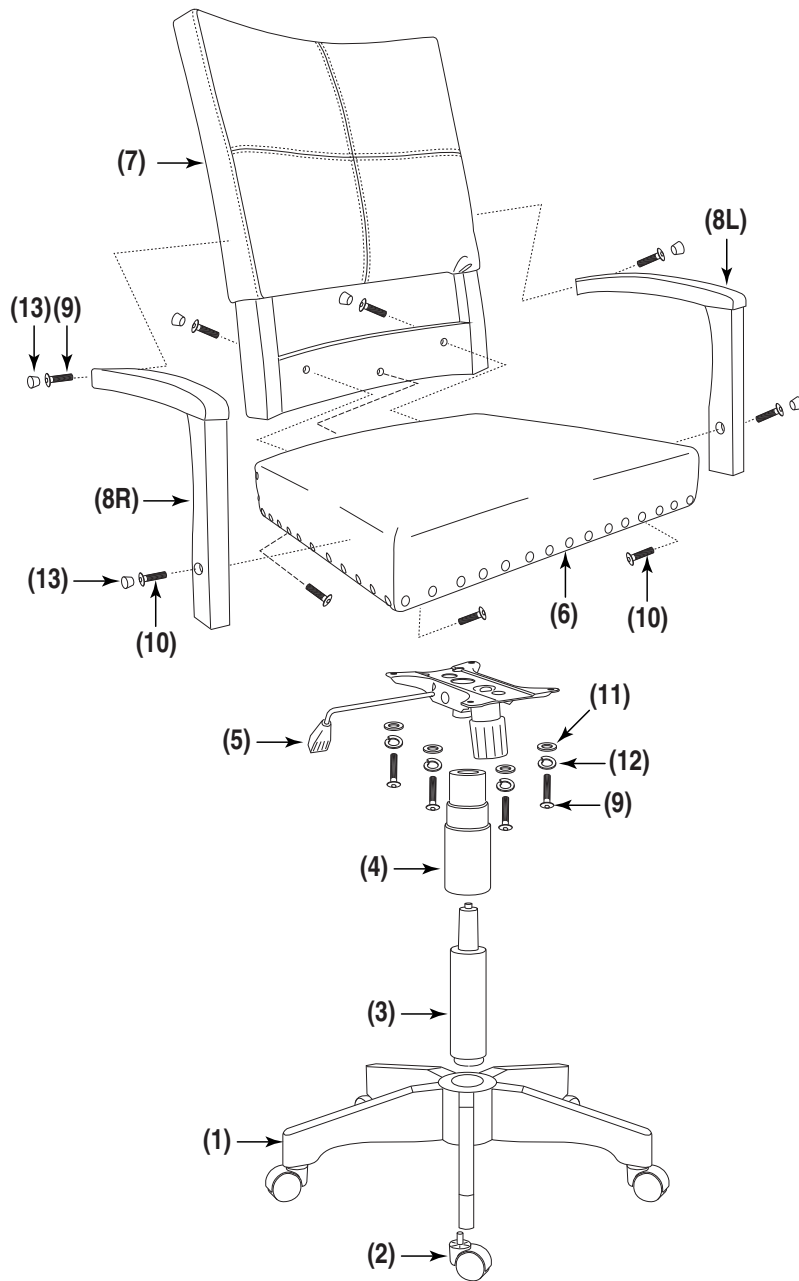

PART	QTY
1. Base	1
2. Caster	5
3. Pneumatic Cylinder	1
4. Bellows	1
5. Seat Plate	1
6. Seat	1
7. Back	1
8. Arms (8L & 8R)	2
9. Short Bolt	6
10. Long Bolt	7
11. Flat Washers	4
12. Lock Washers	4
13. Wood Caps	6
14. Allen Wrench (not shown)	1
15. Wooden Cleat	1
16. Rubber Mallet (not provided)	1

Remove all parts from carton, separate them by part numbers indicated on the parts list, and verify parts quantities.

STEP 1 Align and attach Back (7) to Seat (6) using two Long Bolts (10). **SEE DETAIL B. FULLY TIGHTEN ALL BOLTS USING ALLEN WRENCH (14).** Cover holes in Back (7) using two Wood Caps (13).

STEP 2 Attach Seat Plate (5) to Seat (6), with arrow pointing towards the front of the chair, using four Short Bolts (9), four Lock Washers (12) and four Flat Washers (11). **FULLY TIGHTEN ALL BOLTS USING ALLEN WRENCH (14).**

STEP 3 Align the holes in Arms (8L and 8R) with the holes in the Back (7) and Seat (6), secure Arms (8L & 8R) to Seat (6) using one Long Bolt (10) for each Arm (8). Secure Arms (8L & 8R) to Back (7) using one Short Bolt (9) for each Arm (8). **FULLY TIGHTEN ALL BOLTS USING ALLEN WRENCH (14).** Cover holes in Arms (8L & 8R) using two Wood Caps (13) for each Arm (8).

STEP 4 Insert five Casters (2) into Base (1), push hard until you feel or hear the Caster (2) snap into place. Use Wooden Cleat (15) and Rubber Mallet (16) for easy installation. **SEE DETAIL A.** Place Base (1) upright so Casters (2) are on the floor, insert Pneumatic Cylinder (3) into Base (1) and slip Bellows (4) over Pneumatic Cylinder (3), Place Assembled seat onto Pneumatic Cylinder (3) and apply downward pressure.

ATTENTION : VERIFY THAT ALL BOLTS ARE FULLY TIGHTENED BEFORE USING CHAIR.