

ASSEMBLY INSTRUCTIONS

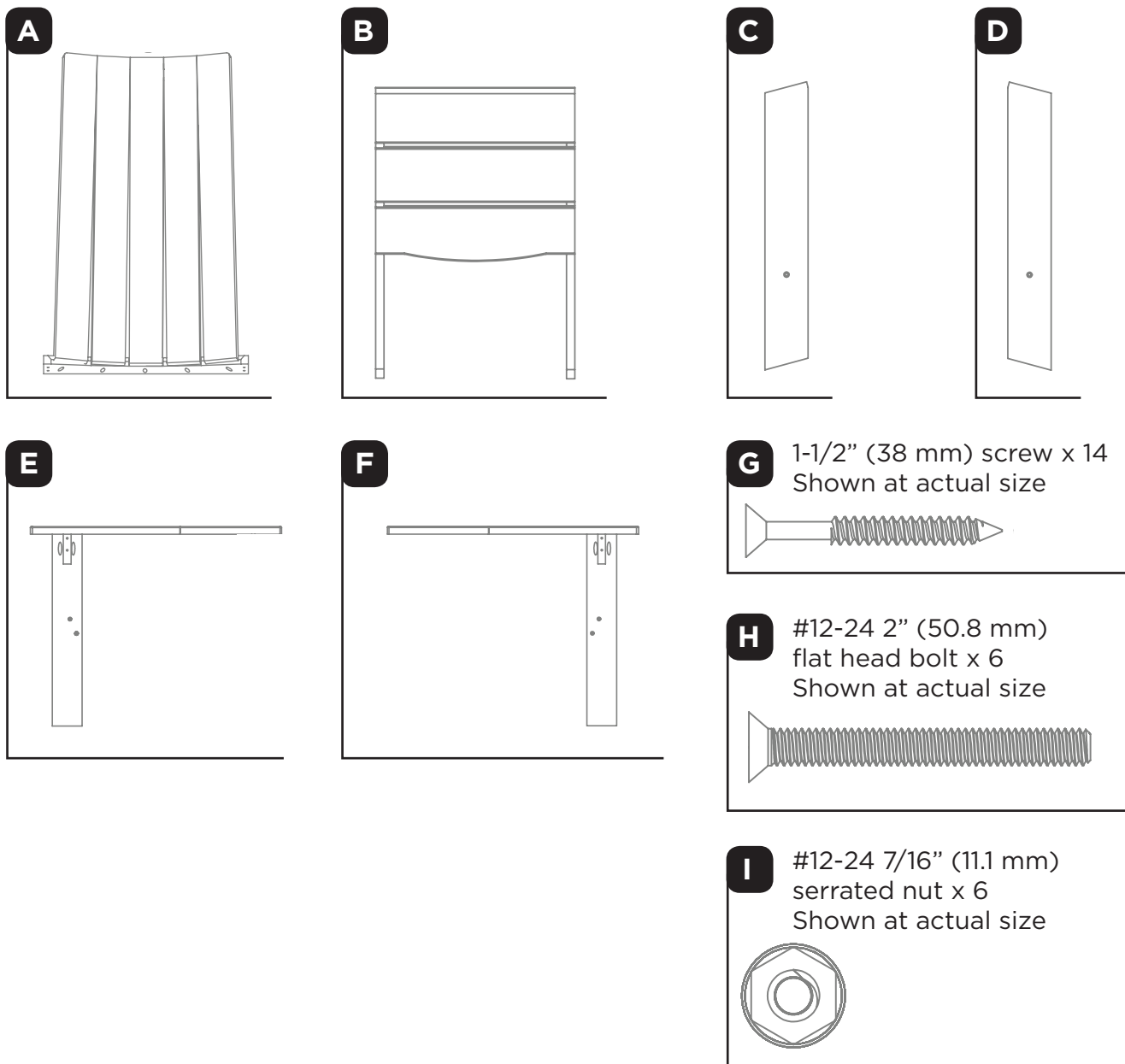

IMPORTANT: Please read this manual carefully before beginning assembly of this product. Keep this manual for future reference. Visit our website for an assembly instruction video.

*Made from 95% post-consumer recycled plastic bottle caps



Needed for assembly:

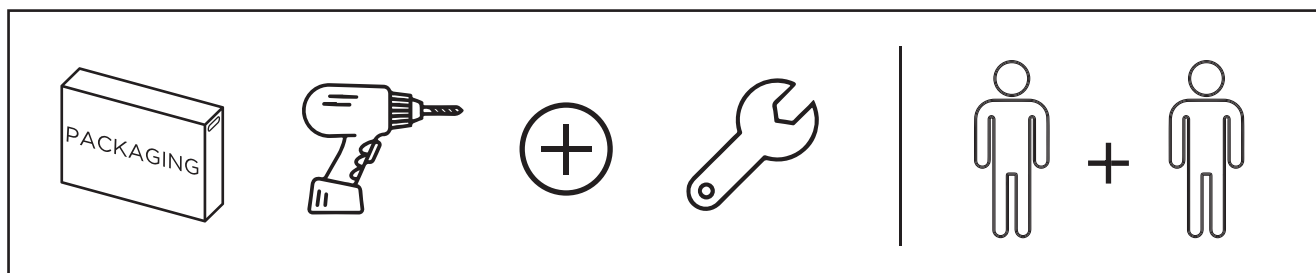

IMPORTANT: Please read and understand the manual before any assembly. Before beginning assembly of product, make sure all parts are present. Compare parts with packaging contents list. If any part is missing, or if you have any questions, contact our service center. Remove all parts from the box in the cleared area and position them on the floor in front of you. Do not dispose of the packing materials until assembly is complete.

Step 1

Requires **B** - SEAT, **C** - LEFT LEG, **D** - RIGHT LEG, **H**, **I**.

Attach piece **D** to seat **B** with bolt **H** and nut **I**. Tighten bolt 95%, then fully tighten at step 7. Make sure the edge of **D** is flush with **B**. Repeat for other side with piece **C**.

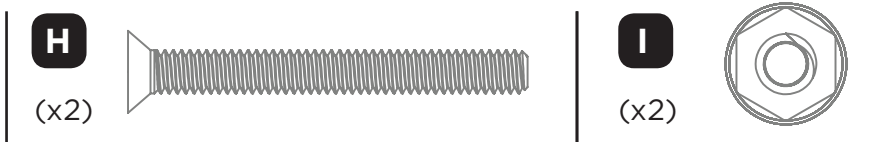

Shown at actual size

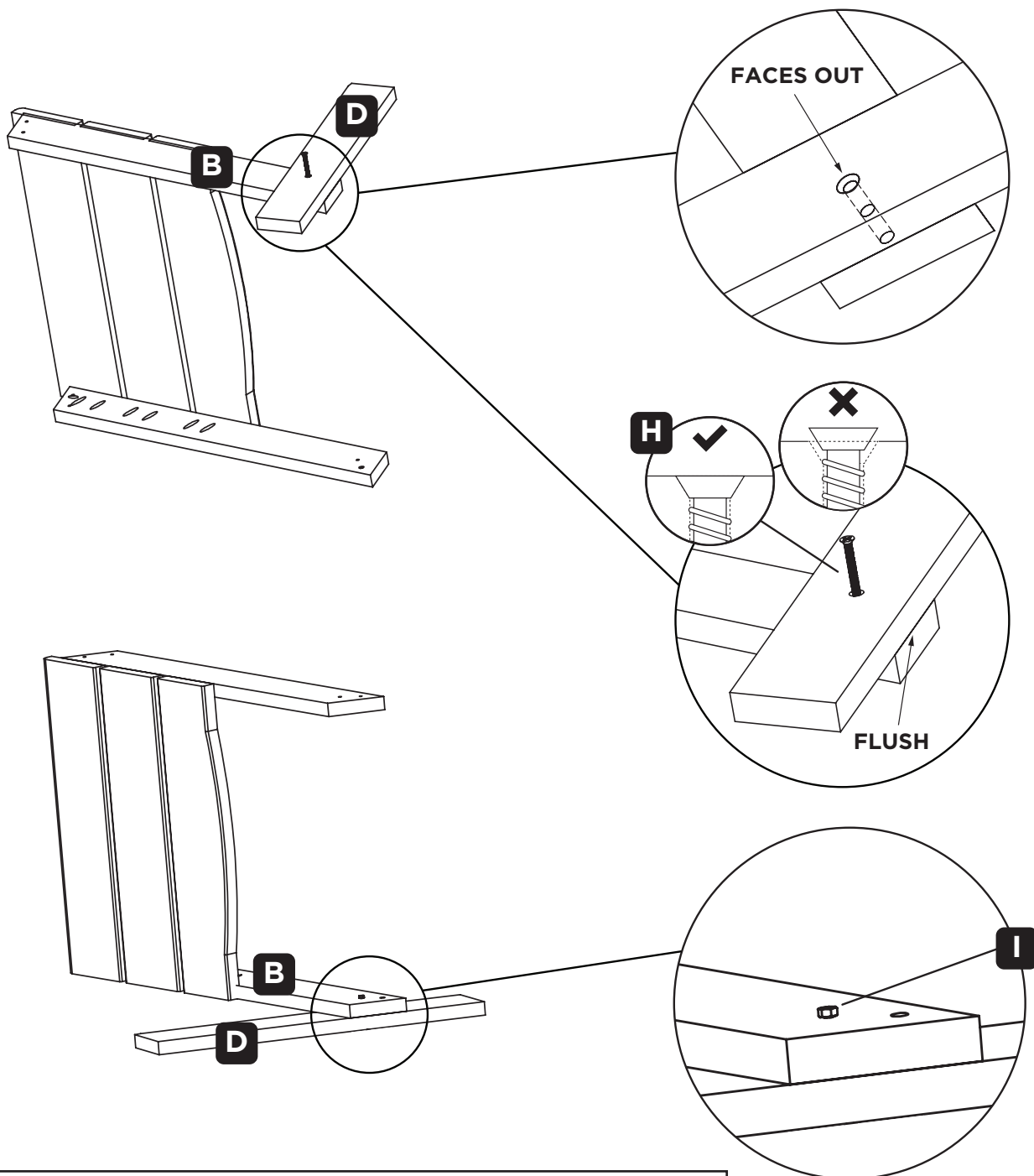

REPEAT FOR OTHER SIDE WITH PIECE C.

Step 2

Requires A - BACK, G.

Place assembled seat of chair on box for ease of assembly. Attach piece **A** to piece **B** using **G** screws, lining up with front pre-drilled holes.

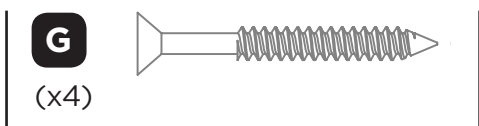

Shown at actual size

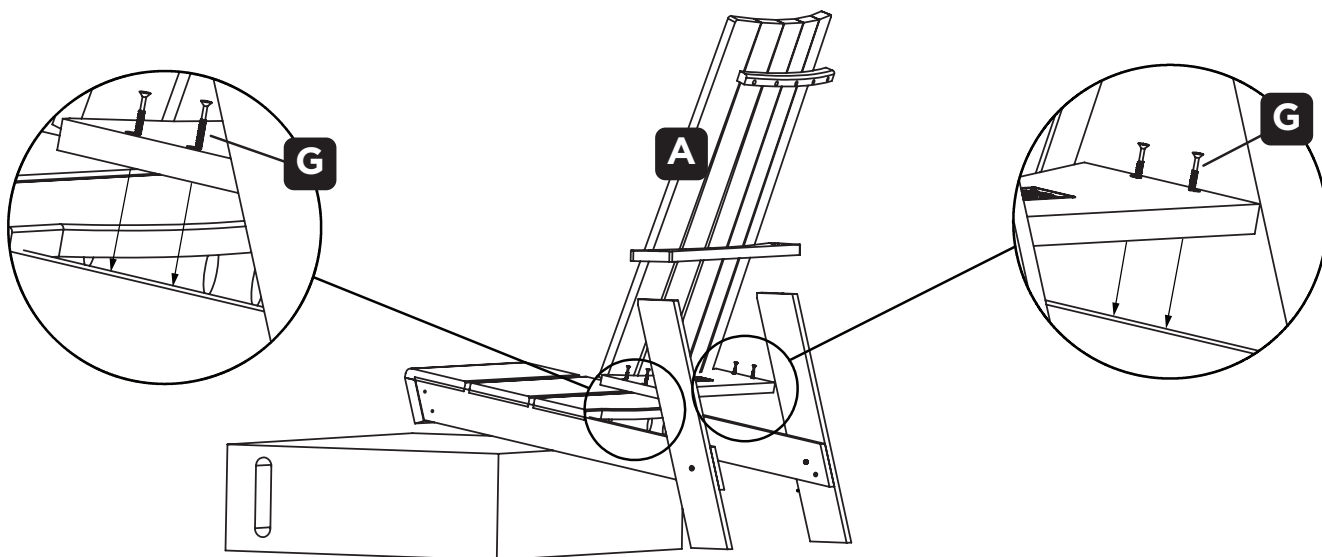

Step 3

Requires G.

Attach piece **A** to piece **C** and **D** using **G** screws.

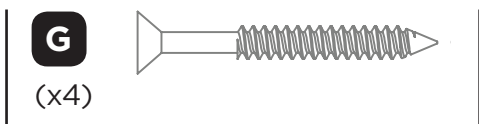

Shown at actual size

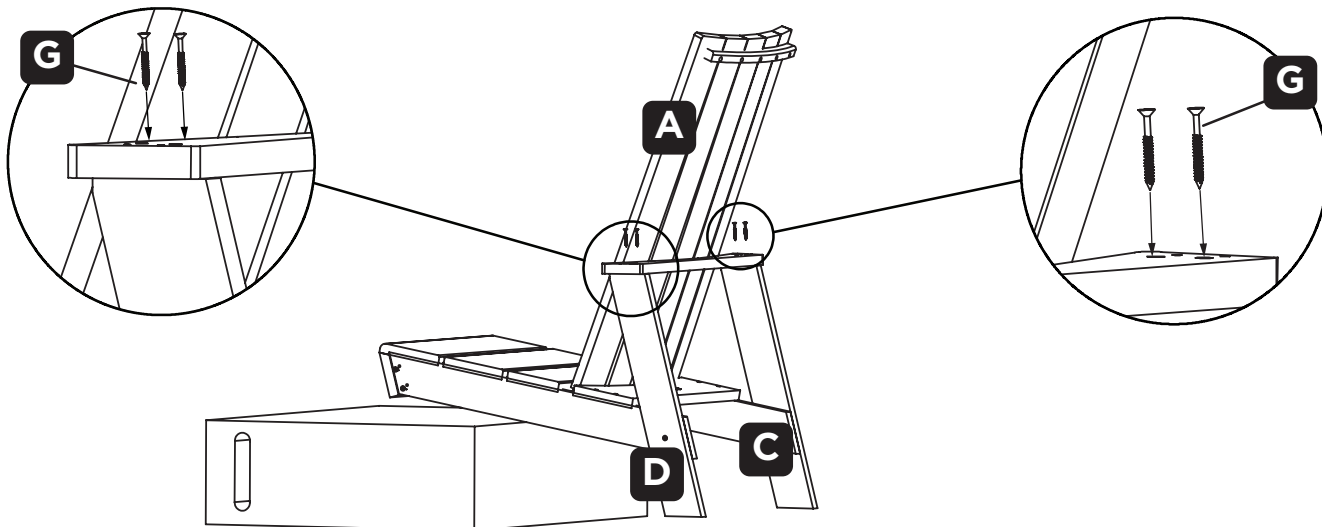

Step 4

Requires E - LEFT ARM, F - RIGHT ARM, H, I.

Attach piece **E** to piece **B** with bolts **H** and nuts **I**. Repeat for other side with piece **F**.

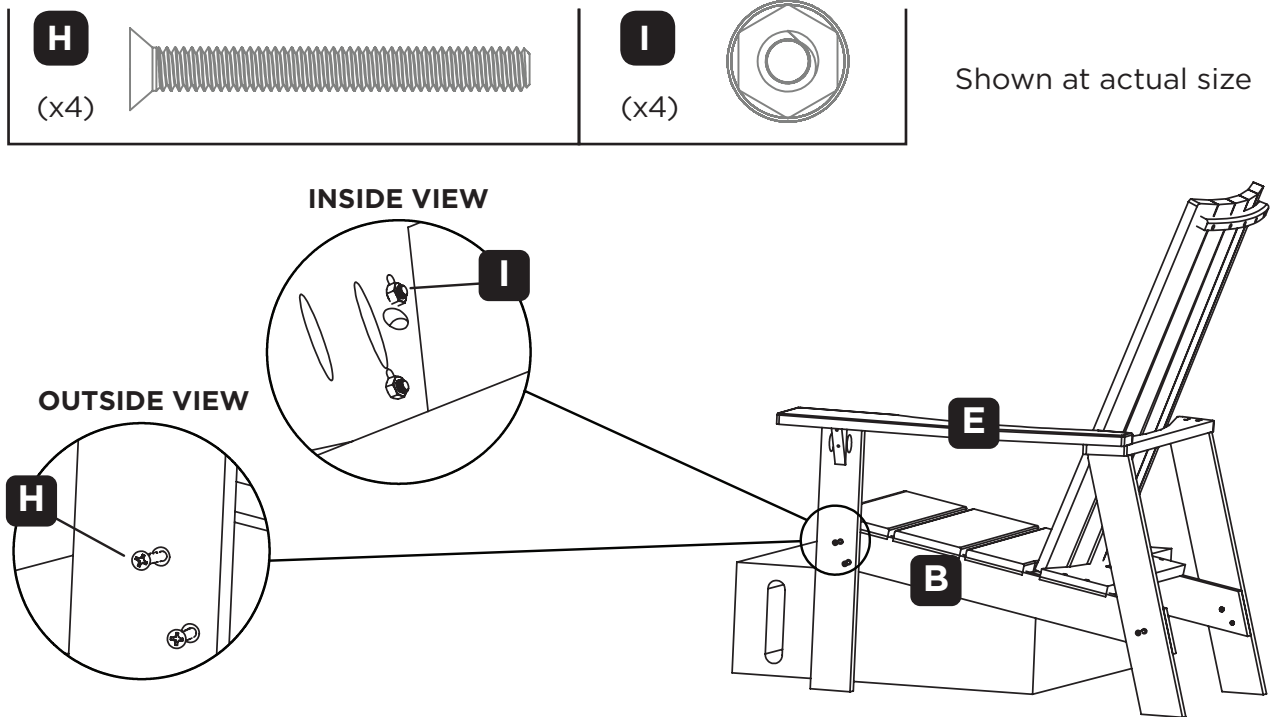

REPEAT FOR OTHER SIDE WITH PIECE F.

Step 5

Requires G.

Attach pieces **E** and **F** to piece **A** using **G** screws.

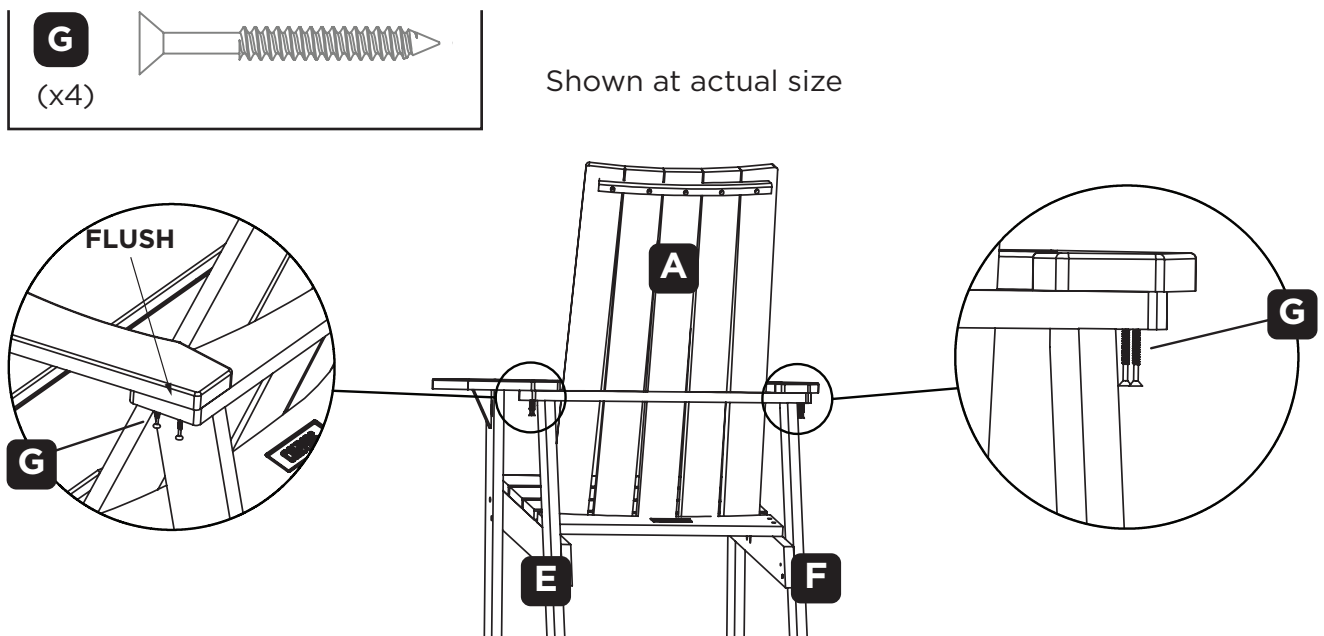

Step 6

Requires G.

Secure piece **D** to piece **B** using **G** screw. Make sure edge of **D** is flush with **B**. Repeat for other side with piece **C**, making sure edge of **C** is flush with **B**.

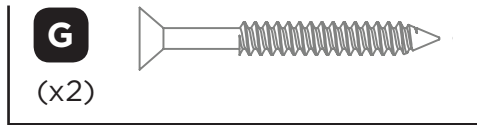

Shown at actual size

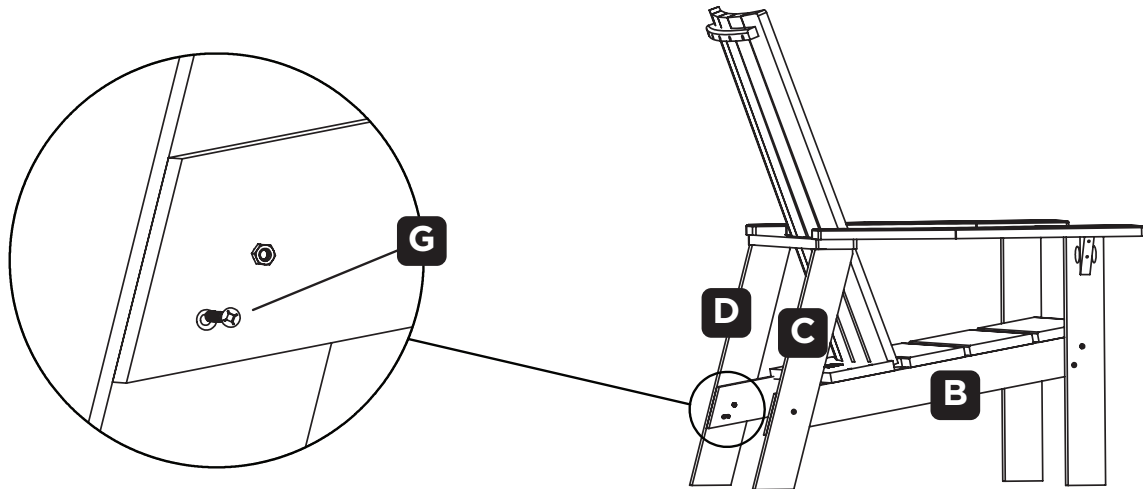

REPEAT FOR OTHER SIDE WITH PIECE C.

Step 7

Make sure that the nuts and bolts are all properly tightened on both sides.

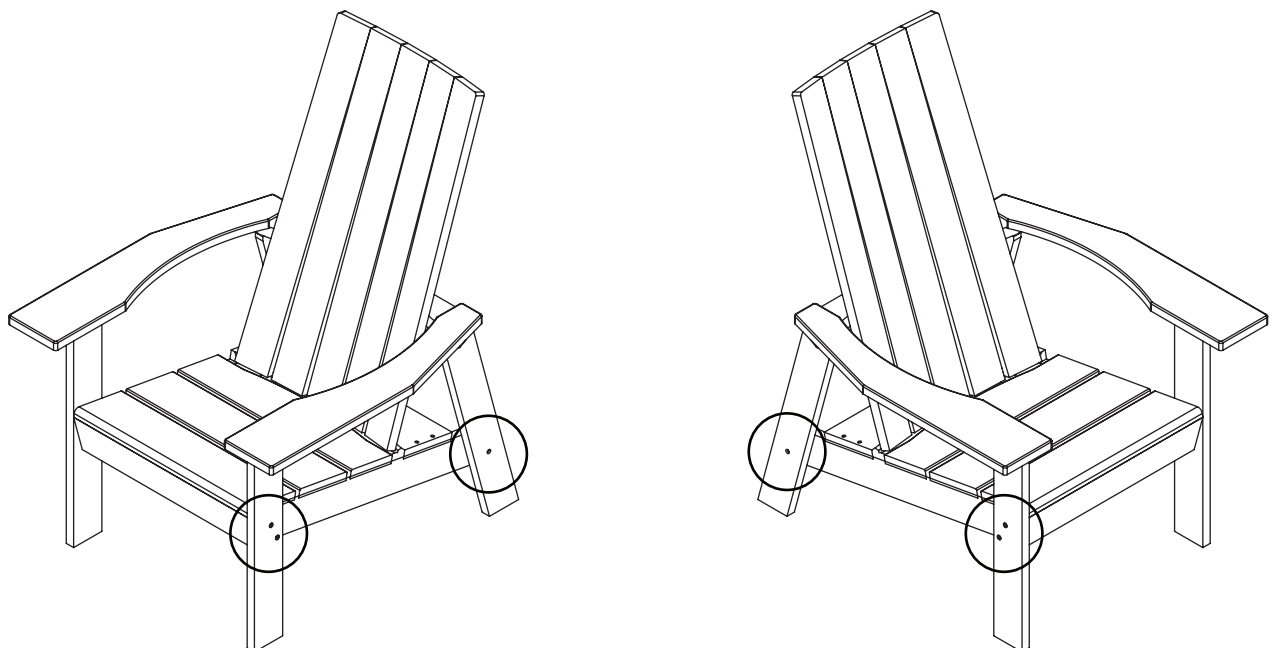

WARRANTY

This product carries a ten (10) year warranty against defects in workmanship. See Full Warranty Guide for more details. This product is not guaranteed against wear or breakage due to misuse and/or abuse.

MAINTENANCE

Clean with soapy water and sponge. Do not pressure wash.

TECHNICAL DATA

Dimensions (L x W x H)	89 x 79 x 102
	35" x 31" x 40"
Product weight	22 kg
	48 lb

CAUTION: DO NOT EXCEED MAXIMUM WEIGHT CAPACITY OF 300 LB (126 KG).