

## One-Piece toilet # 2157010005 / 2157010085

|< 14 5/8" Inch >|

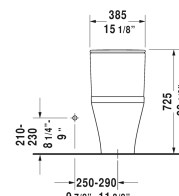
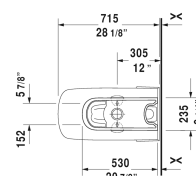
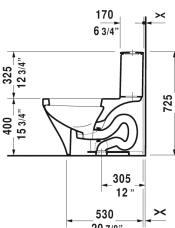
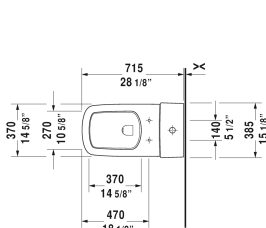

| One-Piece toilet   | Dimension              | Weight   | Order number |
|--|------------------------|----------|--------------|
| US-version toilet, syphonic, 12" rough-in, vertical outlet, cUPC listed  |                        |          |              |
|  |                        |          |              |
| <b>Colors</b>  |                        |          |              |
| 00 White   |                        |          |              |
|  |                        |          |              |
| <b>Variant</b>   |                        |          |              |
| ◆ 1.32/0.92 gpf, with dual flush piston valve, top flush   | 14 5/8" x 28 3/8" Inch | 121.3 lb | 2157010005   |
| ◆ 1.28 gpf, with Single Flush piston valve, top flush  | 14 5/8" x 28 3/8" Inch | 121.3 lb | 2157010085   |
|  |                        |          |              |
| Sanitary ceramics with the special WonderGliss surface finish will remain clean and attractive-looking for a long time to come.<br>When ordering WonderGliss please add a "1" as eleventh digit to the model number. |                        |          |              |
|  |                        |          |              |
| Toilet seat and cover removable, elongated, hinges stainless steel, without slow close   |                        | 5.7 lb   | 006051       |
| Toilet seat and cover removable, elongated, hinges stainless steel, with slow close  |                        | 5.7 lb   | 006059       |
| Mounting set for One-piece and Two-piece toilets, 1/2", US-version   |                        | 1.1 lb   | 001417       |
|  |                        |          |              |
| <b>Suitable products</b>   |                        |          |              |
| Toilet seat and cover removable, elongated, hinges stainless steel, without slow close,  |                        |          | 006051       |
| Toilet seat and cover removable, elongated, hinges stainless steel, with slow close,   |                        |          | 006059       |

All drawings contain the necessary measurements which are subject to standard tolerances. They are stated in inch & mm and are non-binding. Exact measurements, in particular for customized installation scenarios, can only be taken from the finished ceramic piece.