

WATER SUPPLY LINE INSTALLATION GUIDE

Note:

Use Teflon tape on all threaded connections
Measure twice cut once.

- A. Set adapter (1), washer (2) and locknut (3) through the tub with coupler.
(Note: These parts are faucet water inlets, not include with this supply kit)
- B. Take the supply tube (5) and put washer (4) onto the upper end of the tube.
- C. Slide the decorative nut (6) up to the top of the supply tube and over the washer.
- D. Slide the escutcheon (7) up the tube slightly, then, directly under the escutcheon, slide the locknut (8) up to the end of the tube.
- E. Take the washer (9) and put it, with the wide end of the washer upward, onto the bottom end of tube.
- F. Take the supply tube and attach the bottom end of it to the water supply tubing in your floor by screwing the locknut down tightly. Set the escutcheon to the floor.
- G. Take the upper end of the supply tube and attach it to adapter. Tighten the decorative locknut.

TOOLS AND MATERIALS

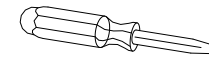

Screwdriver

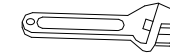

Adjustable Wrench



Teflon Tape

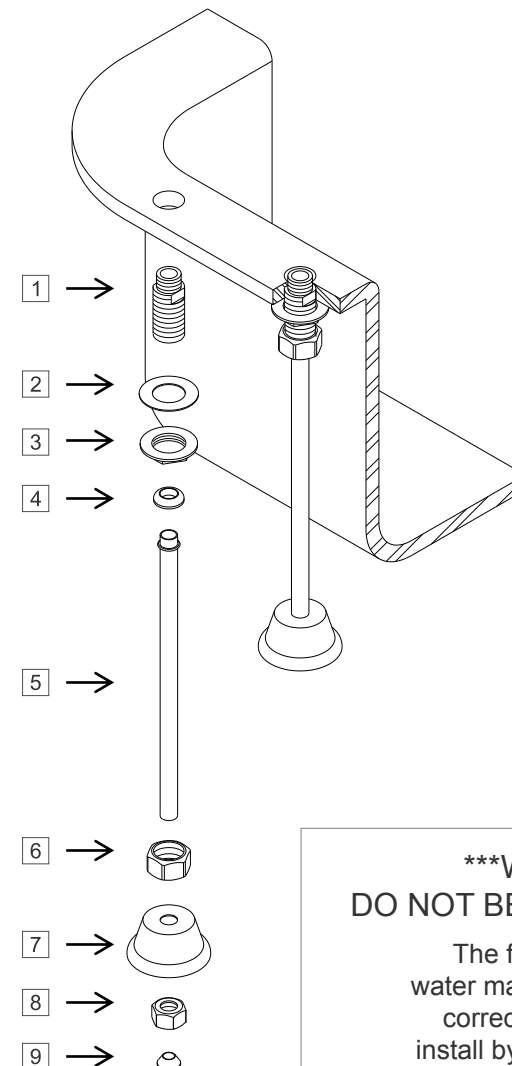

WARNING

DO NOT BEND BRASS TUBES

The faucet holes and water main must be lined up correctly. Attempting to install by bending the tubes may cause crack or leaks