

### Features

- *ExoCrylic™*
- *Oval shape*
- *Drop-in installation*
- *Molded lumbar support and armrests for comfort*
- *Optional K-1491 removable bath pillow*
- *Optional K-1601 removable footstop*
- *60" (1524 mm) x 42" (1067 mm) x 20" (508 mm)*

### Codes/Standards Applicable

Specified model meets or exceeds the following:

- *CSA B45.5/IAPMO Z124*

## BATH K-1163-S1

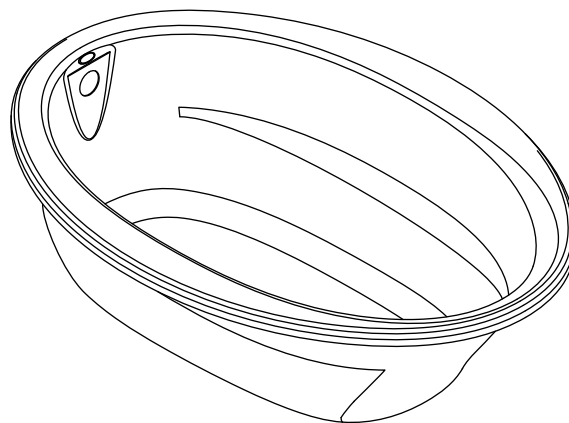

### Colors/Finishes

- 0: White
- Other: Refer to Price Book for additional colors/finishes

### Accessories

- 0: White
- CP: Polished Chrome
- NA: None applicable
- Other: Refer to Price Book for additional colors/finishes

### Specified Model

Model	Description	Colors/Finishes	
K-1163-S1	Bath	<input type="checkbox"/> 0	<input type="checkbox"/> Other_____
<b>Recommended Accessories</b>			
K-11677	Swiftflo™ adjustable trip lever drain	<input type="checkbox"/> CP	<input type="checkbox"/> Other_____
<b>Optional Accessories</b>			
K-576	Undermount kit		<input type="checkbox"/> NA
K-1491	Removable bath pillow	<input type="checkbox"/> 0	<input type="checkbox"/> Other_____
K-1601	Removable footstop	<input type="checkbox"/> 0	<input type="checkbox"/> Other_____

### Product Specification

The ExoCrylic bath shall be 60" (1524 mm) in length, 42" (1067 mm) in width, and 20" (508 mm) in height. Bath shall be oval shaped and for drop-in installation. Bath shall have molded lumbar support and armrests. Bath shall feature optional K-1491 removable bath pillow and K-1601 removable footstop. Bath shall be Kohler Model K-1163-S1-\_\_\_\_\_.

## Technical Information

Fixture*:	
Bathing well:	
Basin area, bottom	43" (1092 mm) x 21-9/16" (548 mm)
Basin area, top	53-1/2" (1359 mm) x 32-1/8" (816 mm)
Weight	75 lbs (34 kg)
To overflow:	
Water depth	15" (381 mm)
Capacity	57 gal (215.9 L)
* Approximate measurements for comparison only.	
Included components:	
Cutout template	1042556-7

## Installation Notes

Install this product according to the installation guide.

Floor support under bath must provide for a minimum of 33 lbs/square foot (161 kg/square meter) loading.

No change in measurements if connected with drain illustrated.

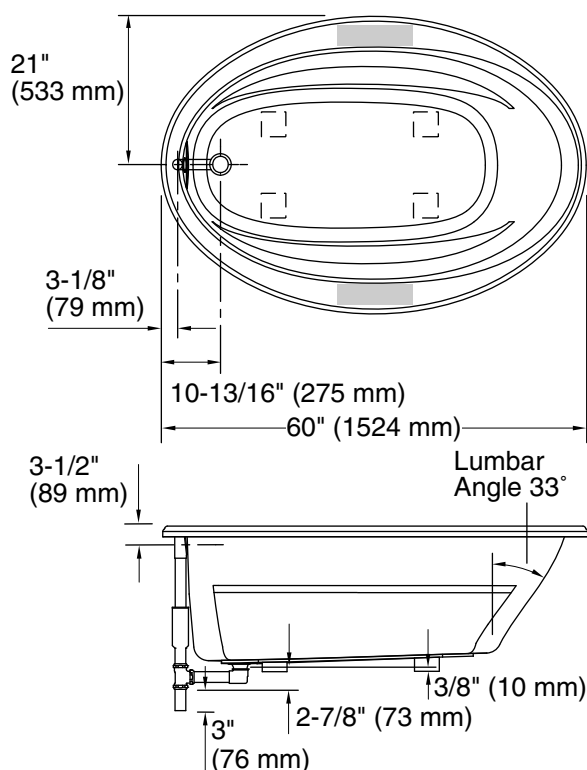

No change in measurements if connected with drain illustrated. (K-11677)

Recommended faucet area

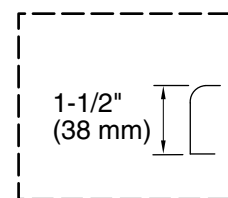

Drop-In Rim Detail

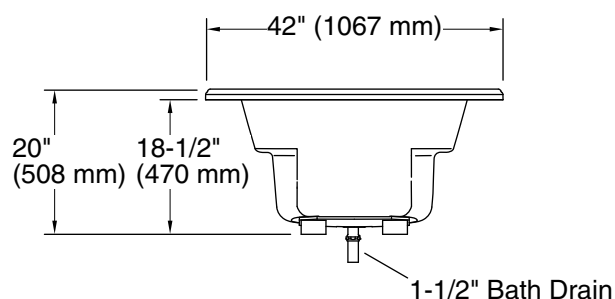

## Product Diagram