

# ASSEMBLY INSTRUCTIONS

## TOOLS REQUIRED:

Allen Wrench (supplied, part # K, # M)  
Spanner Wrench (supplied, part # L)

## BEFORE YOU START:

1. Check the parts against the parts list to make sure all items are present.
2. Assemble your furniture on a soft, flat surface to avoid scratching the finish.
3. **CAUTION:** Do not over tighten screws, nuts or bolts during assembly.
4. Your furniture may require occasional tightening.

## INSTRUCTIONS:

1. Place the Chair Back facing upward on a soft and flat surface. Attach chair seat to the chair back, using Flat Washer (E), Lock Washer (D), Bolt (A) for center the insert and Bolts(B) for in the corners. Tighten with Wrench (K). (See Figure 1 & 2)
2. Attach the front leg to the front corner block of the chair seat, using Flat Washer (E), Lock Washer (D), Nuts (C) and tighten all nuts with Wrench (L). (See Figure 3)
3. Repeat the process for the other front leg.
4. Attach the left arm to the chair seat, using Flat washer (E), Lock washer (D) and Bolt (A) for chair seat. Tighten with Wrench (K). (See Figure 4)  
Important: Do not over-tighten.
5. Attach the left arm to the chair back, using Flat washer (H), Lock washer (G) and bolt (F). Tighten with Wrench (M). Cover the hole with wood plug (N) (See Figure 5)
6. Repeat the process for the Right arm.
7. Tighten all bolts and nuts before use.

No.	Hardware List	Q'ty
A	Bolt Ø5/16"x1-1/2"	3
B	Bolt Ø5/16"x3-1/2"	4
C	Hex Nut Ø5/16"	4
D	Lock Washer Ø5/16"	11
E	Flat Washer Ø5/16"	11
F	Bolt Ø1/4"x1-1/2"	2
G	Lock Washer Ø1/4"	2
H	Flat Washer Ø1/4"	2
K	Allen Wrench 5mm	1
L	Spanner Wrench 12mm	1
M	Allen Wrench 4mm	1
N	Wood plug	2

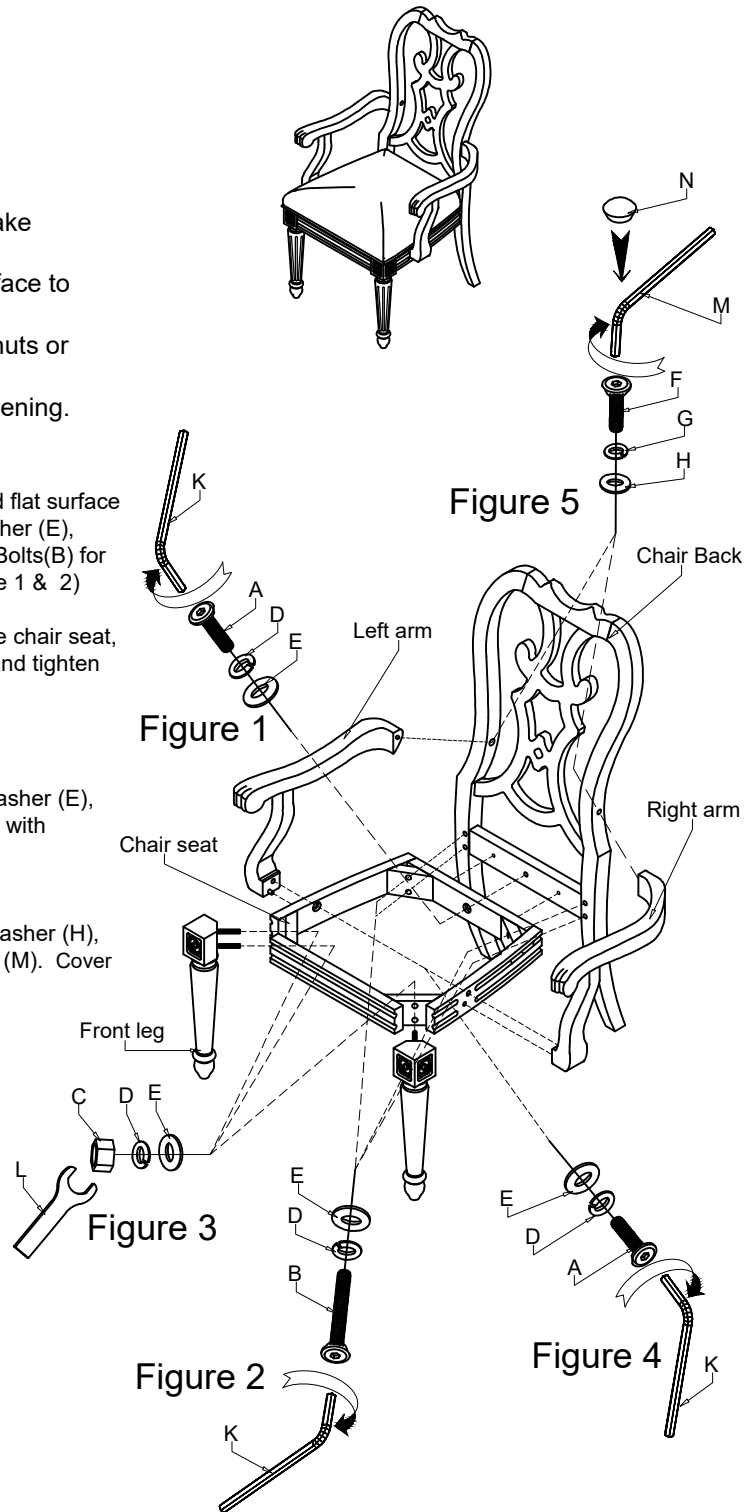

Thank you for purchasing furniture!