

DINING BENCH
ASSEMBLY INSTRUCTIONS



ASSEMBLY INSTRUCTIONS

ASSEMBLY TIPS :

1. Remove hardware from plastic bag and sort by size.
2. Please check to see that all hardware and part are present prior to start of assembly.
3. Please follow attached instruction in the same sequence as numbered to assure fast & easy assembly.



Warning !

1. Don't attempt to repair or modify parts that are broken or defective. Please contact the store immediately.
2. This product is for home use only and not intended for commercial establishment.



ASSEMBLY TIME

30 MINUTES

PARTS IDENTIFICATION:

A

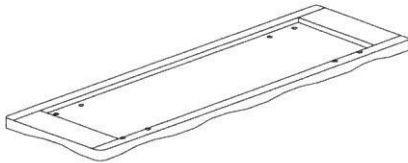

BENCH SEAT

1PC

B

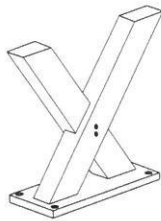

LEG

2PCS

C

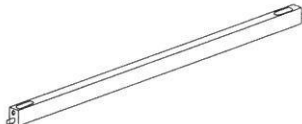

TRESTLE BAR

1PC

HARDWARE IDENTIFICATION:

1



ALLEN WRENCH

1PC

2

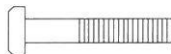

2PCS

3



SHORT BOLT

8PCS

4



LOCK WASHER

10PCS

5



FLAT WASHER

10PCS

ASSEMBLY INSTRUCTIONS

STEP 1

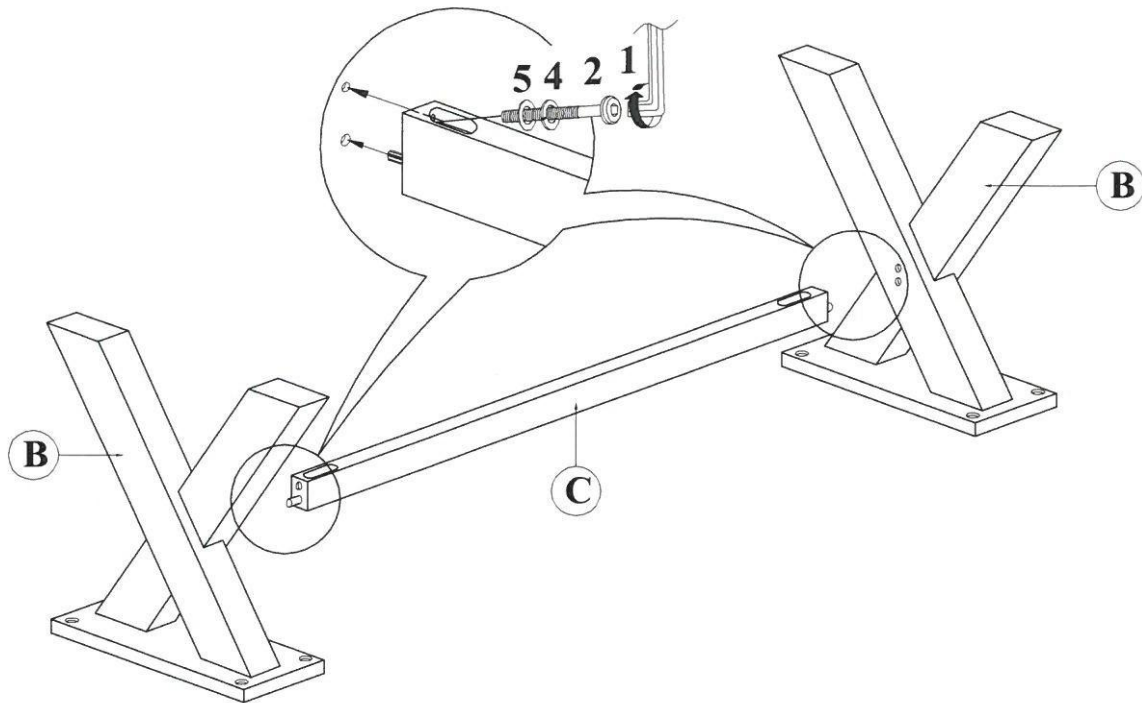

STEP 2

