

WALLPAPER

PEEL & STICK WALLPAPER INSTALLATION

Before you begin!

The DO's

- Apply on finished surfaces only (i.e. primed and painted walls).
- Apply to room temperature surfaces (~68 degrees F, or 20 degrees C).
- Wait at least two weeks before applying to newly painted walls.
- Wash and completely dry your hands before application.
- After applying each sheet, smooth over entire area with pressure, **paying special attention to the edges.**

The DON'Ts

- Do not apply to unfinished surfaces (i.e. bare concrete).
- Do not apply to cold surfaces.
- Do not apply to freshly painted walls (please wait at least two weeks).
- Do not use a squeegee (or anything else besides your hands!) to apply wallpaper.

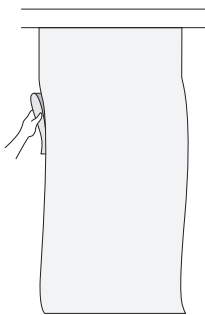

Step 1.

Remove about 12 inches of the backing from the first sheet of wallpaper. Apply from the top of the wall or desired area first.

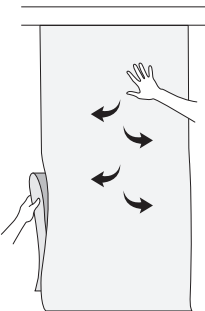

Step 2.

Using your hands, smooth the section of wallpaper from top down and from center outwards (see diagram). Remove the remaining backing as you go down. Use your hands to remove any trapped air bubbles before applying the next sheet.

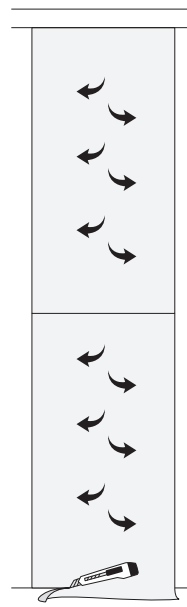

Step 3.

Begin applying the next sheet by putting the sheets together edge to edge and in the order shown on the diagram below. Once all pieces have been applied, trim any excess wallpaper as needed with an X-ACTO knife or other sharp craft knife.

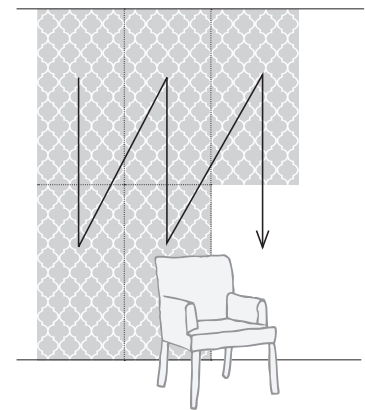

[Installation Order Diagram]

Troubleshooting

- What to do if you see air pockets forming during installation: pull back a small section and reapply the wallpaper.
- What to do if air pockets show after installation: poke a hole in the air pocket with a safety pin, then flatten out the wallpaper.

Handle with Care

- If you need to spot clean, use a dry wallpaper cleaner such as Absorene Antique Wallpaper Cleaner and always test a hidden spot first.
- Please do not use chemical cleaners.

*We are so happy to have
made this wallpaper
especially for you!*

IMPORTANT

Please follow our instructions carefully to ensure easy application and optimal wall adhesion.

Please clean your walls with water and cloth only and allow to completely dry before applying the wallpaper.

If the wallpaper is applied to a dirty or dusty wall, the stickiness of the adhesive will be compromised and the wallpaper may not completely adhere to your wall.

IMPORTANT