

## **WRITING DESK**

### **ASSEMBLY INSTRUCTION**



## ASSEMBLY INSTRUCTION

### ASSEMBLY INSTRUCTION

#### ASSEMBLY TIPS:

1. Remove hardware from box and sort by size.
2. Please check to see that all hardware and parts are present prior to start of assembly.
3. Please follow attached instructions in the same sequence as numbered to assure fast & easy assembly.



#### Warning !

1. Don't attempt to repair or modify parts that are broken or defective. Please contact the store immediately.
2. This product is for home use only and not intended for commercial establishment.

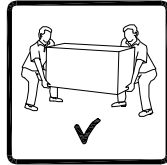

ASSEMBLY TIME PER UNIT: 30 MINUTES

#### PARTS IDENTIFICATION:

(A) TOP PANEL

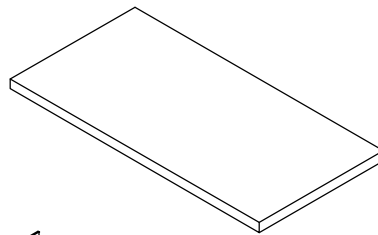

1PC

(B) LEG

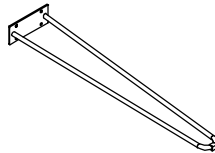

4PCS

Z	HARDWARE PACKAGE		
NO	DESCRIPTION	FIGURE	Q'TY
1	BOLT M6x20mm		16PCS
2	ALLEN WRENCH		1PC

## ASSEMBLY INSTRUCTION

STEP 1 :

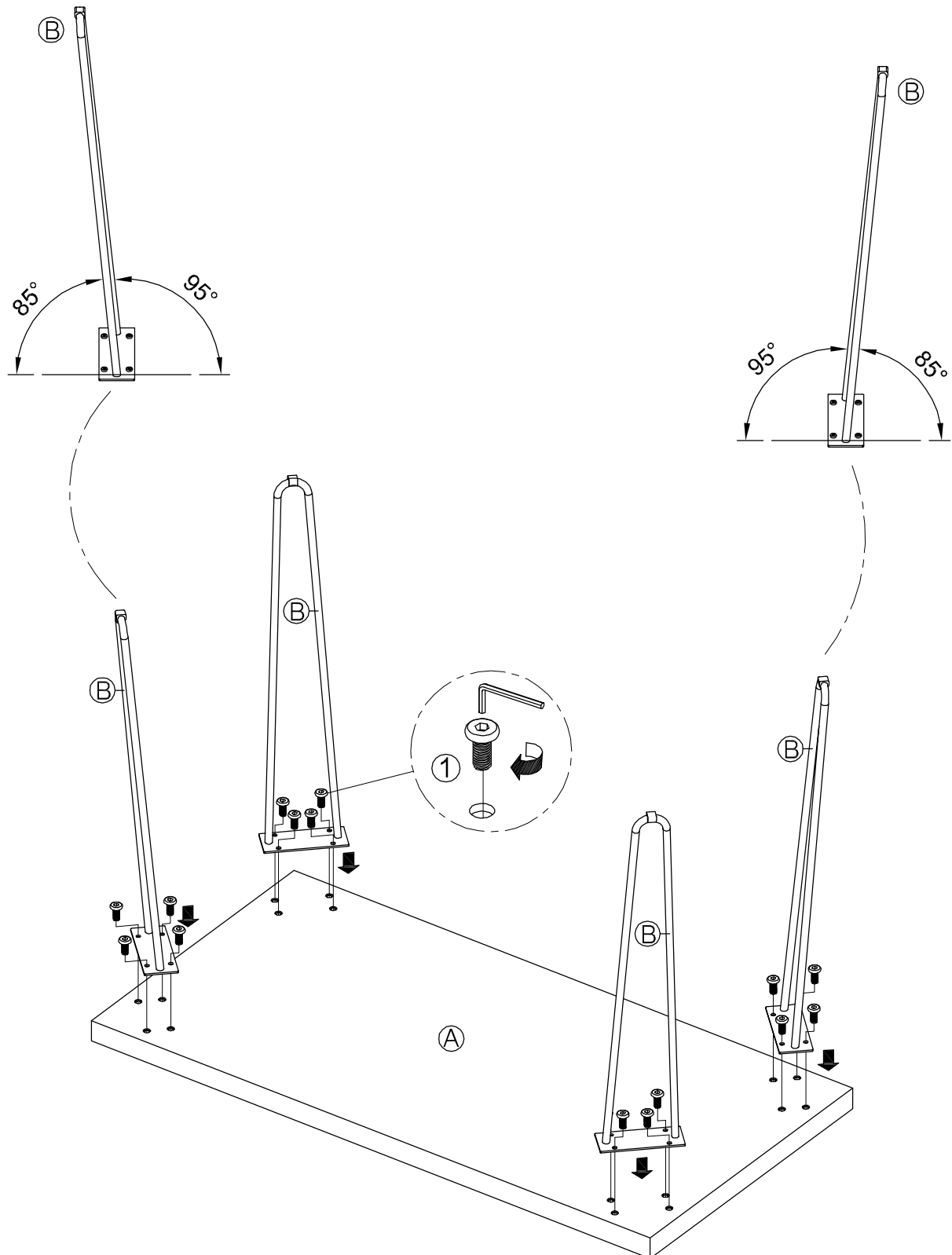
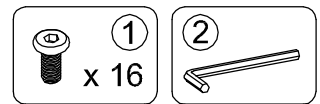

## ASSEMBLY INSTRUCTION

FINISH

