

KY-YT002AM

Storage Shed Instructions- double layer

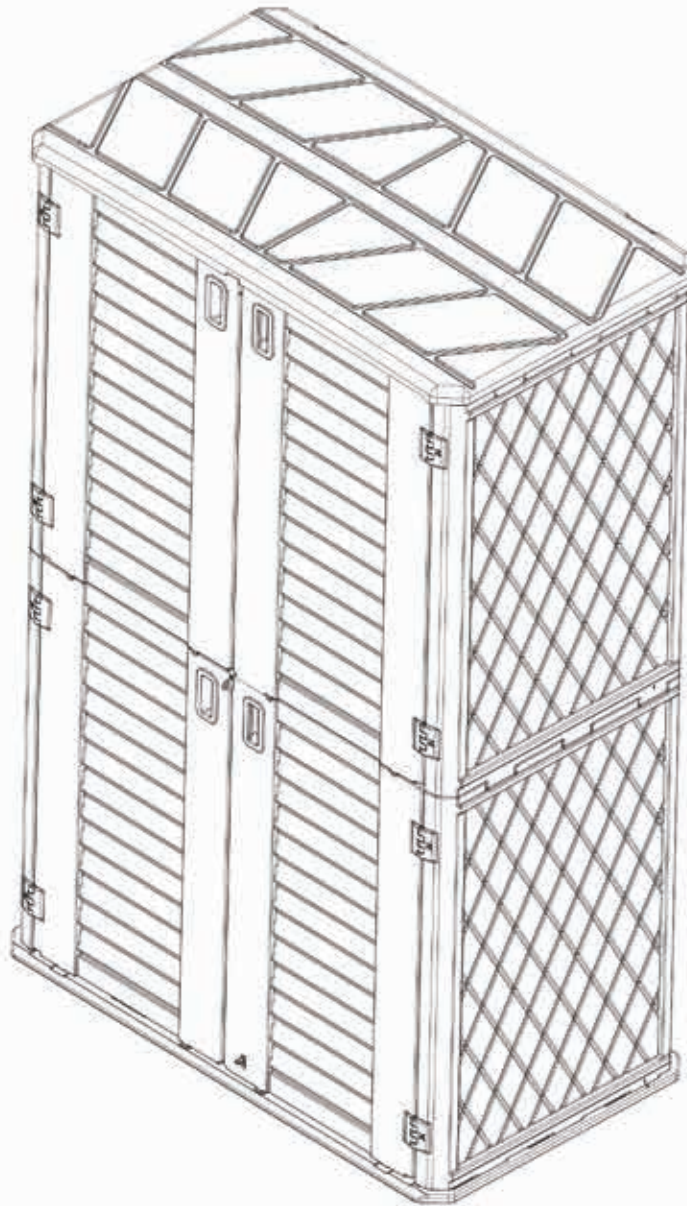

Contact us

Get quick responded for your issue.



Facebook QR Code

To scan QR codes, just go to facebook and type QR in the search, you will find the QR page to scan code.

ABOUT PRODUCT ASSEMBLY

Do not assemble the storage shed on severe cold or strong windy days.

We would advise 2 person to assist in the assembly of the storage shed to secure parts in place. Kids could not use it alone.

Level the ground surface before unpacking parts and beginning assembly.

Please check your package according to the PARTS LIST in the instructions to ensure that there are no missing or damaged before you starting assembly, kindly contact us if you find any wrong.

Please read instructions thoroughly prior to assembly, assemble all the parts according to the directions in this instructions, do not skip and steps

Our company provides extra hardware for use as spare parts for customer convenience. Please save the spare parts.

We would kindly advise you to follow the instruction to install, wrong assembly methods can result in damage to the inside of the hole to create links between the panels loose or unable to assembled properly.

LEVEL THE GROUND SURFACE

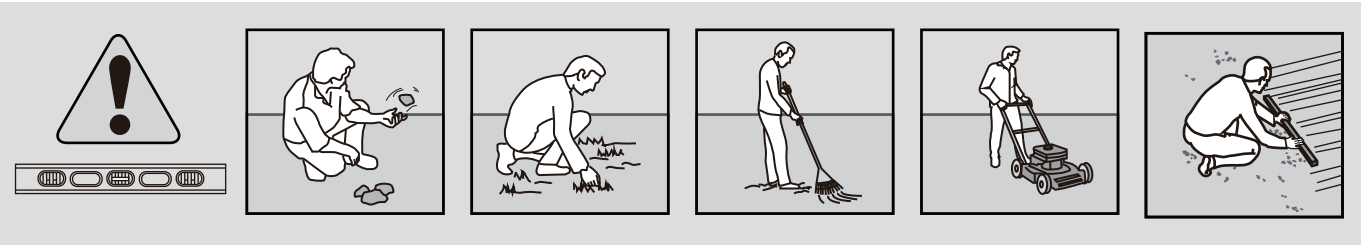

Level the ground surface before unpacking parts and beginning assembly.

REQUIRED TOOLS



Allen Key



Screwdriver

PARTS NO. POSITION

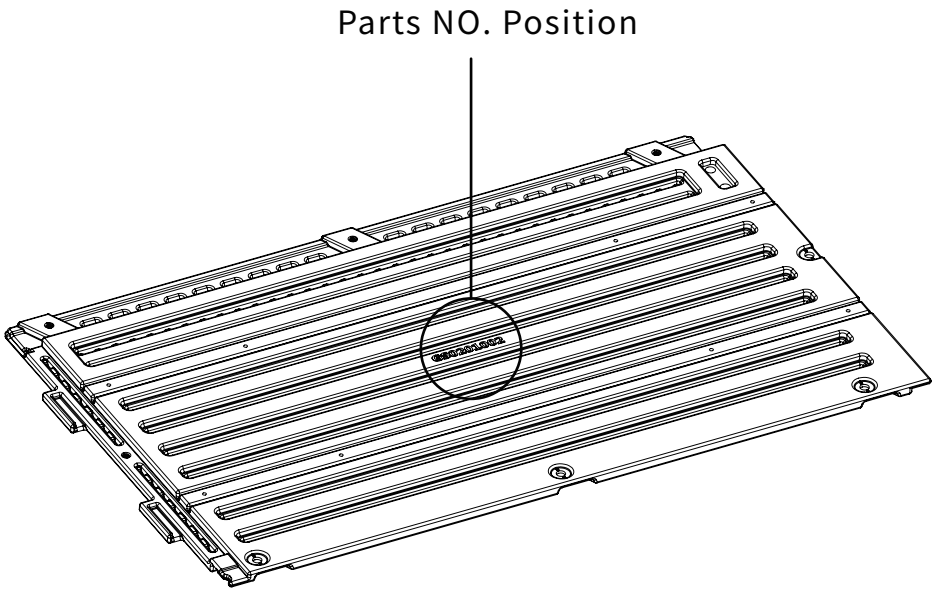

Parts List

NO.	Parts NO.	Parts Name	Material	Quantity	Specification
1	GS0201001	Floor	HDPE	1	50.24x29.06x1.38inches
2	GS0201002	Left Back Panel	HDPE	2	40.16x23.78x0.98inche
3	GS0201003	Right Back Panel	HDPE	2	40.16x21.81x0.98inches
4	GS0201004	Left Side Panel	HDPE	2	40.16x27.32x4.72inches
5	GS0201005	Right Side Panel	HDPE	2	40.16x27.32x4.72inches
6	GS0201006	Left Door	HDPE	2	38.97x23.43x1.5inches
7	GS0201007	Right Door	HDPE	2	38.97x22.56x1.5inches
8	GS0201008	Roof	HDPE	1	49.61x28.74x1.73inches

NO.	Parts NO.	Parts Name	Material	Quantity	Specification
9	GS0201022	Plastic Bolts	Plastic	16	M9.5x25.5 mm
10	GS0201023	Plastic Bolts	Plastic	8	M9.5x18.5 mm
11	GS0201014	Hinge	Plastic	10	70x38x25 mm
12	GS0201018	Latch -1	Plastic	1	61x40x15 mm
13	GS0201019	Latch -2	Plastic	1	88x43x13 mm

14	GS0201028	Strength the Block	Metal	20	58x18x1.2 mm
15	GS0201025	Fixing Piece for Roof	Metal	2	30x30x16 mm
16	GS0201016	L-1	Metal	1	37x20x16 mm
17	GS0201017	L-2	Metal	1	39x20x20 mm
18	GS0201024	Strength the Connecting Rod	Metal	12	500x30x8 mm
19	Y202338	M5.5x19	Metal	88	M5.5x19 mm
20	Y202333	M4x10	Metal	12	M4x10 mm
		Instructions	/	1	
		Spare Parts	/	1	

Please save the spare parts

Wall Panels and Floor

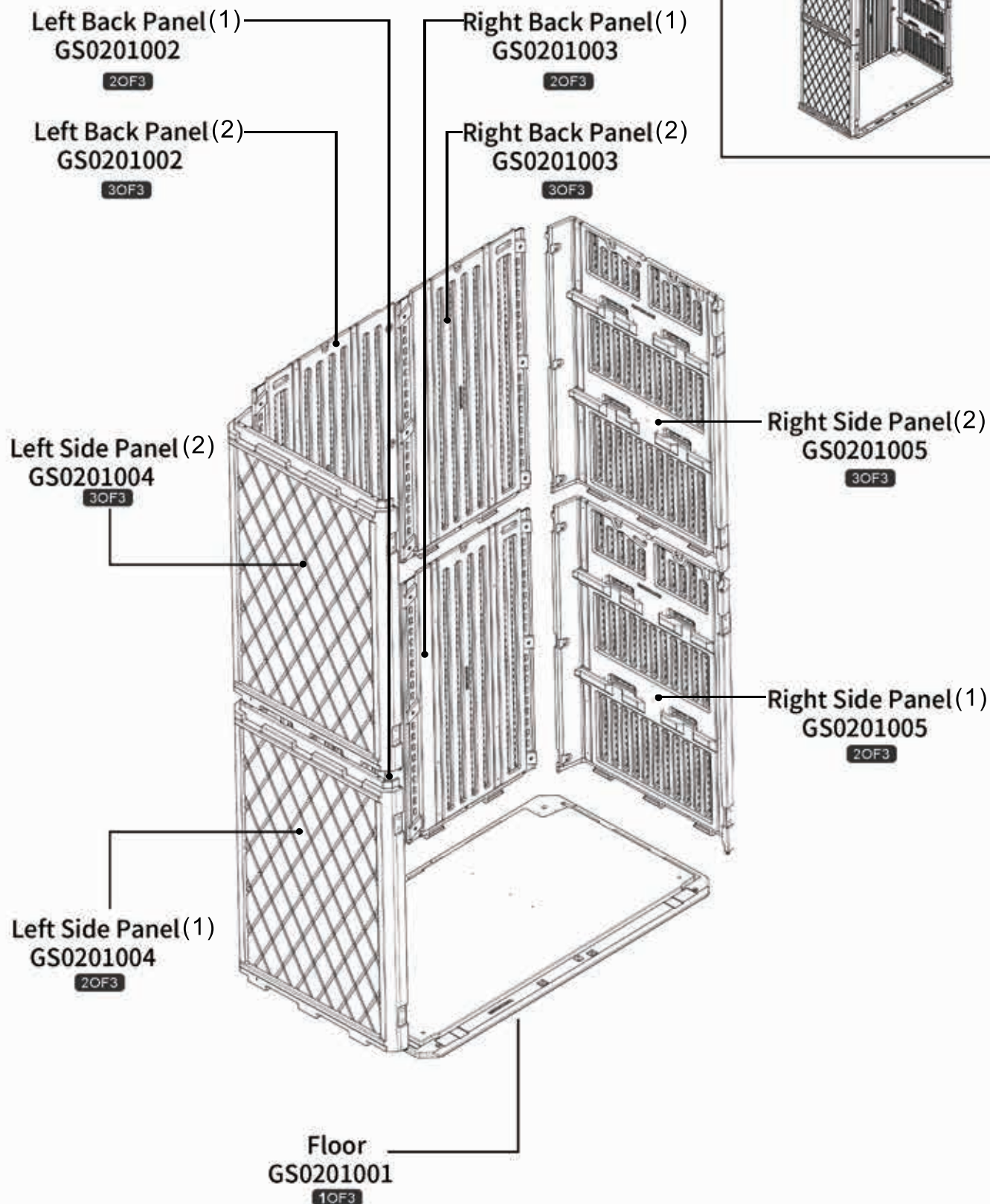

Doors and Roof

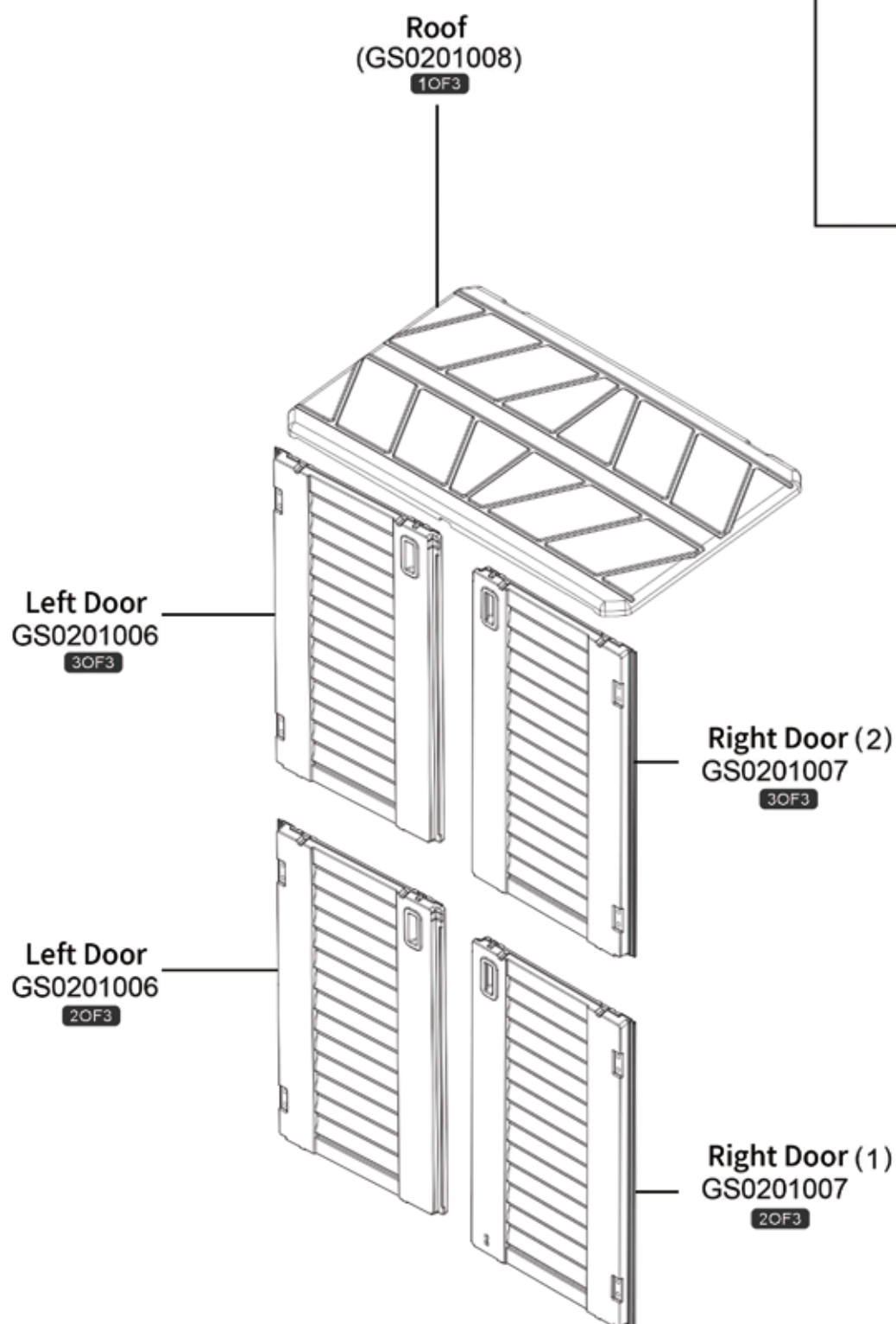

Wall Panels

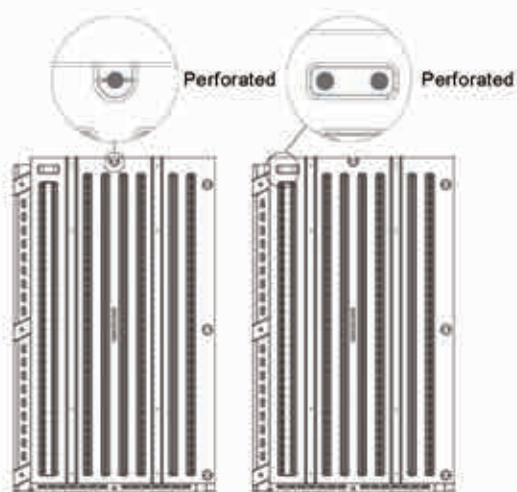

2OF3
Left Back Panel (1)
GS0201002

3OF3
Left Back Panel (2)
GS0201002

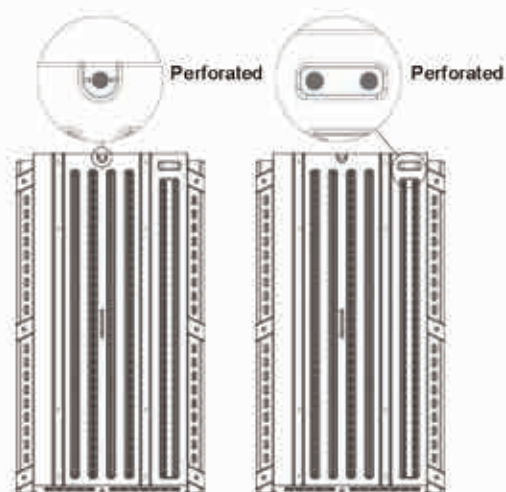

2OF3
Right Back Panel (1)
GS0201003

3OF3
Right Back Panel (2)
GS0201003

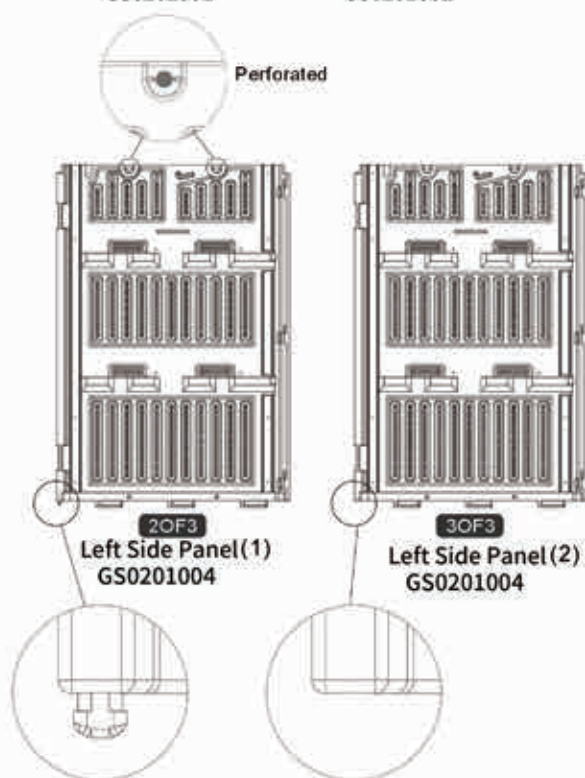

2OF3
Left Side Panel (1)
GS0201004

3OF3
Left Side Panel (2)
GS0201004

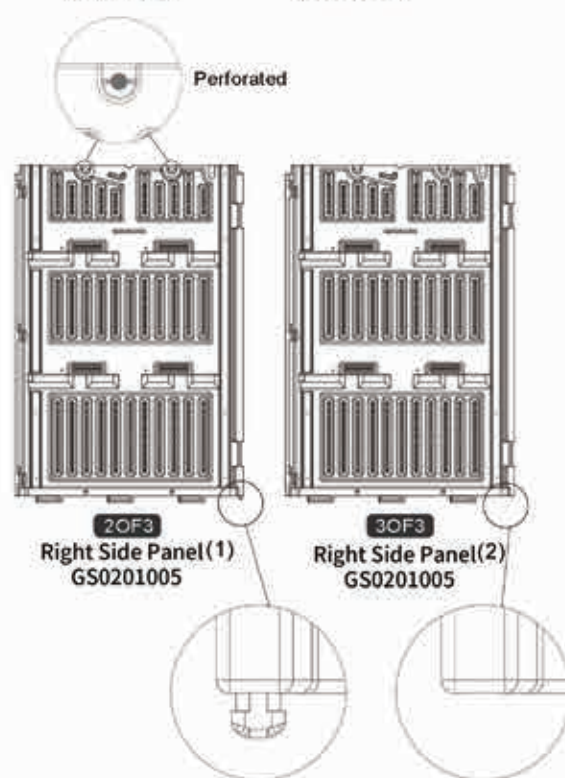

2OF3
Right Side Panel (1)
GS0201005

3OF3
Right Side Panel (2)
GS0201005

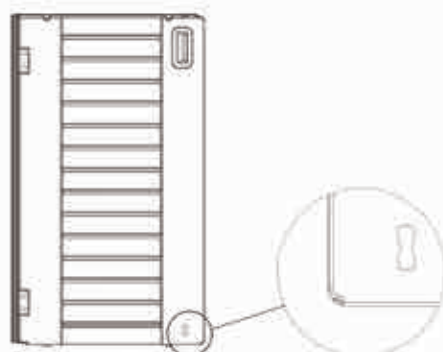

2OF3
Right Door (1)
GS0201007

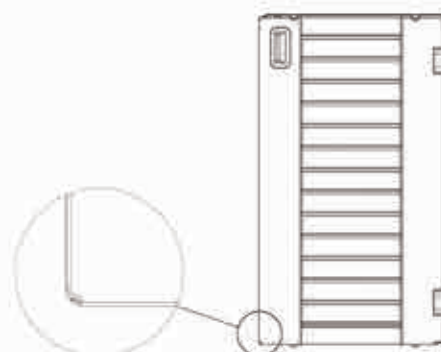

3OF3
Right Door (2)
GS0201007

Hardware

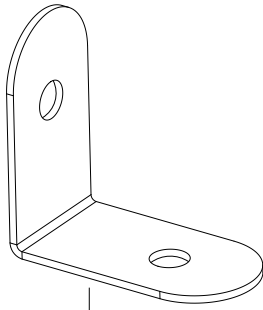

Fixing Piece for Roof
(GS0201025)x2pcs

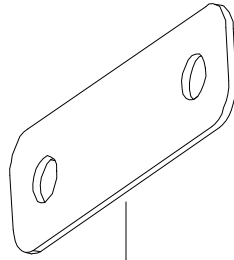

Strength the Block
(GS0201028)x20pcs

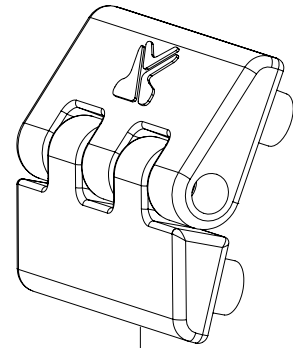

Hinge
(GS0201014)x10pcs

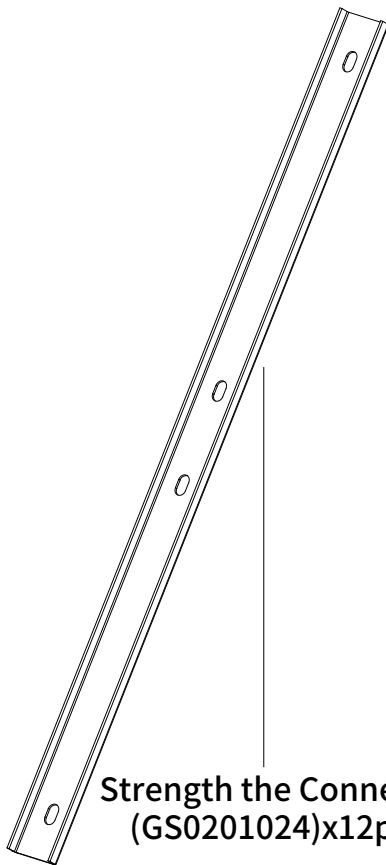

Strength the Connecting Rod
(GS0201024)x12pcs

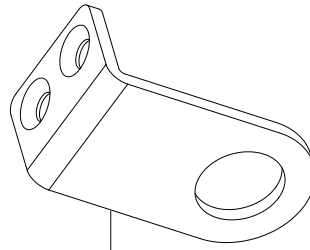

L-1
(GS0201016)x1pcs

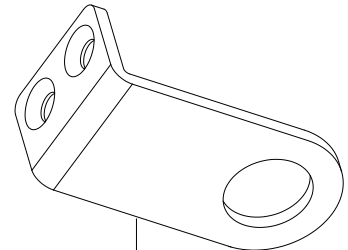

L-2
(GS0201017)x1pcs

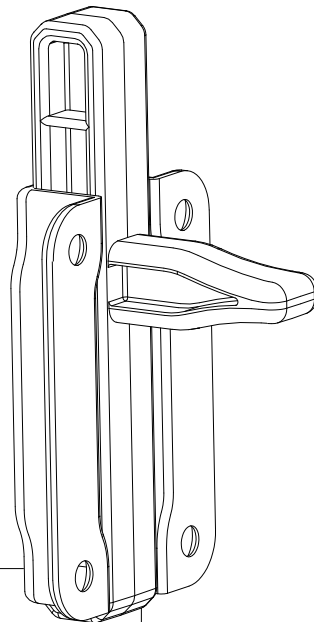

Latch -1
GS0201018 x1pcs

Latch -2
GS0201019 x1pcs

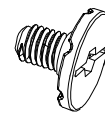

Plastic Bolts
GS0201023
M9.5*18.5x8pcs

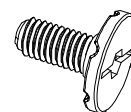

Plastic Bolts
GS0201022
M9.5*25.5x16pcs

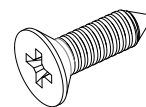

M4x10
Y202333
12pcs

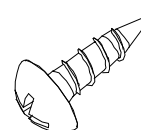

M5.5x19
Y202338
88pcs

1 Back panels to install



Left Back Panel
(GS0201002)X1pcs



Right Back Panel
(GS0201003)X1pcs



Right Back Panel
(GS0201023)
M9.5*18.5 X3pcs

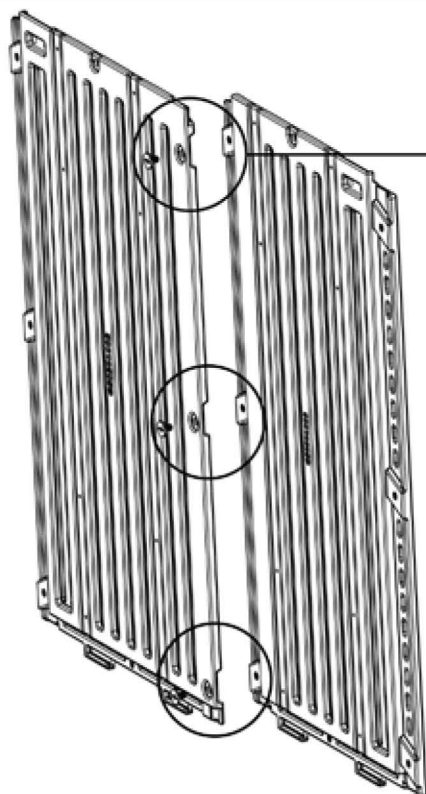

1

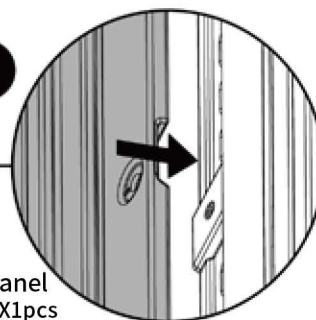

Left Back Panel
(GS0201002)X1pcs
Right Back Panel
(GS0201003)X1pcs

2

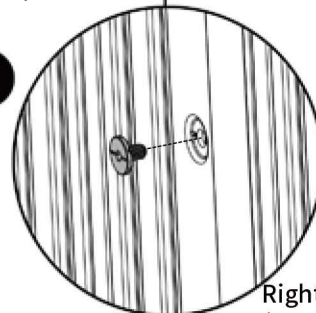

Right Back Panel
(GS0201023)
M9.5*18.5 X3pcs

2 Floor panel to install



Floor
(GS0201001)X1pcs

1

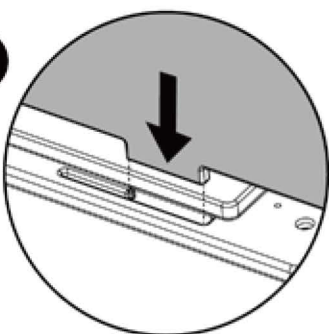

2

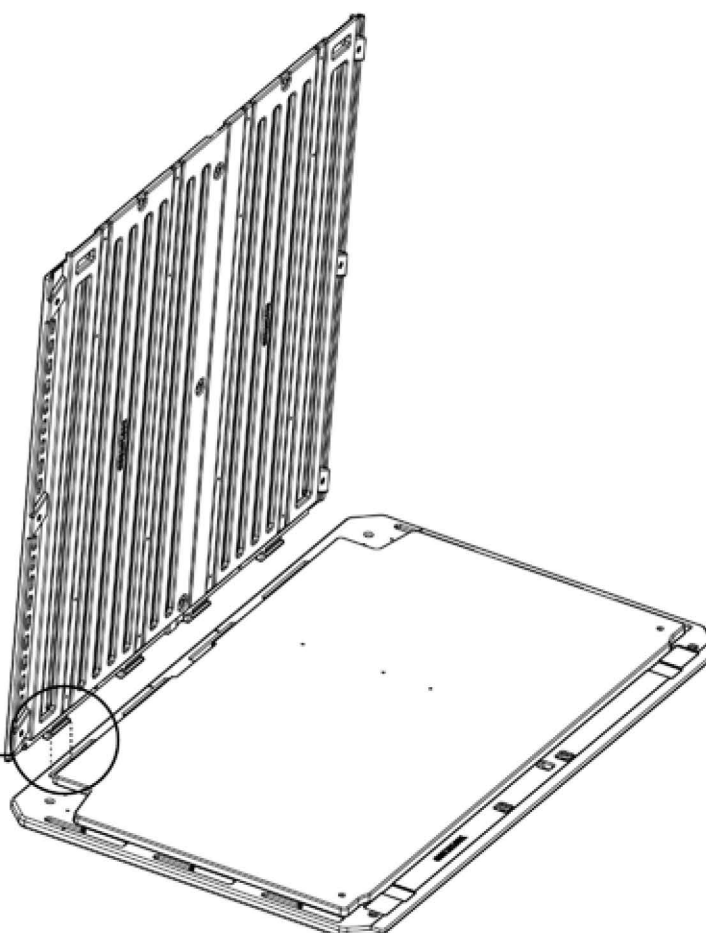
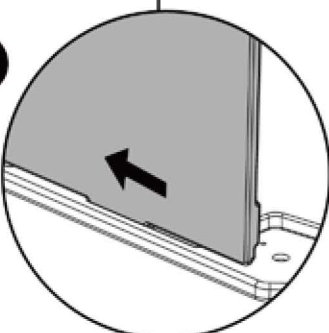

3 Side panels to install

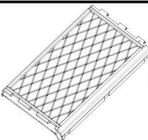

Left Side Panel
(GS0201004)

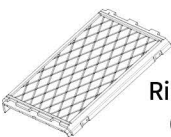

Right Side Panel
(GS0201005)



Plastic Bolts
GS0201022
M9.5*25.5x 6pcs

3

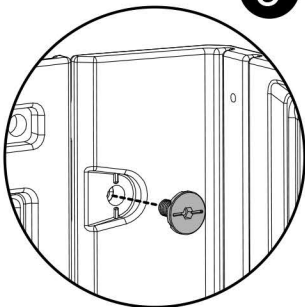

Plastic Bolts
GS0201022
M9.5*25.5x 6pcs

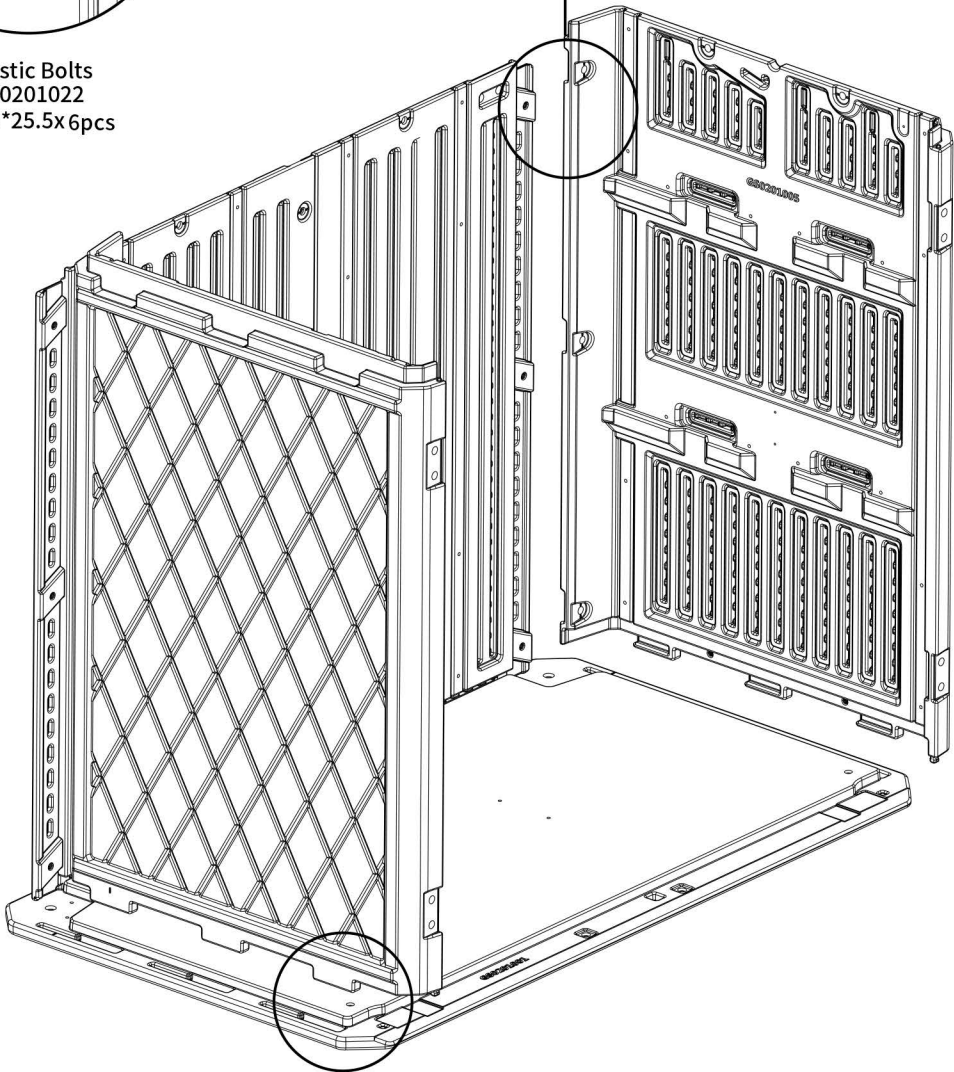

1

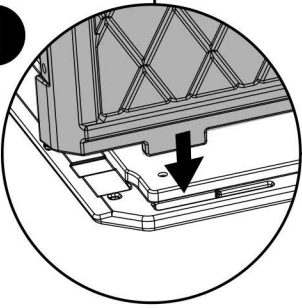

2

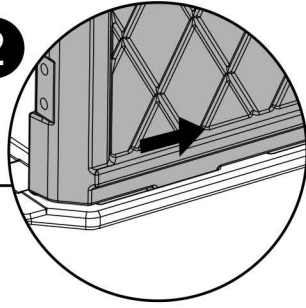

4

Left back panel (top) to install



Left Back Panel
(GS0201002)x1pcs



Strength the
Connecting Rod
(GS0201024)x2pcs



M5.5x19
Y202338
8pcs



Plastic Bolts
GS0201023
M9.5*18.5x1pcs

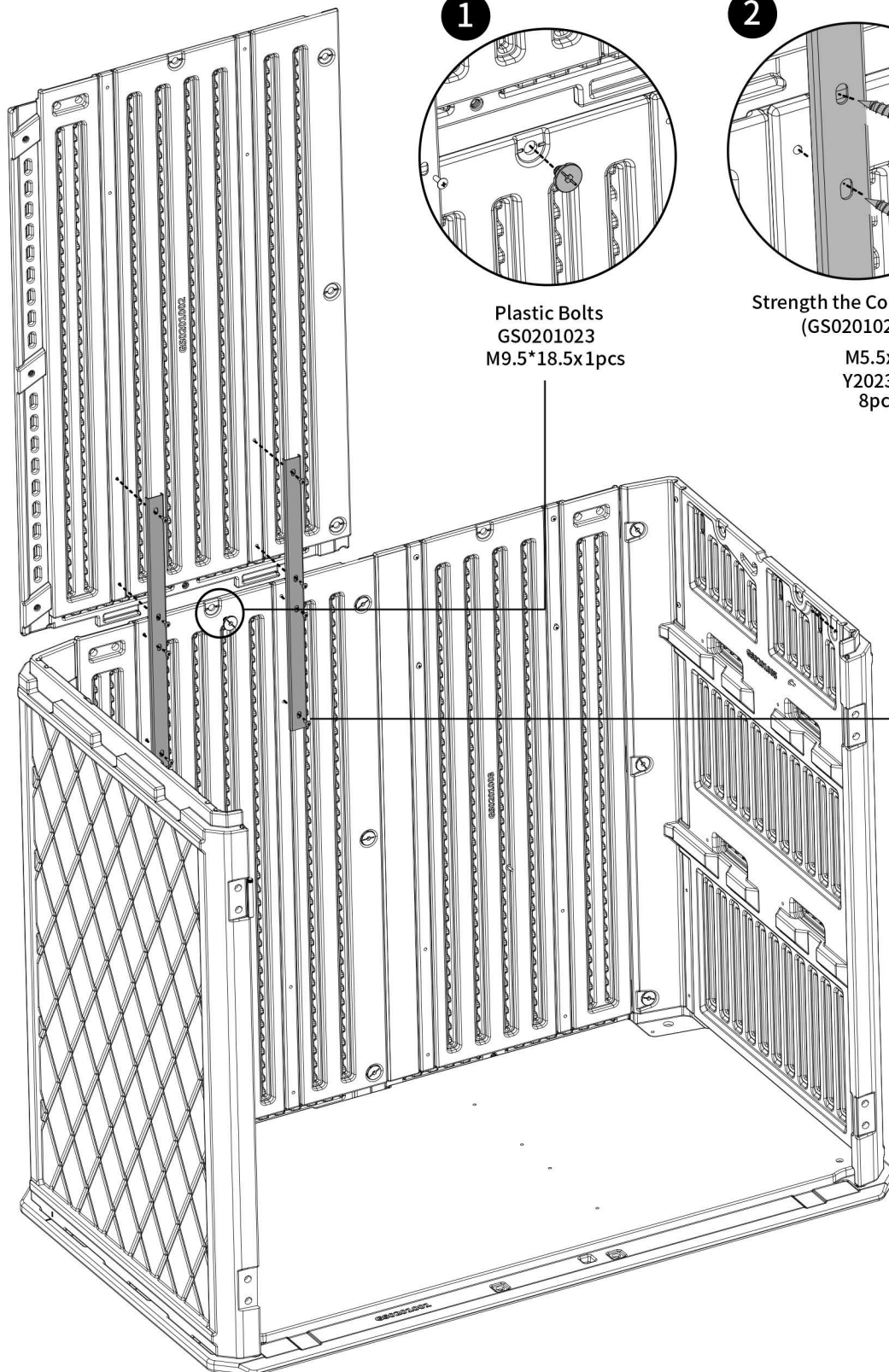

1

Plastic Bolts
GS0201023
M9.5*18.5x1pcs

2

Strength the Connecting Rod
(GS0201024)x2pcs

M5.5x19
Y202338
8pcs

5

Right back panel (top) to install

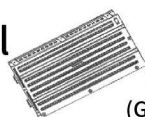

Right Back Panel
(GS02011003)x1pcs



Strength the
Connecting Rod
(GS0201024)x2pcs



M5.5x19
Y202338
8pcs



Plastic Bolts
GS0201023
M9.5*18.5x4pcs

1

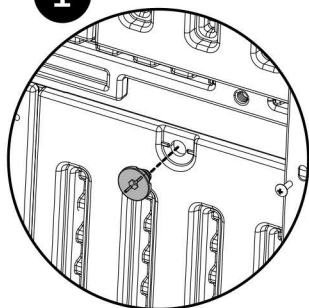

Plastic Bolts
GS0201023
M9.5*18.5x4pcs

2

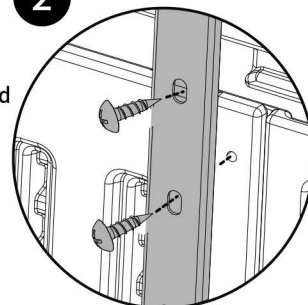

Strength the Connecting Rod
(GS0201024)x2pcs

M5.5x19
Y202338
8pcs

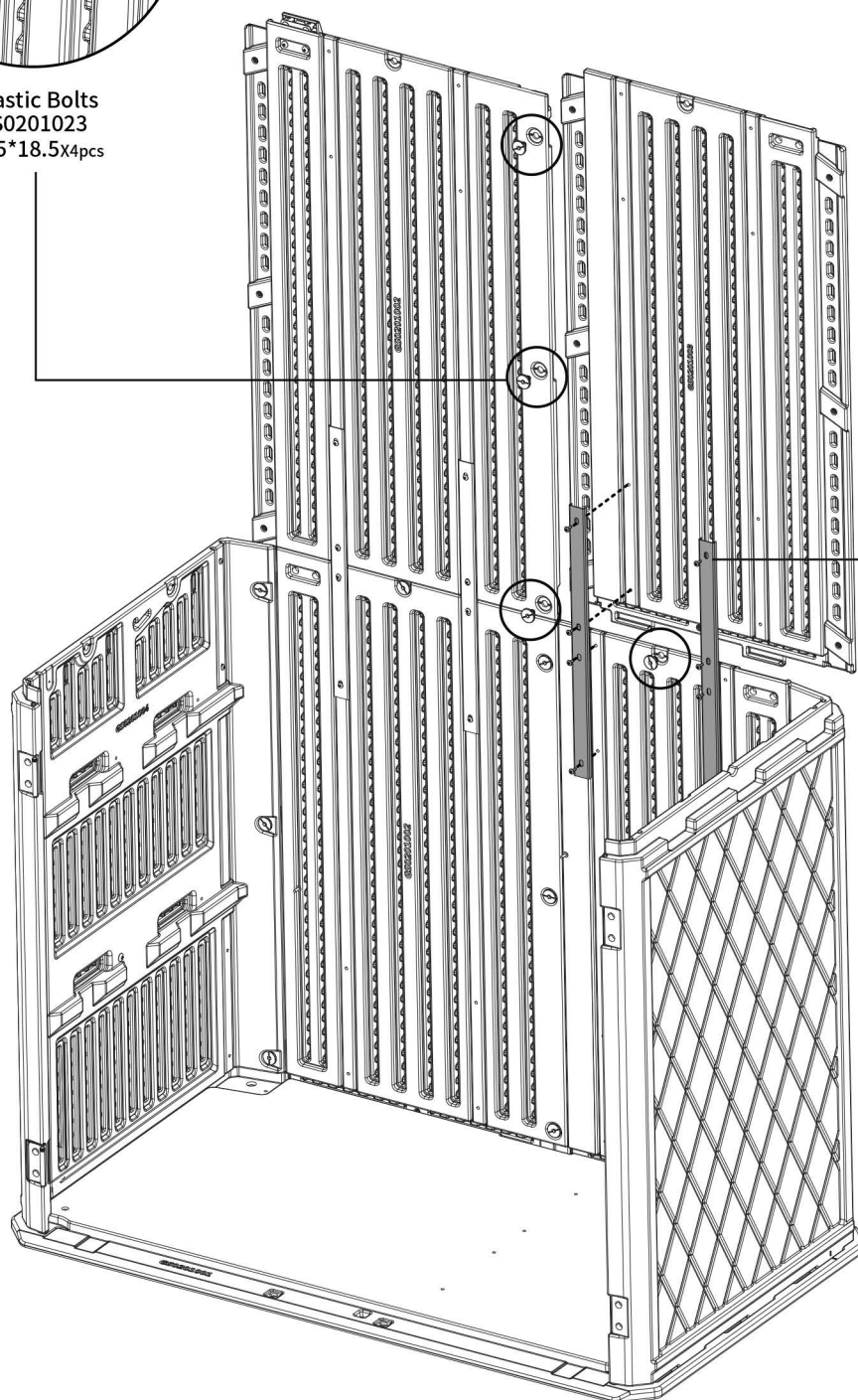

6

Left side panel (top) to install



Left side Panel
GS0201004 x 1pcs



Strength the
Connecting Rod
(GS0201024) x 2pcs



M5.5x19
Y202338
8pcs



Plastic Bolts
GS0201022
M9.5*25.5 x5pcs

1

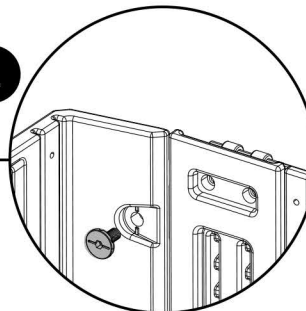

Plastic Bolts
GS0201022
M9.5*25.5x5pcs

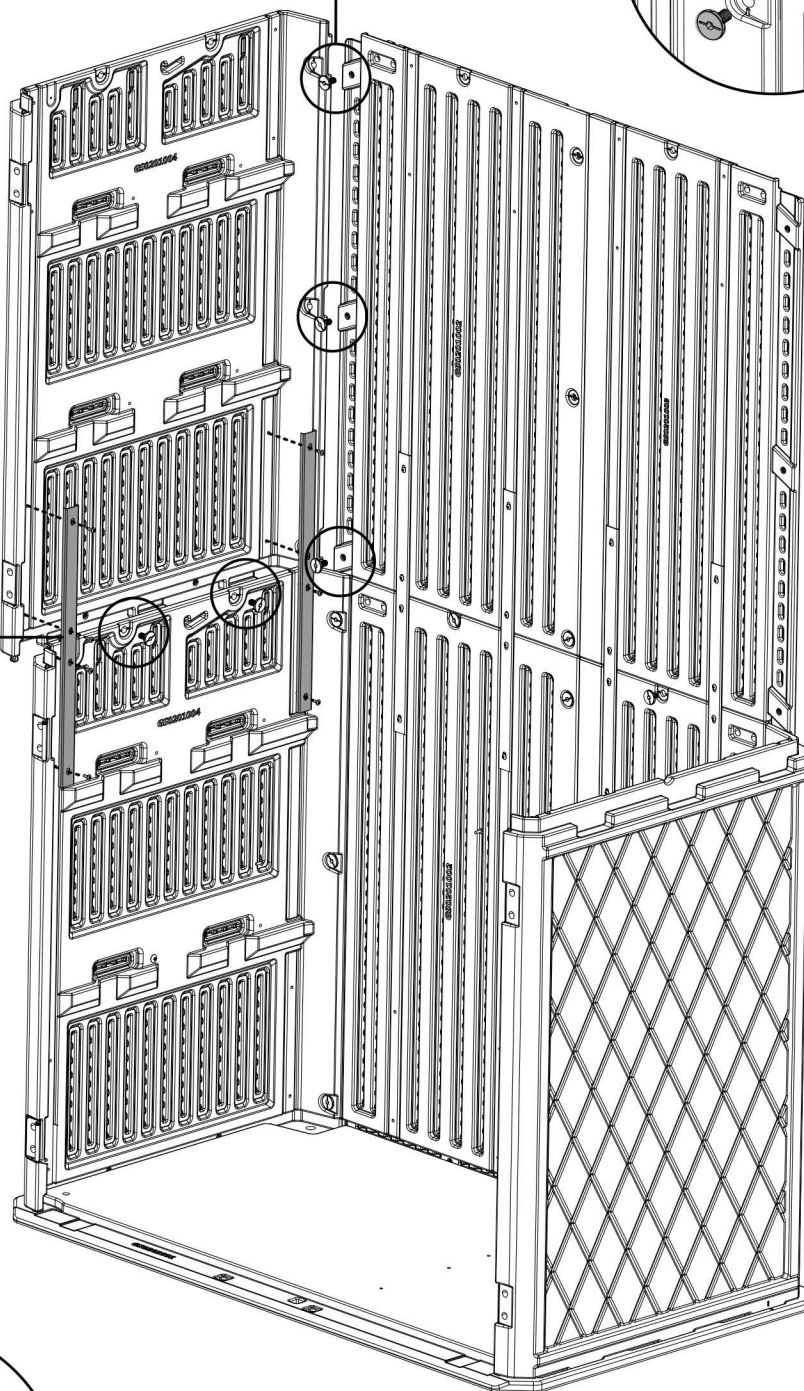

2

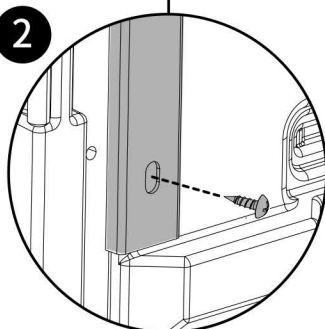

M5.5x19
Y202338
8pcs

Strength the
Connecting Rod
(GS0201024)x 2pcs

7 Right side panel (top) to install



Right side Panel
(GS0201005)x1pcs



Strength the
Connecting Rod
(GS0201024)x2pcs



M5.5x19
Y202338
8pcs



Plastic Bolts
GS0201022
M9.5*25.5x 5pcs

1

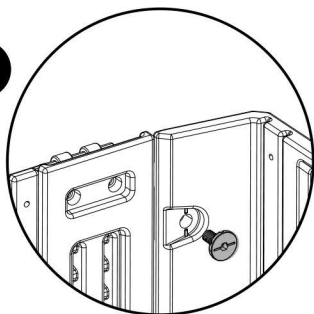

Plastic Bolts
GS0201022
M9.5*25.5x5pcs

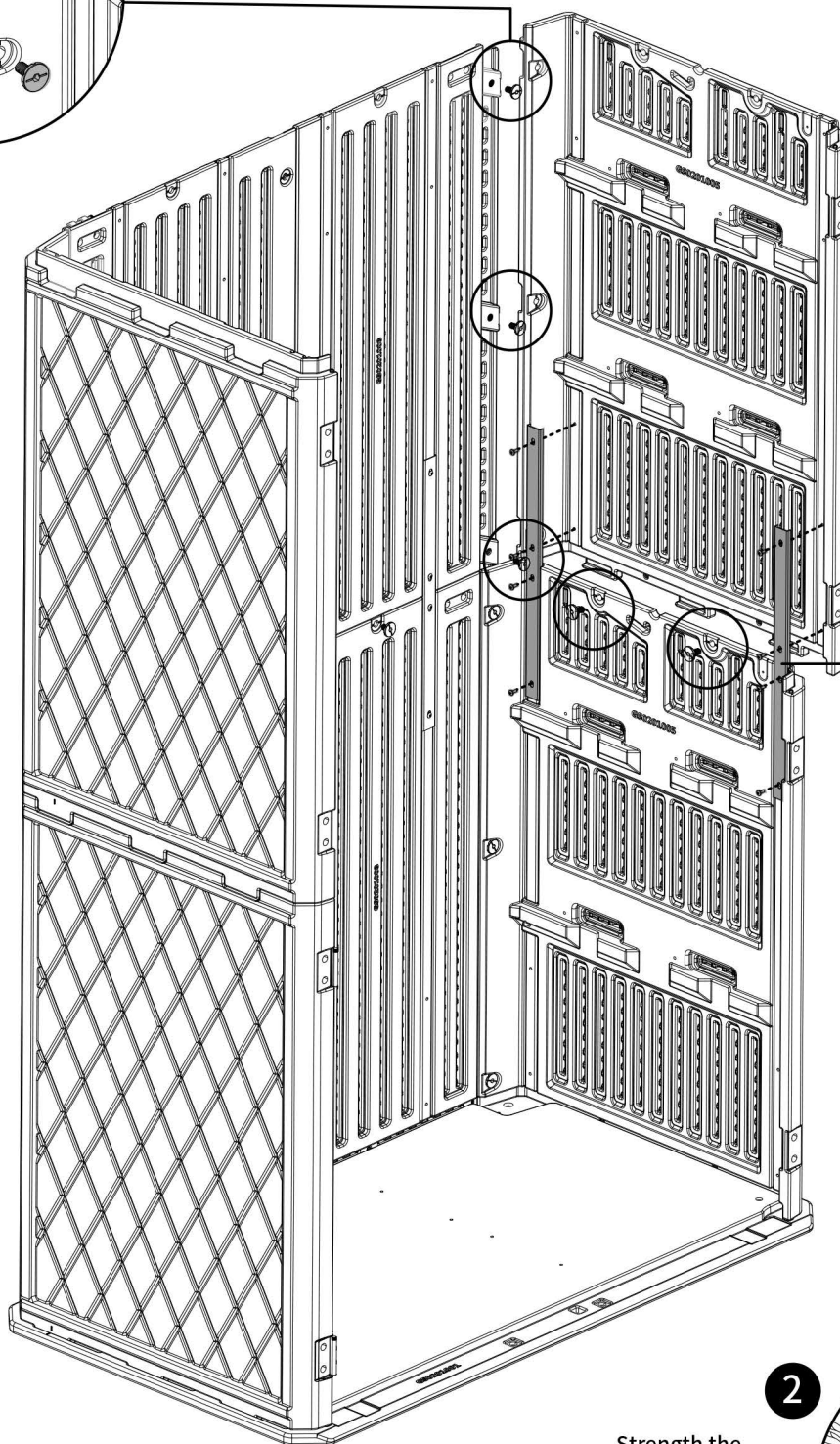

2

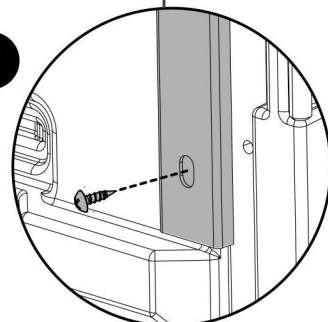

Strength the
Connecting Rod
(GS0201024)x 2pcs

M5.5x19
Y202338
8pcs

8

Roof accessories to install

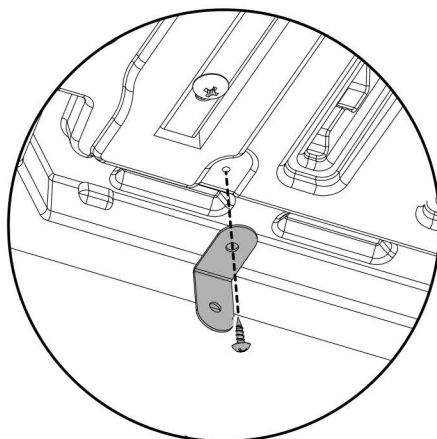

M4x10
Y202333
2pcs

Fixing Piece for Roof
GS0201025)x2pcs

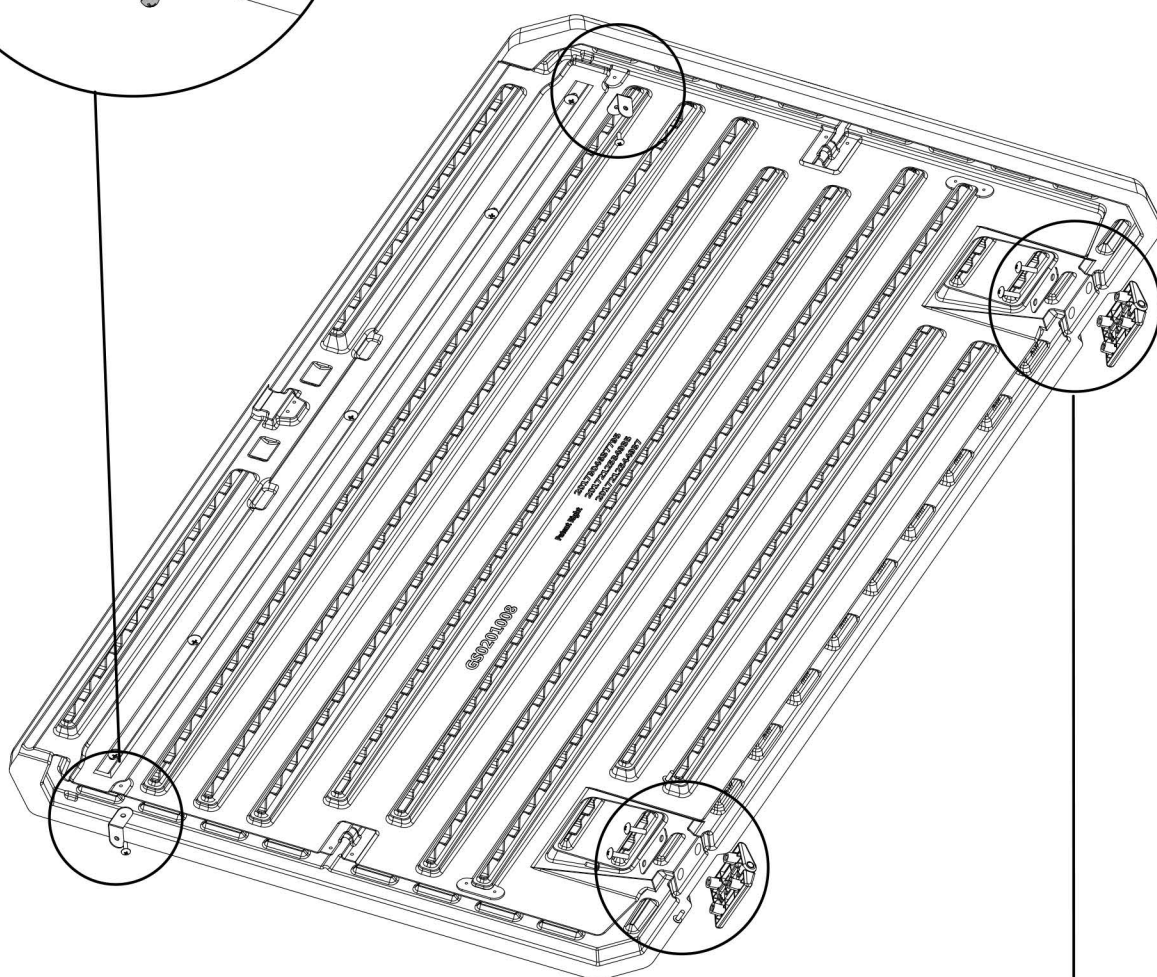

M5.5x19
Y202338
4pcs

Hinge
(GS0201014)x2pcs

Strength the Block
(GS0201028)x2pcs

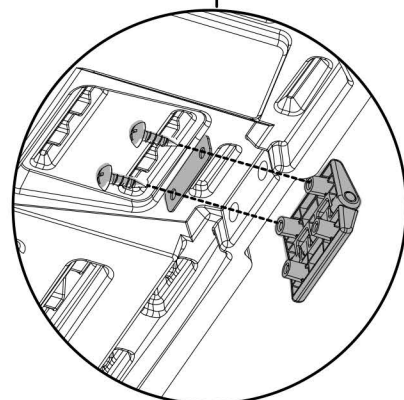

9

Roof to install

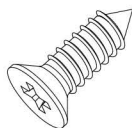

M4x10
Y202333
2pcs



M5.5x19
Y202338
4pcs

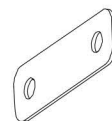

Strengthen the Block
(GS0201028)x2pcs

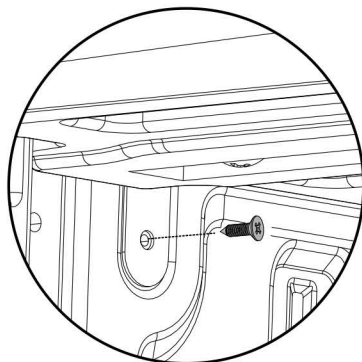

M4x10
Y202333
2pcs

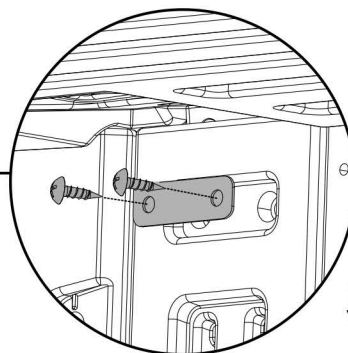

M5.5x19
Y202338
4pcs

Strengthen the Block
(GS0201028)x2pcs

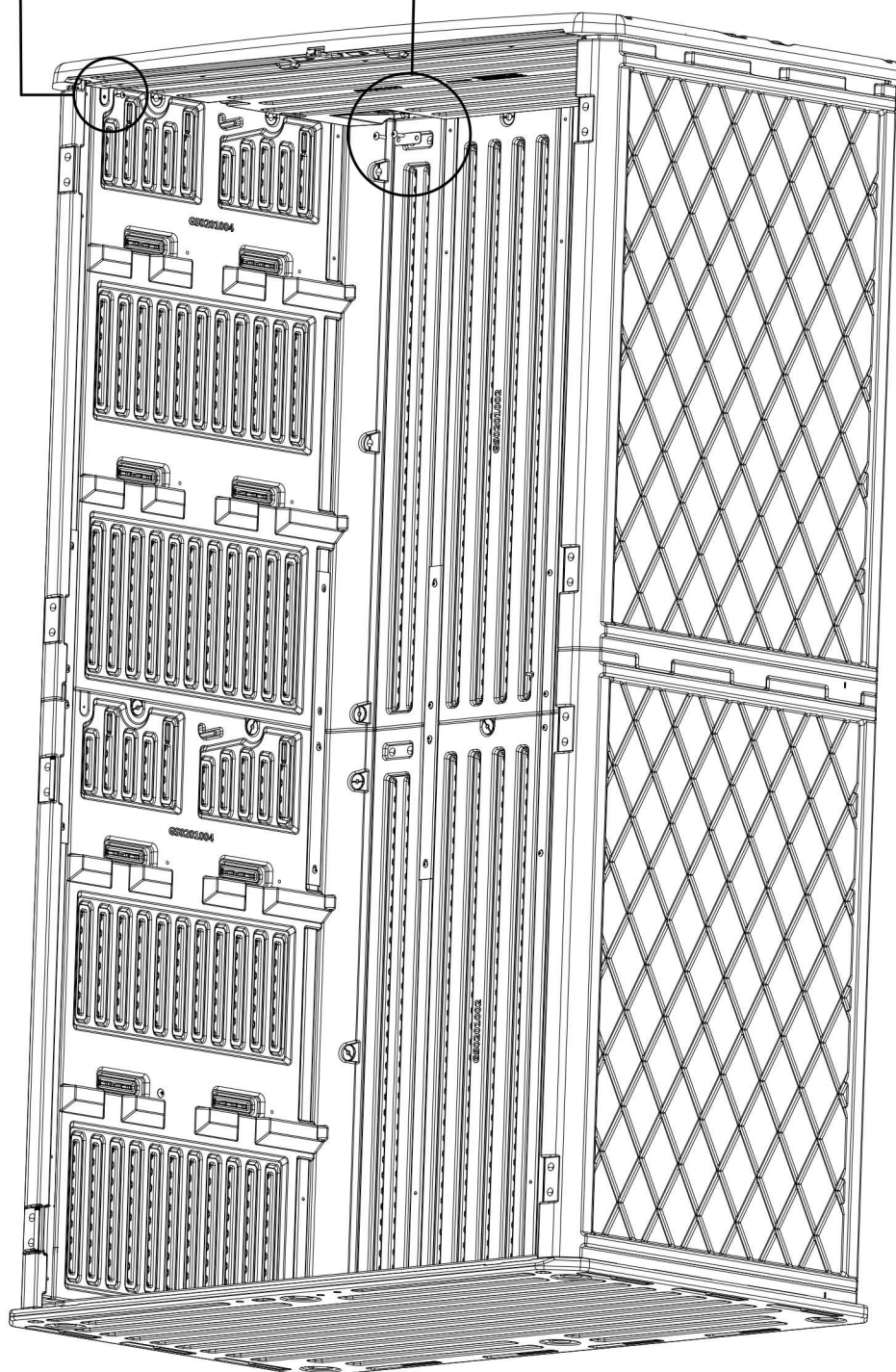

10 Door accessories to install

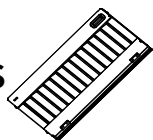

Right Door
(GS0201007)



Hinge
(GS0201014)x2pcs

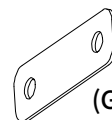

Strength the Block
(GS0201028)x2pcs



M4x10
Y202333
6pcs

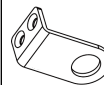

L-1
(GS0201016)x1pcs

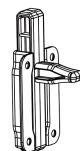

Latch -1
(GS0201018)x1pcs



Latch -2
(GS0201019)x1pcs

M5.5x19
Y202338
4pcs

M4x10
Y202333
2pcs

L-1
(GS0201016)x1pcs

1

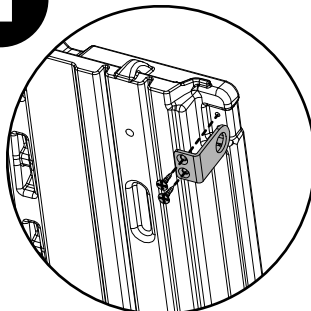

Latch -1
(GS0201018)x1pcs

Latch -2
(GS0201019)x1pcs

M4x10
Y202333
4pcs

2

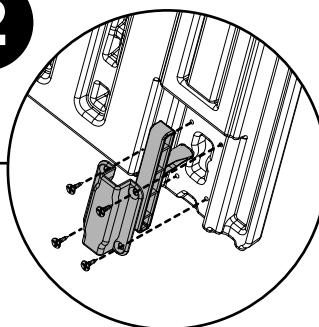

3

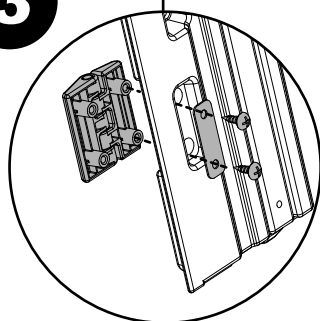

Strength the Block
(GS0201028)x2pcs

Hinge
(GS0201014)x2pcs

M5.5x19
Y202338
4pcs

11

Door accessories to install

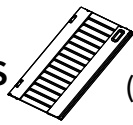

Left Door
(GS0201006)

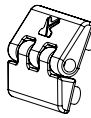

Hinge
(GS0201014)x2pcs

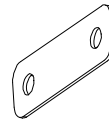

Strength the Block
(GS0201028)x2pcs



M4x10
Y202333
2pcs

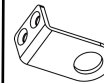

L-2
(GS0201017) x1pcs



M5.5x19
Y202338
4pcs

1

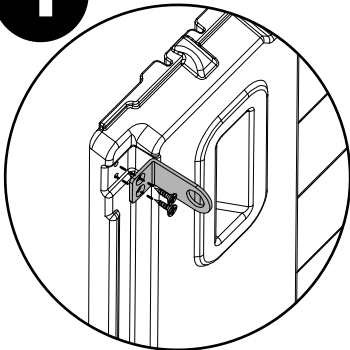

M4x10
Y202333
2pcs

L-2
(GS0201017) x1pcs

2

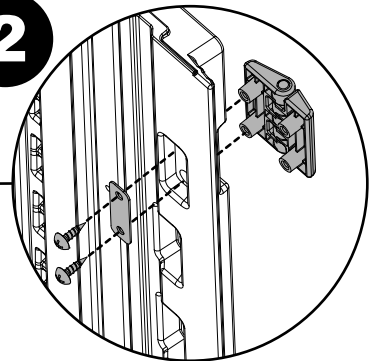

Hinge
(GS0201014)x2pcs

Strength the Block
(GS0201028)x2pcs

M5.5x19
Y202338
4pcs

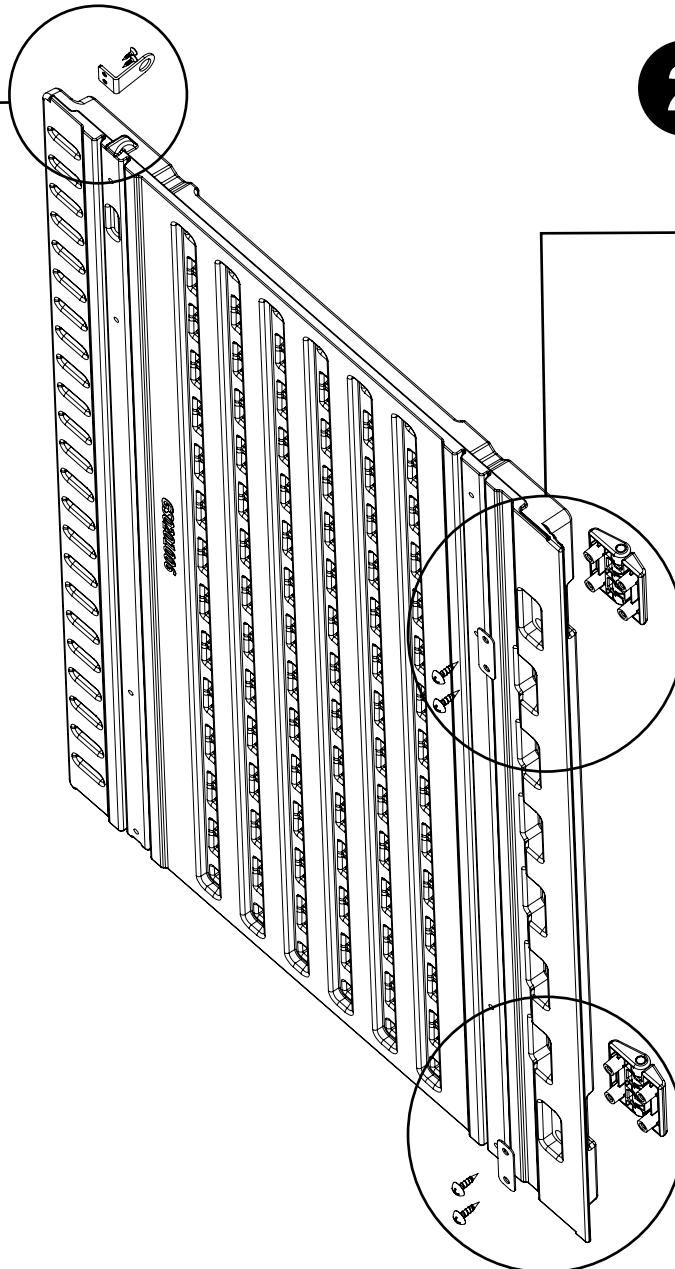

12

Right Door to install

Right door
(GS0201007)x2pcs

Strength the Block
(GS0201028)x4pcs

Strength the
Connecting Rod
(GS0201024)x2pcs

M5.5x19
Y202338
16pcs

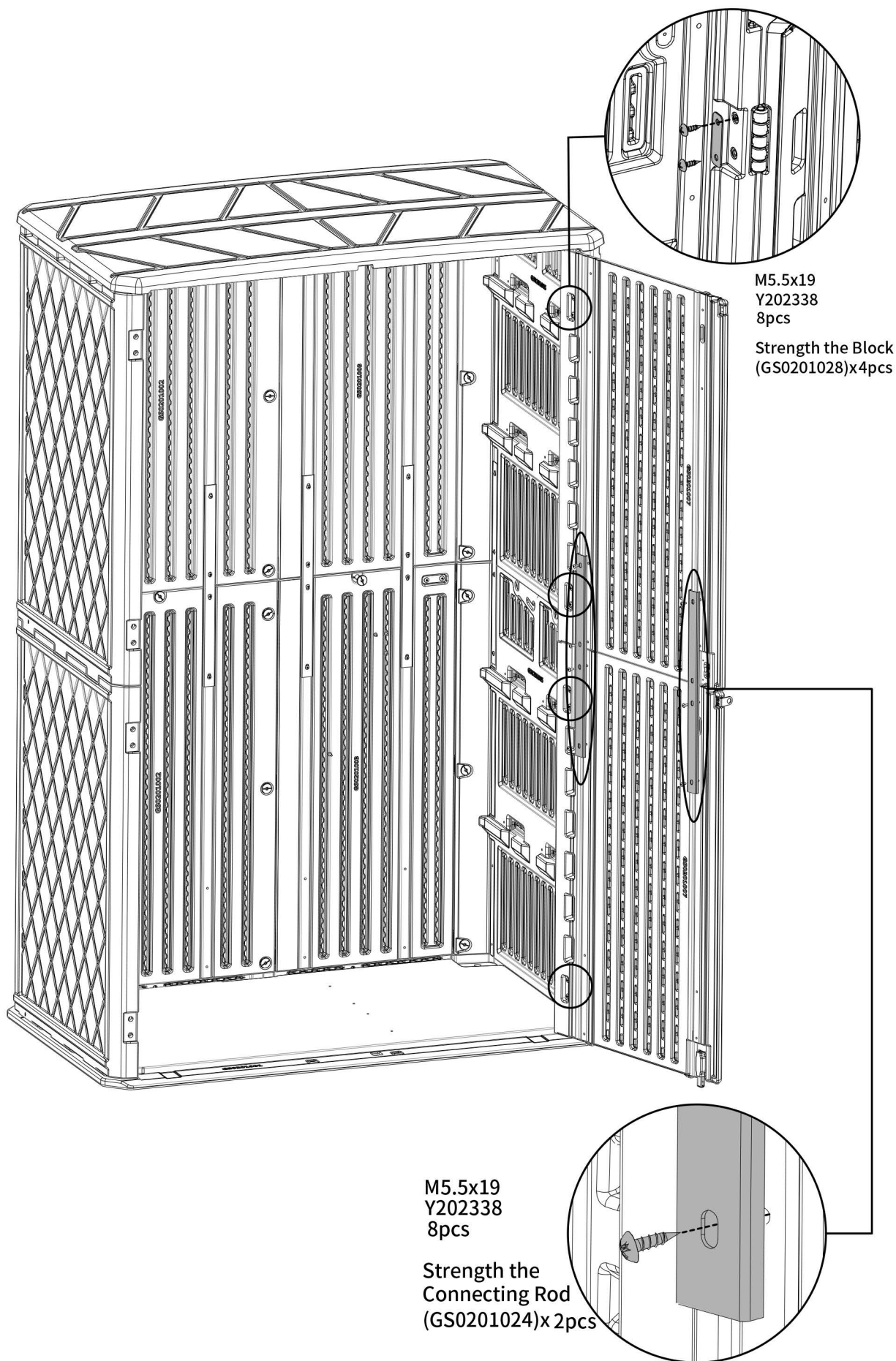

13 Left Door to install

Left door
(GS0201006)x2pcs



Strength the Block
(GS0201028)x 4pcs

Strength the
Connecting Rod
(GS0201024)x2pcs

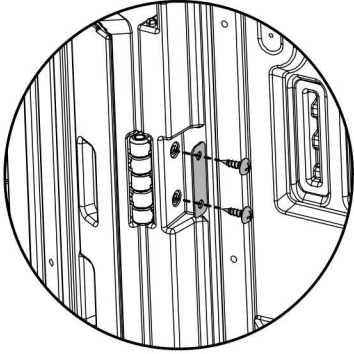
 M5.5x19
Y202338
16pcs

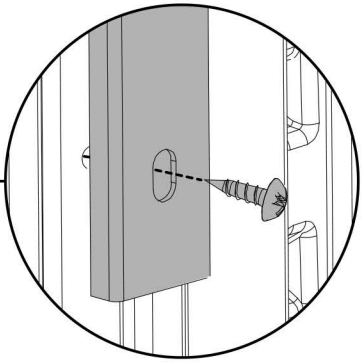
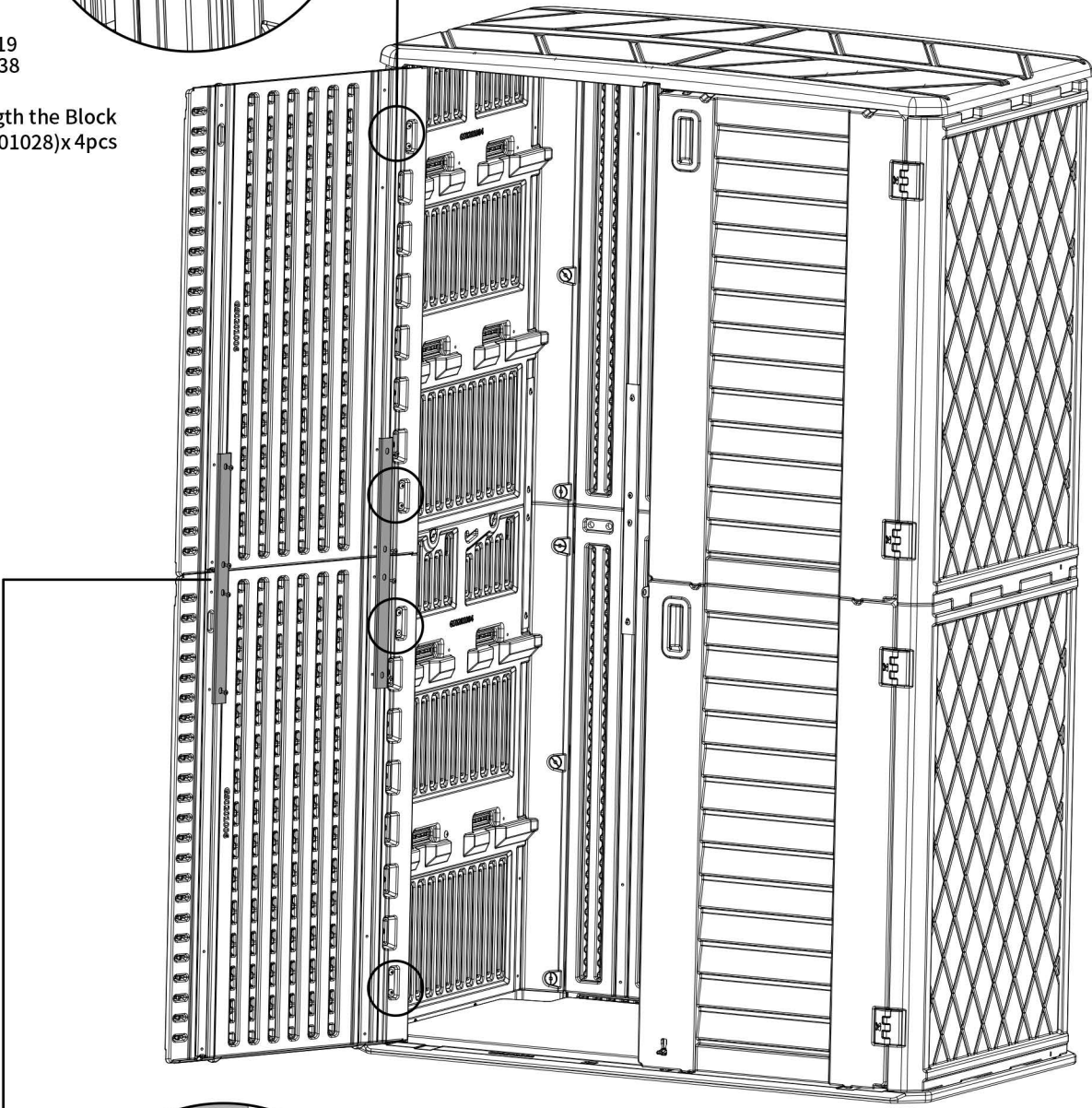

M5.5x19
Y202338
8pcs
Strength the Block
(GS0201028)x 4pcs



M5.5x19
Y202338
8pcs
Strength the
Connecting Rod
(GS0201024)x2pcs

ABOUT PRODUCT MAINTENANCE

This storage shed should be far away from the open flame.

Do not use the storage shed in extreme weather conditions.

At regular check the storage shed to ensure that it's stable and assembly integrity has been maintained.

Please keep doors closed and locked outdoor when the storage shed is not in use long time to prevent wind damaged or damaged by animals or bad people.

Do not store hot items(recently used grills, blowtorches etc.),flammable or caustic chemicals in the storage shed.

Wash the storage shed with a mild soap and water if there is any stain on the storage shed. Do not use a stiff brush,bleach,ammonia or any other caustic cleaners, as these may damage the storage shed or could result in permanent staining of the plastic.This is not manufacturing defect and is not covered under warranty.

If the environment permits, install the storage shed in a cool place, as prolonged exposure to direct sunlight may deform the panel and accelerate aging.

SUGGESTIONS AND SOLUTIONS FOR PRODUCT COMMON ISSUES

Our company sell brand new storage shed and using original packaging. When you receive the goods, if you find that the product part was lost or damaged, please take real photos and contact us in time to feedback the problem you encountered, we will try our best to solve it ASAP.

If the storage shed are installed in open and windy area outside,can use 6*60 mm expansion bolts to fixed 4 corners of the storage shed floor on the ground.

For assistance with assembly, request replacement parts or anything else we can help you, please contact us.

RETURN POLICY

1.For return and exchange orders:

(1)If the storage sheds you received is damaged or defective and need to be returned or replaced with new one, please kindly send us real images (product itself or packages).We will check and deal with it quickly.

(2)For product quality reason return and exchange orders: please take real images and contact us,we will provide prepaid return label for return or replace new product.

(3)For these reasons(bought by mistake,no longer needed, does not meet expectation, size smaller or bigger than expectation) return and exchange orders: customer need to cover the return shipping costs.

(4)Item damaged or defective ,please kindly send us images.We will fix it ASAP(FREE)or send you a repaired return label.

2.For cancel order: customer need call the UPS to ask return TWO PACKAGES to the shipper if the item has been shipped out, Otherwise, customers need to double pay the handling fee.

3.For change address: customer need to pay for extra shipping fee and carrier handle fee if the item has been shipped out.

4.For wrong address caused return: customers need to pay for extra shipping fees and carrier handle fees.

RETURN PROCESS

1. Make a RETURN REQUEST on website.
2. Please ensure the integrity of the items and write the detailed information about return address, and then return the item.
3. Please inform us the tracking number of the returned package if you returned the item, this information is necessary for us. Otherwise, we don't know when you returned the item to the warehouse and can not refund in time.
4. Warehouse will check the return item within 3 business days after receiving it, and we will complete the refund within 2 days if the item is confirmed to have no problems.

Please note:

If returned defective, damaged or incorrect item and affects the re-sales, we will refund part of the money. The refund depends on the integrity of the package.

WARRANTY

If there have product quality problem or the STORAGE SHED INSTRUCTION is not clear, please contact us, we will deal with it quickly.

Due to defects resulting from normal wear and tear (scuffing, scratches caused during use, fading, abuse, unreasonable use, transporting or reassemble the product), natural disasters (storm, hail, flood and fire) and by animal types are not covered by the product warranty)

Our company reserves the right to modify the contents of this manual without notification.