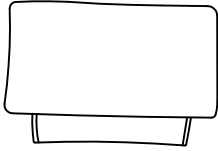
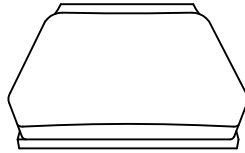

ASSEMBLY INSTRUCTION

CHAIR

A BACK FRAME

1pc

B SEAT FRAME

1pc

C LEFT PANEL

1pc

D RIGHT PANEL

1pc

E BACK CUSHION

1pcs

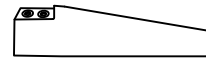
F WOODEN LEG

4pcs

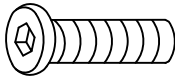
G BOLT
5/16 "x1-1/2"

8pcs

H ALLEN KEY
5/16 "

1pc

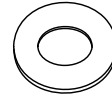
I FLAT WASHER
5/16 "

8pcs

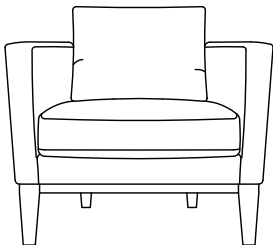

This page lists all the contents included in the box. As you unpack and prepare for assembly, place the contents on a carpeted or padded area to protect them from damage.

-
- 1** Please flip over the Seat frame(B). Align the legs(F) to the pre-drilled holes, insert the bolts(G), pad with a felt washer (I) then tighten with Allen key(H).

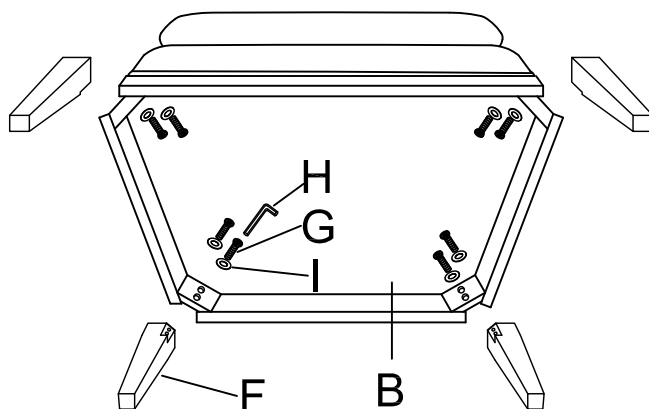

-
- 2** Hook on the Left Panel(C) & Right Panel(D) to the Seat Frame(B) properly.

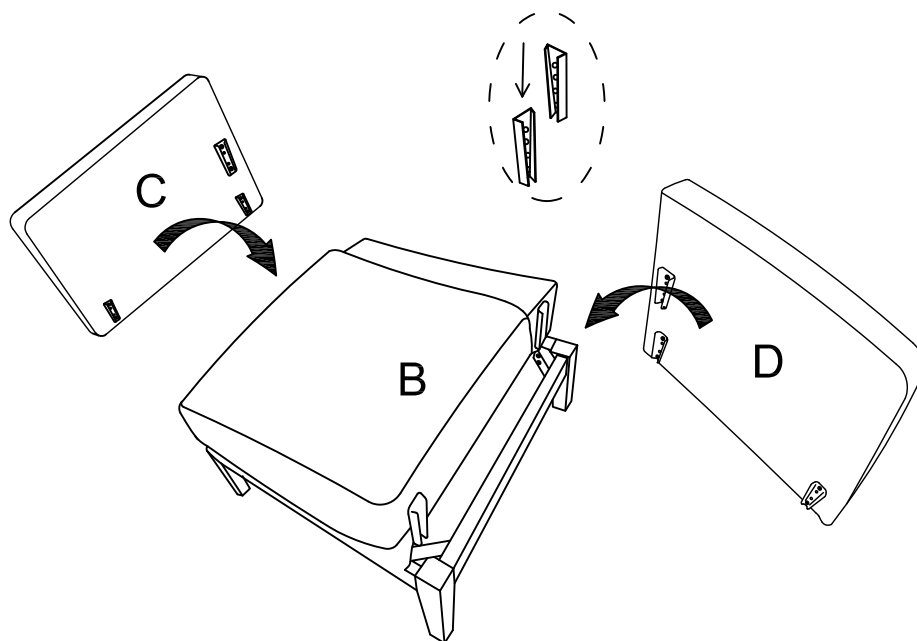

-
- 3** Hook on the Back Frame(A) to the Left Panel(C) & Right Panel(D) properly.

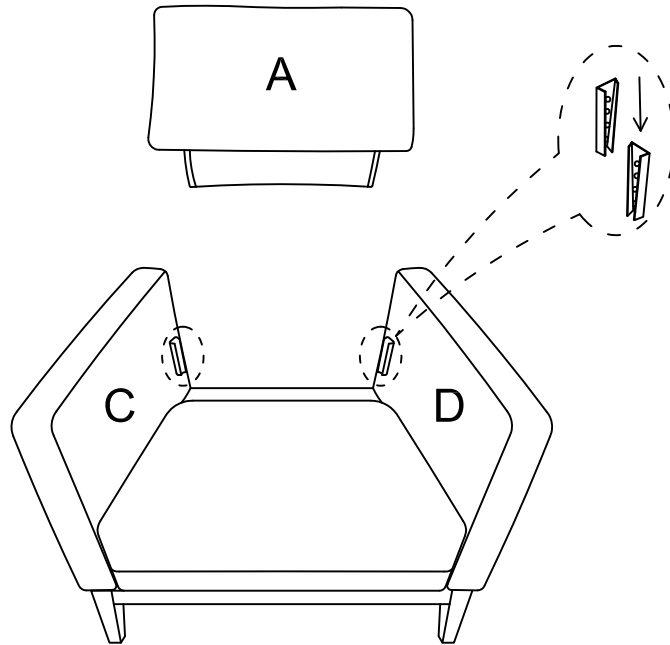

-
- 4** Put the Back Cushion(E) on Seat Frame(B), the assembly is completed.

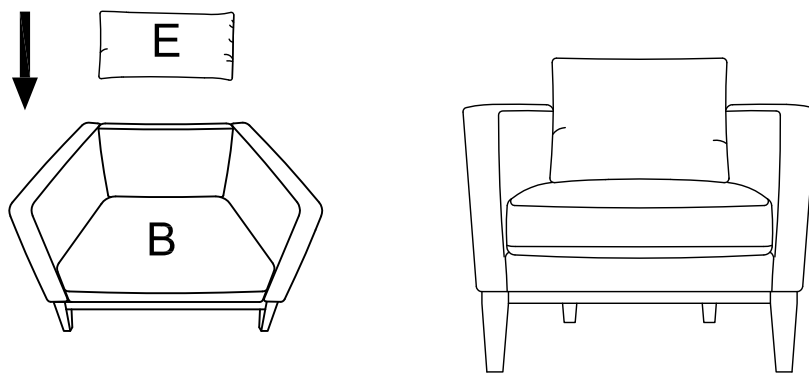

Cleaning & Care

Treat surface with care, Surface is reslstants to scratches but is not scratch reslstant, Clean surfaces with a dry or damp soft cloth. Do not use abraslvecleaners. Hardware may loosen over tlm. Periodlclally check that all connectlons are tlght.