



## Underscore® 6' Drop-In Bath with Bask™ Heated Surface K-1137-W1

### Features

- Bask™ heated surface creates spa-like relaxation with soothing warmth on your back and neck.
- Customize the heat with three adjustable settings.
- Generous 6-foot length provides spacious bathing for up to two people.
- Molded lumbar support offers extra comfort while bathing.
- Slotted overflow allows for deep soaking.
- Center drain.

### Material

- Acrylic

### Installation

- Drop-in or under-mount.



### Codes/Standards











CSA B45.5/IAPMO Z124  
ASTM E162  
ASTM E662  
UL 1795  
CSA C22.2 No. 218.2

### KOHLER® One-Year Limited Warranty

See website for detailed warranty information.

### Available Color/Finishes

*Color tiles intended for reference only.*

Color	Code	Description
	0	White
	96	Biscuit
	47	Almond
	NY	Dune
	95	Ice™ Grey
	G9	Sandbar
	33	Mexican Sand™
	K4	Cashmere
	58	Thunder™ Grey
	7	Black Black™

No change in measurements if connected with required drain illustrated. (K-7272)

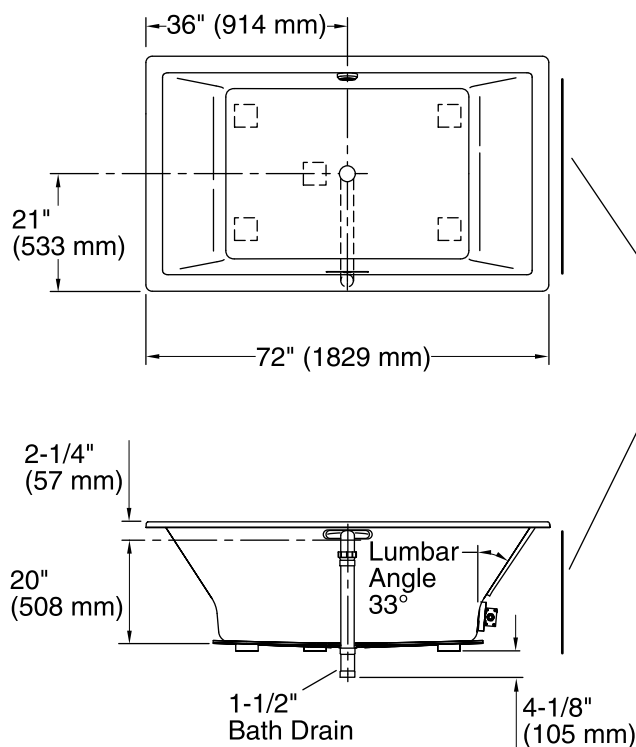

Access Panel  
20" (508 mm) L x  
15" (381 mm) H Min

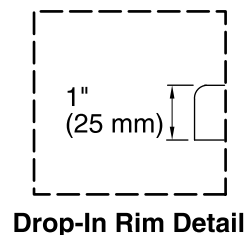

Drop-In Rim Detail

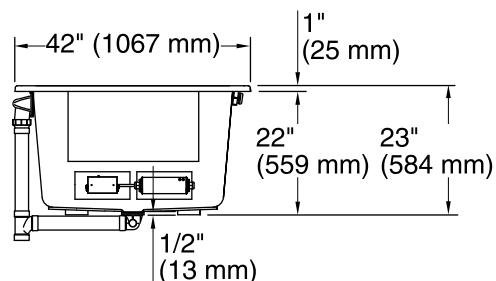

### Required Electrical Service

One circuit required, protected with Class A Ground-Fault Circuit-Interrupter (GFCI) or Residual Current Device (RCD).

Heated Surface: 120 V, 15 A, 60 Hz

### Technical Information

All product dimensions are nominal.

Installation:	Drop-in/Undermount
Drain location:	Center
Basin area, bottom:	45-3/4" x 32" (1162 mm x 813 mm)
Basin area, top:	66" x 36" (1676 mm x 914 mm)
Weight:	91 lbs (41.3 kg)
Minimum floor load:	60 lbs/ft² (292.9 kg/m²)
Water depth:	19" (483 mm)
Water capacity:	139 gal (526.2 L)
Cutout:	Drop-in, 70-1/2" x 40-1/2" (1791 mm x 1029 mm)
Under-mount kit:	592
Electrical rating:	Heated Surface: 120 V, 0.5 A, 60 Hz

### Notes

Install this product according to the installation guide.

Locate the bath within 24" (610 mm) of a GFCI-protected, 120 V, 15 A, grounded electrical outlet.

The hot water supply should be 70% of the capacity of the bath or greater. Installations will vary.