

# Assembly Instructions Office Chair with Tilt

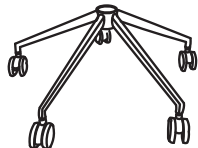

A (1 pc)



B (1 pc)

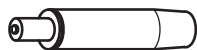

C (1 pc)

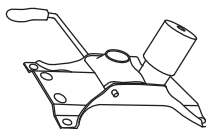

D (1 pc)



E (4 pcs)



F (4 pcs)



G (4 pcs)  
M6-1 x 20



H (1 pc)

PLEASE NOTE: Check that you have received all components and hardware before assembling. If you are missing any parts, contact your retailer, or email.

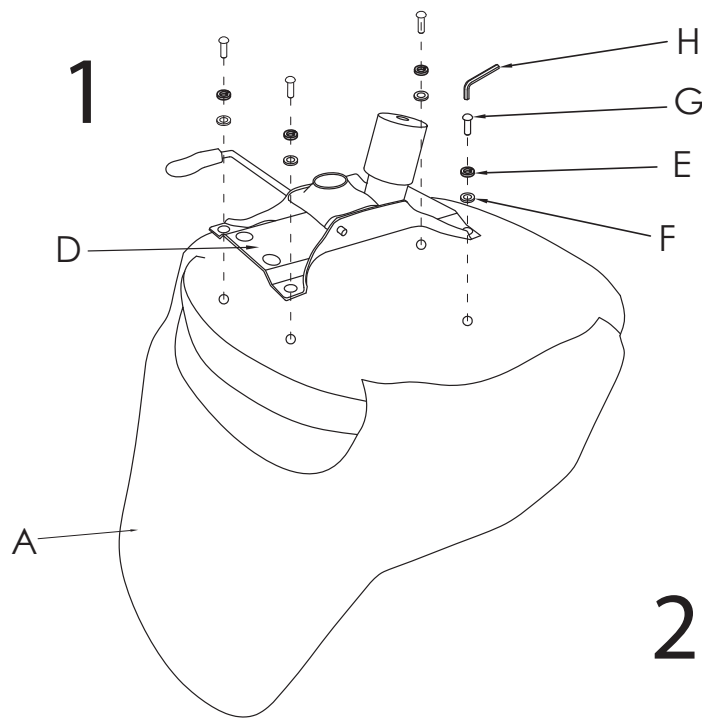

2

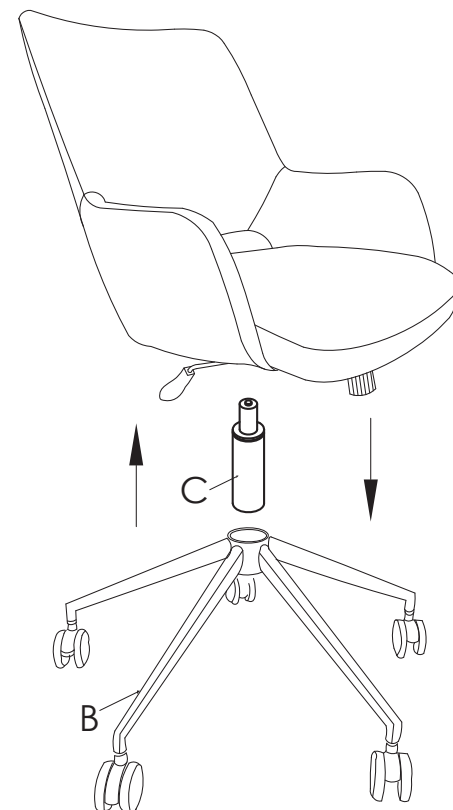

During assembly, hand tighten screws only. When the screws are in place, tighten completely.