

## COUNTER HEIGHT CHAIR

---

# ASSEMBLY INSTRUCTIONS



### ASSEMBLY TIPS :

1. Remove hardware from box and sort by size.
2. Please check to see that all hardware and parts are present prior to start of assembly.
3. Please follow attached instructions in the same sequence as numbered to ensure fast & easy assembly.



### Warning !

1. Don't attempt to repair or modify parts that are broken or defective. Please contact the store immediately.
2. This product is for home use only and not intended for commercial establishments.

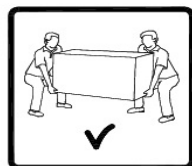

**ASSEMBLY TIME 5 MINUTES**

### PARTS IDENTIFICATION :

NO	DESCRIPTION	FIGURE	Q'TY
1	CHAIR BACK		1 PC
2	CUSHION SEAT WITH FRAME		1 PC
3L	LEFT SIDE STRETCHER		1 PC
3R	RIGHT SIDE STRETCHER		1 PC
4L	LEFT FRONT LEG		1 PC
4R	RIGHT FRONT LEG		1 PC
5	FRONT STRETCHER		1 PC

### HARDWARE IDENTIFICATION :

NO	DESCRIPTION	FIGURE	Q'TY
A	LONG BOLT	1/4"x75mm	4 PCS
B	MEDIUM BOLT	1/4"x60mm	4 PCS
C	SHORT BOLT	1/4"x38mm	1 PC
D	LOCK WASHER	5/16"x13mm	9 PCS
E	FLAT WASHER	5/16"x19mm	9 PCS
F	SCREW	Ø4x40mm	6 PCS
G	ALLEN WRENCH	M4x59mm	1 PC

**NOTE : QUANTITIES SHOWN ARE FOR ONE CHAIR**

### STEP 1

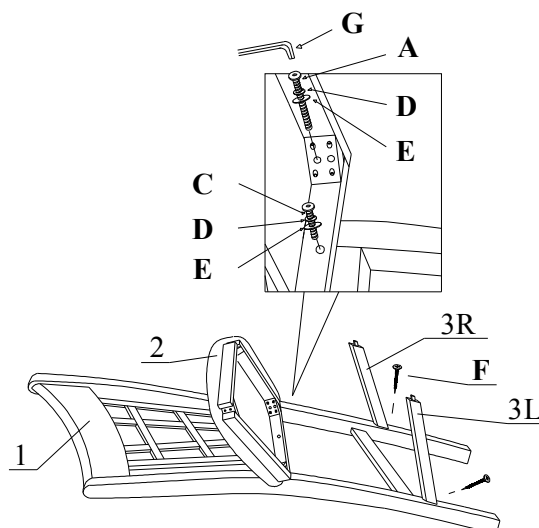

**STEP 2**

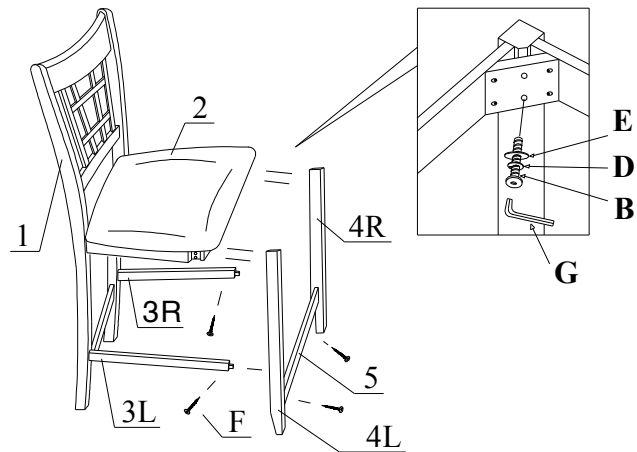

**STEP 3**

