

10 YEAR MANUFACTURER'S LIMITED WARRANTY

All parts of this Elements Of Design faucet are warranted to the original retail purchaser to be free from defects in material and workmanship for a period of ten(10) years from the date of purchase as shown on the purchaser's receipt. This warranty is limited to defective parts only, labor charges and/or damage resulting from improper installation, repair or replacements, as well as incidental and consequential damages connected therewith are excluded.

Any damage to this faucet as a result of misuse, abuse, neglect, accident for improper installation or any use not consistent with the instructions furnished by Elements of Design, will void this warranty. Replacement parts can be obtained from your local dealer.

CAUTION!!!

1. Water lines must be completely flushed before use, to avoid bris & clogs in your water system leading to mal-function and reduction of water flow.
2. Warranty to be void if water lines are not flushed before use of new faucet.
3. Use of abrasives of any strength may damage the finish of your faucet and void this warranty.

CODE APPROVAL: LA#M-000018



T 909.465.6687 F 909.548.6843 1877.FAUCET.1
www.eodfaucet.com
email: support@eodfaucet.com

INSTALLATION SHEET

Restoration DR Grab Bar Installation

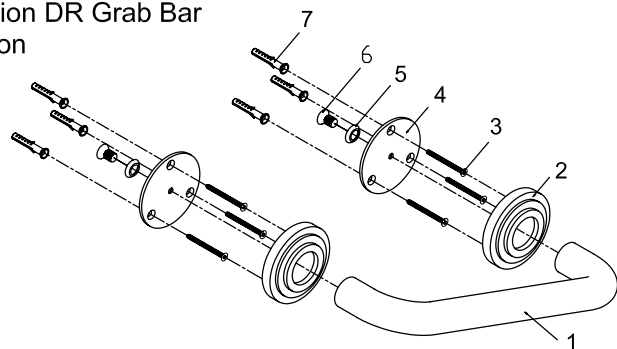

PART NAME	QUANTITY	PART NAME	QUANTITY
① Bar	1	⑤ Spacer	2
② Cover	2	⑥ Screw	2
③ Mounting Screw	6	⑦ Anchor	6
④ Mounting Plate	2		

Installation Steps:

- Step 1. Locate position on the wall and mark location of the holes for mounting screws .(Fig.1)
- Step 2. Drill holes at the marked locations.(Fig.2)
- Step 3. Insert anchors into the holes until flush with wall. (Fig.3)
- Step 4. Place the unit by tightening mounting screws with phillips screwdriver until the base is tightly fixed. (Fig.4)
- Step 5. Shift cover along the bar and place the cover over the mounting plate by pressing gently until the cover is tightly fixed. (Fig.5)

MODEL	FINISH	MODEL	FINISH
DR314121	Chrome	DR314125	Oil Rubbed Bronze
DR314122	Polished Brass	DR314128	Satin Nickel

TOOLS REQUIRED

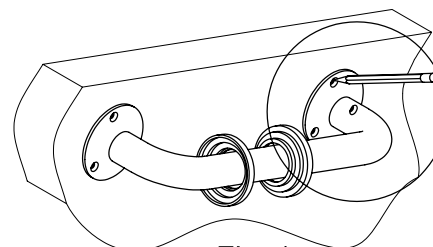
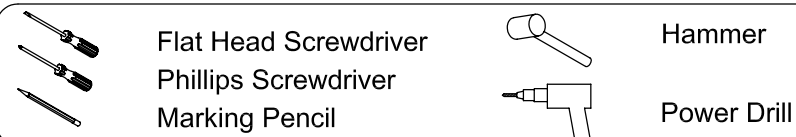

Fig. 1

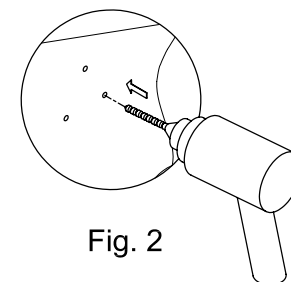

Fig. 2

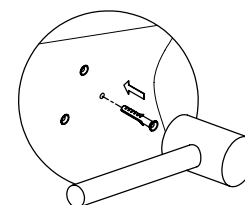

Fig. 3

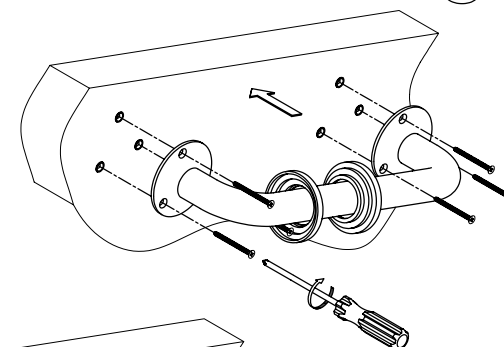

Fig. 4

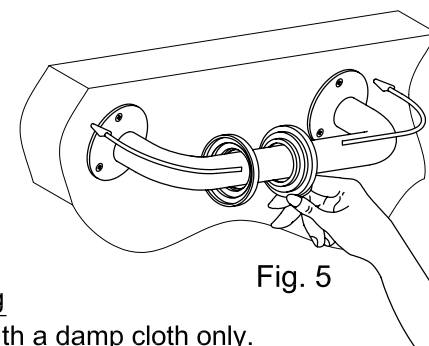

Fig. 5

Cleaning

Clean with a damp cloth only.
Avoid using metal or abrasive polishes.

www.kingstonbrass.com

TOLL-FREE CUSTOMER SERVICE: 877-2-KBRASS

TECHNICAL SUPPORT E-mail: service@kingstonbrass.com

6240 Prescott Court, Chino, CA91710