

**SPECIFICATIONS:****DESCRIPTION**

Cord-hung pendant with glass diffuser.

**LAMPING**

**Standard:** 60W Medium-based 120V, lamp not included. Dimmable with standard incandescent dimmer (not included).

**EDI:** 40W Edison Filament Medium-based, 120V, lamp included.

**LED Filament:** 5W Replaceable LED Filament lamp, 120V, dimmable, 80+ CRI, 2200°K CCT, 450 lumens, 15,000 hours, lamp included.

**DIFFUSER**

Shade shall be of glass in various decors.

7.875" Dia. x 6.5" H

11.75" Dia. x 9.75" H

**SUSPENSION**

**Cord-hung:** 10' SVT-type cord, complete with 5" decorative sleeve at the socketholder. Jacket coordinates with metal finish. Plated stamped steel construction. Bronze or Satin Nickel. See next page for mulit light options.

**MOUNTING**

Installs directly to a 4" octagonal ceiling box. Suitable for sloped ceilings.

**LABELS**

UL or ETL Listed. Suitable for Damp Locations (interior use only).

Consult factory concerning lower wattage labeling for energy requirements.



AMBER/CLEAR & SMOKE/CLEAR

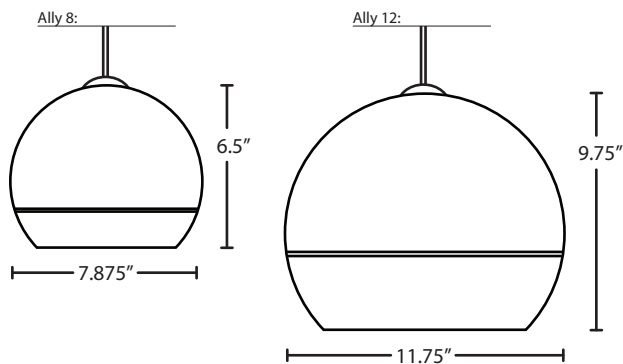

BLUE/CLEAR

**Project Information:**

**For ordering information, see next page**

All dimensions provided are nominal.  
Allowance must be made for dimensional tolerance in handcrafted glasses.

## ORDERING:

CONNECTION	SHADE OPTIONS	LAMP OPTIONS	METAL FINISH
Pendant Fixtures	7.875" Amber/Clear	60W A19 Incan	Bronze
Dome Canopy	7.875" Blue/Clear	40W Edison	Satin Nickel
Flat Canopy	7.875" Smoke/Clear	5W LED Filament	
	11.75" Amber/Clear		
	11.75" Blue/Clear		
	11.75" Smoke/Clear		

Multi light  
For Multi light  
Canopy



Multi light available  
See options to right

**Ex.** Pendant, Amber Shade,  
Satin Nickel Finish

## MULTIPOINT CANOPY OPTIONS:

## 3 LIGHT ROUND CANOPY

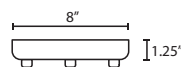

- Suitable for sloped ceilings
- Bronze or Satin Nickel
- 10" Dia. shades MAX, with staggered heights

## 3 LIGHT LARGE ROUND CANOPY

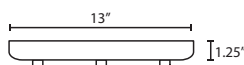

- Suitable for sloped ceilings
- Bronze or Satin Nickel
- 16" Dia. shades MAX, with staggered heights

## 6 LIGHT ROUND CANOPY

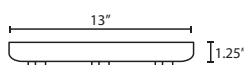

- Suitable for sloped ceilings
- Bronze or Satin Nickel
- 10" Dia. shades MAX, with staggered heights

## 9 LIGHT ROUND CANOPY

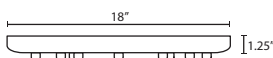

- Suitable for sloped ceilings
- Bronze or Satin Nickel
- 10" Dia. shades MAX, with staggered heights

## 3 LIGHT BAR CANOPY

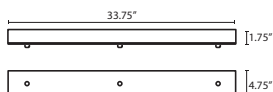

- Suitable for sloped ceilings
- Bronze or Satin Nickel
- 20" Dia. shades MAX, with staggered heights

## 4 LIGHT BAR CANOPY

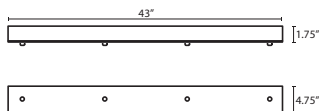

- Suitable for sloped ceilings
- Bronze or Satin Nickel
- 20" Dia. shades MAX, with staggered heights

## 7 LIGHT BAR CANOPY

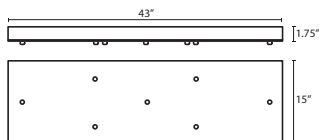

- Suitable for sloped ceilings
- Bronze or Satin Nickel
- 14" Dia. shades MAX, with staggered heights

## PENDANT OPTIONS:

## MONOPOINT PENDANT CANOPY

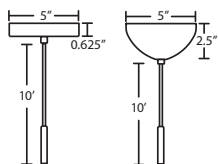

- Flat or Dome Canopy styles. Dome style allows adjustment without cutting cord.
- "J" option is pendant less canopy for multipoint canopy (options to the right)
- Suitable for sloped ceilings
- Cord: 10' SVT, 5" sleeve at socketholder (V Series utilizes SJT-type)
- Bronze or Satin Nickel

## ACCESSORIES:

## ADDITIONAL STEM SECTIONS:

Additional connecting stems are available to increase overall length, up to 10' max. Telescoping adjustable section allows up to 3" movement.

Adj. Section  
3" Section  
6" Section  
12" Section  
18" Section

## LONGER CORD LENGTHS:

Longer cord length of 15' available.

## LOW WATTAGE LABELING:

Incandescent fixture supplied with 16 watt relamp label.

## CORD SLEEVES:

If concealing the cord is desired, order our 0.25" dia. metal sleeves. Each sleeve is 18" long and may be field cut.

Satin Nickel  
Bronze

## STEMHOOKS:

Suspension hooks allow cord drops to be placed wherever desired. Suitable for sloped ceilings.

Bronze  
Satin Nickel

## HOW TO ORDER A MULTILIGHT FIXTURE

Order your canopy with the selected 120V multi light pendants (indicated by "B" or "J" prefix) for the complete fixture:

**Example:** 3 Light Large Round Canopy  
8 Pendant in Smoke/Clear  
8 Pendant in Blue/Clear  
12 Pendant in Amber/Clear