

Fluorescent Pendant Fixture

120VAC / 60Hz

Safety Precautions

Read all safety precautions and installation instructions carefully before installing or servicing this fixture. Failure to comply with these instructions could result in potentially fatal electric shock and/or property damage.

It is recommended that all wiring be performed by a qualified electrician. This fixture must be wired in accordance with all national and local electrical codes.

Do not handle any energized fixture or attempt to energize any fixture with wet hands or while standing on a wet or damp surface or in water.

This fixture is designed for use in a 110-120VAC, 60Hz fused circuit. Do not use on a dimming circuit.

To reduce the risk of electrical shock, and to assure proper operation, this fixture must be adequately grounded. Make sure to connect the canopy (5) ground wire to the incoming earth ground from your main power supply panel.

This fixture is intended to be used for general indoor lighting in damp locations.

Assembly Instructions

1. Preparing for installation.

- A. **Disconnect electrical power** before installing or servicing any part of this fixture.
- B. Insert one set of #8-32 x 1" screws (2) through the top of gem bar (3) with the threaded portions facing down to line up with the mounting holes in the canopy (5).
- C. Attach gem bar (3) to junction box (not provided) in position shown with #8-32 x 1-1/2 screws (1) provided. **Note:** Allow access into junction box to complete wiring.

2. Wiring

All wiring must take place inside junction box. Caution: Make sure power is off at fuse or circuit breaker box. Check power wires for damage or scrapes. **Note:** Most dwellings built before 1985 have supply wire rated to 60C. Consult a qualified electrician before installing.

- A. Feed cord (9) through strain relief (8) and center hole in canopy (5).
- B. Connect the green ground pig-tail wire attached to the canopy and the fixture green wire (or clear wire with green streak) to the supply ground wire and secure with a wire nut (provided).
- C. To modify cord (9) length, unscrew strain relief cover (8) from canopy (5). Pull cord (9) through canopy to desired length and make a knot to prevent from slipping from the strain relief (7) (8). Secure cord by re-attaching strain relief cover (8).
- D. Once desired mounting length is determined, cut cord allowing for 6 inches of wire for junction box wiring. Carefully remove outer insulation from cord without damaging lead wires. Strip lead wires back 3/8 inch for wire nut connections. **WARNING:** Inspect modified cord and wires for any damaged insulation.
- E. Using wire connectors provided, connect white (Common/Neutral) supply wire to white (or clear wire with white streak) fixture wire. Connect black (Hot/Incoming) supply wire to the other black (or clear with black or grey streak) fixture wire. Pull on each wire lead to make sure connections are secure. Make certain no bare wires are exposed outside of wire connectors.

3. Mounting

- A. Tighten gem bar mounting screws (2).
- B. Align canopy (5) over mounting studs (2) and fasten with thumbnuts (6).
- C. Tighten strain relief (8) securely against cord (9).

4. Lamping/Re-lamping

Install appropriate 26 watt (max) 4-pin fluorescent quad lamp G24q or triple tube lamp GX24q (11). To relamp insert lamp (11) into barrel ballast (10) until lamp snaps in place.

5. Restore power at fuse or circuit box.

Fluorescent Pendant Fixture

120VAC / 60Hz

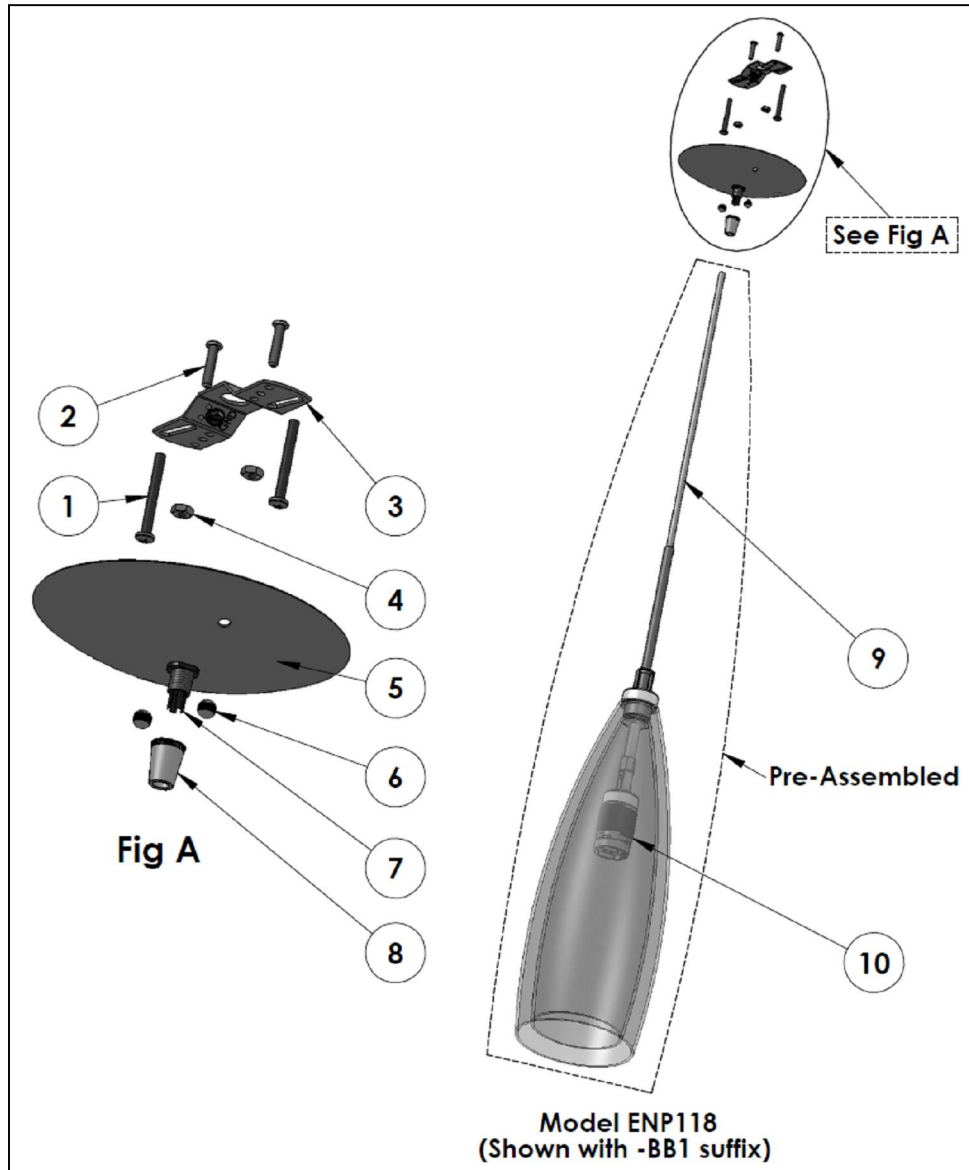

ALTERNATE MODELS:

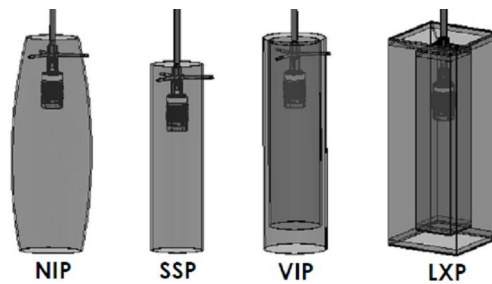

Limited Factory Warranty

warranty that this fixture is free from defects in materials and workmanship when installed and used under normal operating conditions for a period of 2 years from date of purchase. This warranty covers all component parts and extends only to replacement of defective fixture or components; it does not cover failure due to improper installation, misuse, mishandling or damage incurred in transit.